

Mooreville

WRD Exp. (GW)  
April 1966

Well No. J 18

### WELL SCHEDULE

U. S. DEPT. OF THE INTERIOR      GEOLOGICAL SURVEY      WATER RESOURCES DIVISION

#### MASTER CARD

Record by THOMSON Source of data BOWC Date 3/13/67 Map \_\_\_\_\_

State 28 County (or town) LEE 41

Latitude: 34 15 2 / N Longitude: 08 03 42 / 1  
deg min sec N S 12 degrees 15 min sec 18

Lat-long accuracy: 3 T. 9 R. 7 Sec 33 NE NE SW

Local well number: J018AC3309507E Other number: 158

Local use: \_\_\_\_\_ Owner or name: \_\_\_\_\_

Owner or name: C. CARNATHAM Address: \_\_\_\_\_

Ownership: County, Fed Gov't, City, Corp or Co, Private, State Agency, Water Dist P

Use of water: (A) Air cond, (B) Bottling, (C) Comm, (D) Dewater, (E) Power, (F) Fire, (G) Dom, (H) Irr, (I) Med, (J) Ind, (K) P S, (L) Rec, (M) Stock, (N) Instat, (O) Unused, (P) Repressure, (Q) Recharge, (R) Desal-P S, (S) Desal-other, (T) Other H

Use of well: (A) Anode, (B) Drain, (C) Seismic, (D) Heat Res, (E) Obs, (F) Oil-gas, (G) Recharge, (H) Test, (I) Unused, (J) Withdraw, (K) Waste, (L) Destroyed W

DATA AVAILABLE: Well data  Freq. W/L meas.:  Field aquifer char.

Hyd. lab. data: \_\_\_\_\_

Qual. water data; type: \_\_\_\_\_

Freq. sampling: \_\_\_\_\_ Pumpage inventory:  no period: \_\_\_\_\_

Aperture cards: \_\_\_\_\_

Log data: \_\_\_\_\_

#### WELL-DESCRIPTION CARD

SAME AS ON MASTER CARD Depth well: 308 ft Meas. accuracy 3

Depth cased: (first perf.) 36 ft Casing type: \_\_\_\_\_; Diam. 4 in

Finish: (C) porous concrete, (F) gravel w. (screen), (G) gravel w. (gallery), (H) horiz. gallery, (I) open end, (J) perf., (K) screen, (L) sd. pt., (M) shored, (N) open hole, (O) other X

Method Drilled: (A) air rot., (B) bored, (C) cable, (D) dug, (E) hyd jetted, (F) air rot., (G) percussion, (H) rotary, (I) reverse, (J) trenching, (K) driven, (L) drive wash, (M) other H

Date Drilled: 961 Pump intake setting: \_\_\_\_\_ ft

Driller: EWING address \_\_\_\_\_

Lift (type): (A) air, (B) bucket, (C) cent, (D) jet, (E) multiple, (F) multiple, (G) none, (H) piston, (I) rot, (J) submerg, (K) turb, (L) other  Deep  Shallow 40

Power (type): (A) diesel, (B) elec, (C) gas, (D) gasoline, (E) hand, (F) gas, (G) wind, (H) H.P.  Trans. or meter no. \_\_\_\_\_

Descrip. MP \_\_\_\_\_ ft above below LSD. Alt. MP \_\_\_\_\_

Alt. LSD: 400 Accuracy: (source) 5

Water Level: 117 ft above below MP; Ft below LSD 117 Accuracy: \_\_\_\_\_

Date meas: 4/5/61 Yield: 461 gpm Method determined \_\_\_\_\_

Drawdown: \_\_\_\_\_ ft Accuracy: \_\_\_\_\_ Pumping period: \_\_\_\_\_ hrs

QUALITY OF WATER DATA: Iron \_\_\_\_\_ ppm Sulfate \_\_\_\_\_ ppm Chloride \_\_\_\_\_ ppm Hard. \_\_\_\_\_ ppm

Sp. Conduct \_\_\_\_\_ K x 10<sup>6</sup> Temp. \_\_\_\_\_ °F Date sampled \_\_\_\_\_

Taste, color, etc. \_\_\_\_\_

TRANSMITTED FOR ADP

Well No.

J 18

Well No. J 18

Latitude-longitude \_\_\_\_\_  
d m s d m s

HYDROGEOLOGIC CARD

**SAME AS ON MASTER CARD** **Physiographic Province:** 03 **Section:** \_\_\_\_\_

**Drainage Basin:** D **Subbasin:** 13C

**Topo of well site:** (D) depression, stream channel, dunes, flat, hilltop, sink, swamp, (K) (L) offshore, pediment, hillside, terrace, undulating, valley flat S

**MAJOR AQUIFER:** system \_\_\_\_\_ series K3 aquifer, formation, group E2

**Lithology:** \_\_\_\_\_ **Origin:** 6 **Aquifer Thickness:** \_\_\_\_\_ ft

**Length of well open to:** \_\_\_\_\_ ft **Depth to top of:** \_\_\_\_\_ ft

**MINOR AQUIFER:** system \_\_\_\_\_ series \_\_\_\_\_ aquifer, formation, group \_\_\_\_\_

**Lithology:** \_\_\_\_\_ **Origin:** \_\_\_\_\_ **Aquifer Thickness:** \_\_\_\_\_ ft

**Length of well open to:** \_\_\_\_\_ ft **Depth to top of:** \_\_\_\_\_ ft

**Interval Screened:** \_\_\_\_\_

**Depth to consolidated rock:** \_\_\_\_\_ ft **Source of data:** \_\_\_\_\_

**Depth to basement:** \_\_\_\_\_ ft **Source of data:** \_\_\_\_\_

**Surficial material:** \_\_\_\_\_ **Infiltration characteristics:** \_\_\_\_\_

**Coefficient Trans:** \_\_\_\_\_ gpd/ft **Coefficient Storage:** \_\_\_\_\_

**Coefficient Perm:** \_\_\_\_\_ gpd/ft<sup>2</sup>; **Spec cap:** \_\_\_\_\_ gpd/ft; **Number of geologic cards:** \_\_\_\_\_

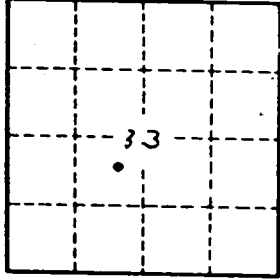

*White house - big porch*

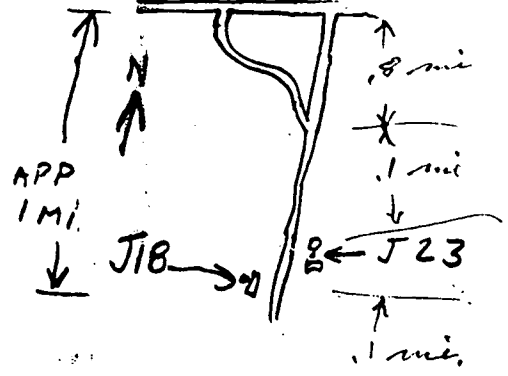

Well No. J 18

LEE  
J18

Date: April 5, 1961, Driller: Ewing D. Loo County Lee  
*(Name of 1967 owner)*

Claude Carnathan

(1) Owner of Land:	Description & Color of Materials Sand, Clay, Red Clay, Shell, etc.	Thick- ness Feet	Depth Feet
<u>Mr. W. P. Ester</u> (Name)			
<u>Moreville, Miss.</u> (Address)			
(2) Location: $\frac{1}{4}$ , $\frac{1}{4}$ , Sec. <u>33</u> T <u>9</u> R <u>7</u> <sup>S</sup> <u>White house</u> <u>big porch</u> <u>US 78</u>			
<u>8 mi</u>			
(3) Topography: <u>household</u> (Hilly) (Flat) (Level)			
(4) Purpose of Well: <u>household</u> (Domestic Irrigation Municipal, Industrial, Other)			

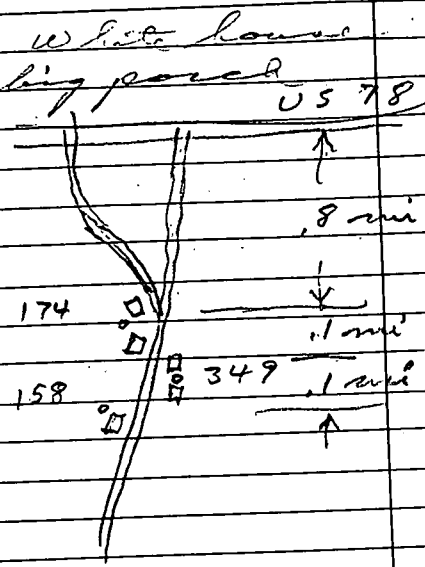

Information upon completion of well:

- (1) Diameter 4 inches.
- (2) Total Depth 308 feet.
- (3) Water Level 117 feet below top of ground.
- (4) Cased to 35'6", Size \_\_\_\_\_, Length \_\_\_\_\_.
- (5) Screen: Size \_\_\_\_\_, Length \_\_\_\_\_.
- (6) Were any formations sealed against pollution?  
 yes, \_\_\_\_\_ no.

If YES depth of formation 35'6"

Why \_\_\_\_\_

Drillers Remarks: Copied

158 ✓ ELEU 400

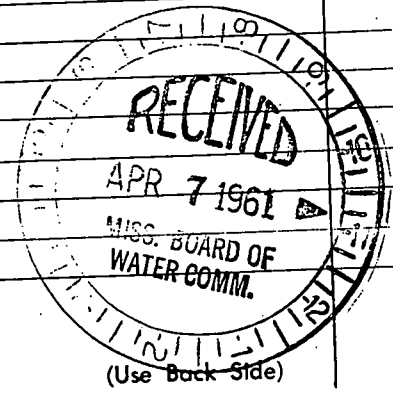

Well No.

Mail this copy to Board of Water Commissioners 429 Miss. St. Jackson, Miss.

