

9-185
(October 1950)

UNITED STATES
DEPARTMENT OF THE INTERIOR
GEOLOGICAL SURVEY
WATER RESOURCES DIVISION

Log#14

WELL SCHEDULE

Date 4200 / 3-14, 1961 Field No. 4122
Record by P. E. Grantham Office No. 158
Source of data Dr. + Observation

1: Location: State Miss County Lee
Map _____

Ctr. NW 1/4 NW 1/4 sec. 24 T 9 N R 6 

2. Owner: Weaver H. Smith Address E. Tupelo
Tenant _____ Address _____
Driller Ewing Gas Co. Address Tupelo

3. Topography Side of Ridge

4. Elevation 390± ft. above MSL TOPO
below

5. Type: Dug, drilled, driven, bored, jetted 3-14-61

6. Depth: Rept. 368 ft. Meas. _____ ft.

7. Casing: Diam. 4" 38' in., to _____ in., Type _____
Depth _____ ft., Finish 100± Ft. of 2" pump pipe

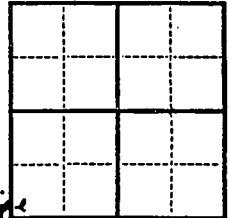

8. Chief Aquifer _____ From _____ ft. to _____ ft.
Others _____

9. Water level _____ ft. rept. _____ 19 _____ above
meas. _____ below
_____ which is _____ ft. above
_____ below surface

10. Pump: Type Rod (cycl.) Capacity _____ G. M.
Power: Kind electricity Horsepower _____

11. Yield: Flow _____ G. M., Pump _____ G. M., Meas., Rept. Est. _____
Drawdown _____ ft. after _____ hours pumping _____ G. M.

12. Use: Dom, Stock, PS., RR., Ind., Irr., Obs. _____
Adequacy, permanence _____

13. Quality _____ Temp _____ °F.
Taste, odor, color _____ Sample Yes
No
Unfit for _____

14. Remarks: (Log, Analyses, etc.) Unused 1975
logs will not pass 20' - concd?

UNITED STATES
DEPARTMENT OF THE INTERIOR
BUREAU OF LAND MANAGEMENT
FOURTH DISTRICT

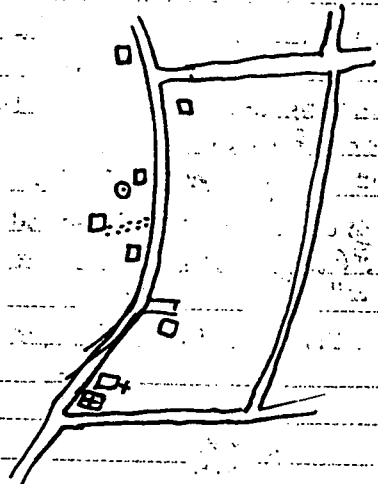

UNITED STATES DEPARTMENT OF THE INTERIOR
BUREAU OF LAND MANAGEMENT
FOURTH DISTRICT
OFFICE OF THE DISTRICT MANAGER
DENVER, COLORADO

TO: [Illegible]

FROM: [Illegible]

SUBJECT: [Illegible]

[Illegible text follows, including what appears to be a date and a signature line.]

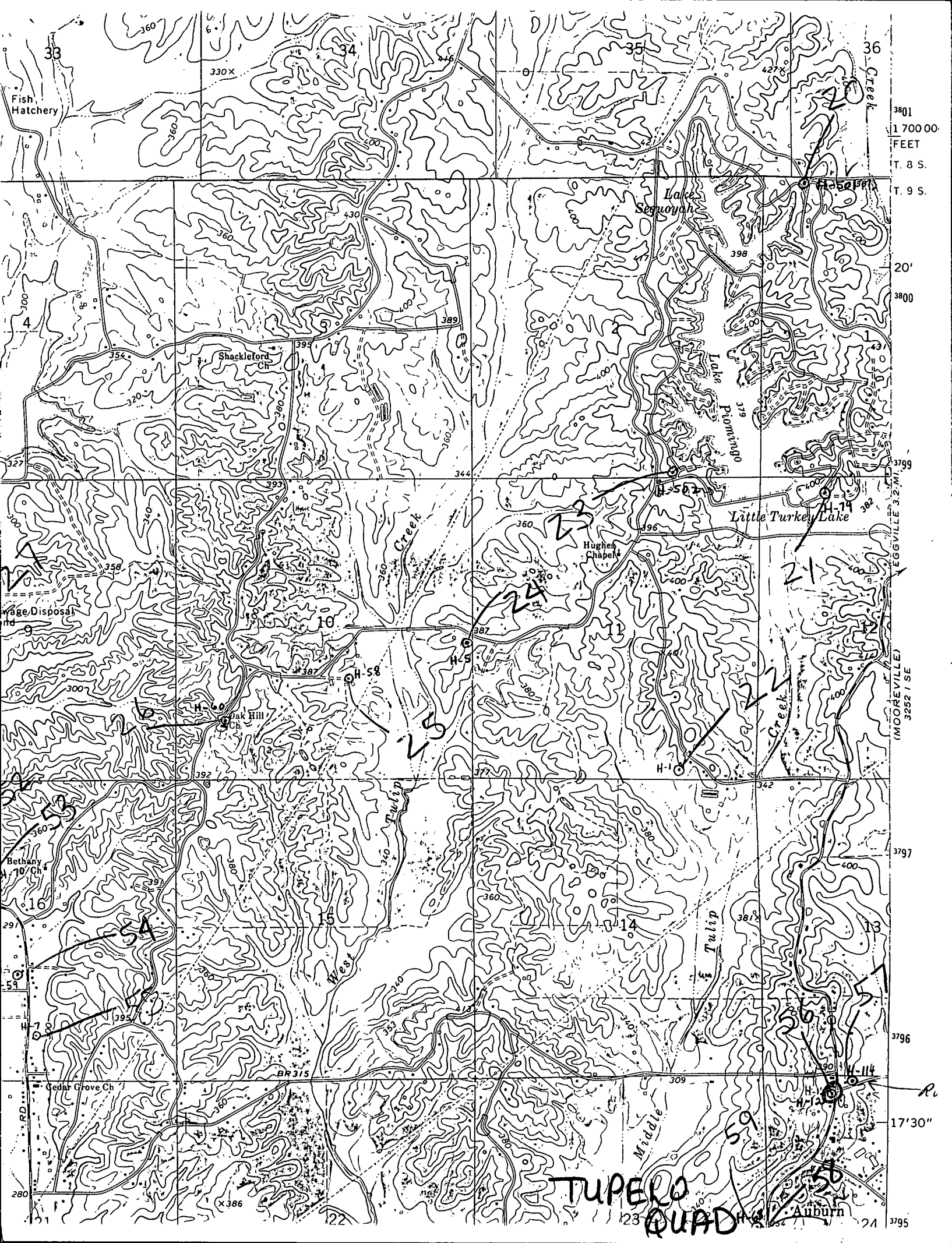

Fish Hatchery

Shackleford Ch.

Lake Sequoyah

Lake Plominigo

Little Turkey Lake

Hughes Chapel

Park Hill Ch.

Bethany 10 Ch.

Cedar Grove Ch.

1:70000
FEET
T. 8 S.
T. 9 S.

3252 / SE
(MOOREVILLE)

TUPERO
QUAD

21

28

22

24

25

26

27

28

29

30

31

32

33

34

35

36

37

38

39

40

41

42

43

44

45

46

47

48

49

50

51

52

53

54

55

56

57

58

59

60

61

62

63

64

65

66

67

68

69

70

71

72

73

74

75

76

77

78

79

80

81

82

83

84

85

86

87

88

89

90

91

92

93

94

95

96

97

98

99

100

R. 17° 30'

3795