

WELL SCHEDULE

U. S. DEPT. OF THE INTERIOR

GEOLOGICAL SURVEY

WATER RESOURCES DIVISION

TRANSMITTED FOR ADP

MASTER CARD

Record by Thomson Source of data Bowc Date 3/28/67 Map \_\_\_\_\_

State 2 E County (or town) LEE 4 1

Latitude: 3 4 1 9 0 5 N Longitude: 0 8 8 4 1 0 2 Sequential number: 1

Lat-long accuracy: 3 T. 9 R. 6 Sec 9, NW  $\frac{1}{4}$ , SW  $\frac{1}{4}$ , NW  $\frac{1}{4}$

Local well number: H 0 6 4 C B 0 9 0 9 S O G E Other number: 88

Local use: \_\_\_\_\_ Owner or name: CHARLES MEARS Address: \_\_\_\_\_

Ownership: County (C), Fed Gov't (F), City, Corp or Co (M), Private (N), State Agency (P), Water Dist (W) P

Use of water: (A) Air cond, (B) Bottling, (C) Comm, (D) Dewater, (E) Power, (F) Fire, (G) Dom, (H) Irr, (I) Med, (J) Ind, (K) P S, (L) Rec, (M) Stock, (N) Instat, (O) Unused, (P) Reppure, (Q) Recharge, (R) Desal-P S, (S) Desal-other, (T) Other H

Use of well: (A) Anode, (B) Drain, (C) Seismic, (D) Heat Res, (E) Obs, (F) Oil-gas, (G) Recharge, (H) Test, (I) Unused, (J) Withdraw, (K) Waste, (L) Destroyed W

DATA AVAILABLE: Well data I Freq. W/L meas.: \_\_\_\_\_ Field aquifer char. \_\_\_\_\_

Hyd. lab. data: \_\_\_\_\_

Qual. water data; type: PARTIAL USGS

Freq. sampling: \_\_\_\_\_ Pumpage inventory: no period: \_\_\_\_\_

Aperture cards: \_\_\_\_\_

Log data: DRILLERS LOG

WELL-DESCRIPTION CARD

SAME AS ON MASTER CARD Depth well: 350 Meas. 3

Depth cased: 42 Casing type: \_\_\_\_\_; Diam. 4

Finish: porous concrete, gravel w. (perf.), gravel w. (screen), horiz. gallery, open end, other X

Method: (A) air, (B) bored, (C) cable, (D) dug, (E) hyd jetted, (F) air rot., (G) percussion, (H) rotary, (I) reverse, (J) trenching, (K) driven, (L) drive wash, (M) other H

Date Drilled: 9-6-62 Pump intake setting: \_\_\_\_\_

Driller: WEBB

Lift (type): (A) air, (B) bucket, (C) cent, (D) jet, (E) multiple, (F) multiple, (G) none, (H) piston, (I) rot, (J) submerg, (K) turb, (L) other Deep

Power (type): (A) diesel, (B) elec, (C) gas, (D) gasoline, (E) hand, (F) gas, (G) wind; H.P. \_\_\_\_\_ Trans. or meter no. \_\_\_\_\_

Descrip. MP \_\_\_\_\_ above \_\_\_\_\_ below LSD. Alt. MP \_\_\_\_\_

Alt. LSD: 306 Accuracy: (source) 5

Water Level: \_\_\_\_\_ above \_\_\_\_\_ below MP; Ft below LSD 87 Accuracy: \_\_\_\_\_

Date meas: 9-26-62 Yield: \_\_\_\_\_ Method determined \_\_\_\_\_

Drawdown: \_\_\_\_\_ Accuracy: \_\_\_\_\_ Pumping period \_\_\_\_\_

QUALITY OF WATER DATA: Iron \_\_\_\_\_ Sulfate \_\_\_\_\_ Chloride \_\_\_\_\_ Hard. \_\_\_\_\_

Sp. Conduct 250 K x 10<sup>6</sup> 2 Temp. \_\_\_\_\_ Date sampled 3-2-67 367

Taste, color, etc. \_\_\_\_\_

Well No. H 64

Well No. H 64

Latitude-longitude N  
S  
d m s d m s

HYDROGEOLOGIC CARD

SAME AS ON MASTER CARD Physiographic Province: 03 Section: \_\_\_\_\_  
19 D Drainage Basin: 13C Subbasin: \_\_\_\_\_ 20 21 22 23 25 26

Topo of well site: (D) depression, stream channel, dunes, flat, hilltop, sink, swamp, (E) (F) (H) (K) (L) (O) (P) (S) (T) (U) (V) offshore, pediment, hillside, terrace, undulating, valley flat \_\_\_\_\_ 27 S

MAJOR AQUIFER: \_\_\_\_\_ system \_\_\_\_\_ series K3 TOMBIGBEE aquifer, formation, group \_\_\_\_\_ TM 28 29 30 31

Lithology: \_\_\_\_\_ M3 Origin: G Aquifer Thickness: \_\_\_\_\_ ft 32 33 34

Length of well open to: \_\_\_\_\_ ft 100 Depth to top of: \_\_\_\_\_ ft 250 35 37 38 40 41 43

MINOR AQUIFER: \_\_\_\_\_ system \_\_\_\_\_ series \_\_\_\_\_ aquifer, formation, group \_\_\_\_\_ 44 45 46 47

Lithology: \_\_\_\_\_ Origin: \_\_\_\_\_ Aquifer Thickness: \_\_\_\_\_ ft 48 49 50

Length of well open to: \_\_\_\_\_ ft \_\_\_\_\_ Depth to top of: \_\_\_\_\_ ft \_\_\_\_\_ 51 53 54 56 57 59

Intervals Screened: \_\_\_\_\_

Depth to consolidated rock: \_\_\_\_\_ ft \_\_\_\_\_ Source of data: \_\_\_\_\_ 60 63 64

Depth to basement: \_\_\_\_\_ ft \_\_\_\_\_ Source of data: \_\_\_\_\_ 65 68 69

Surficial material: \_\_\_\_\_ Infiltration characteristics: \_\_\_\_\_ 70 71 72

Coefficient Trans: \_\_\_\_\_ gpd/ft \_\_\_\_\_ Coefficient Storage: \_\_\_\_\_ 73 75 76 78

Coefficient Perm: \_\_\_\_\_ gpd/ft<sup>2</sup>; Spec cap: \_\_\_\_\_ gpm/ft; Number of geologic cards: \_\_\_\_\_ 77 79

WL 82  
WL 87  
3/2/67  
10-4-67

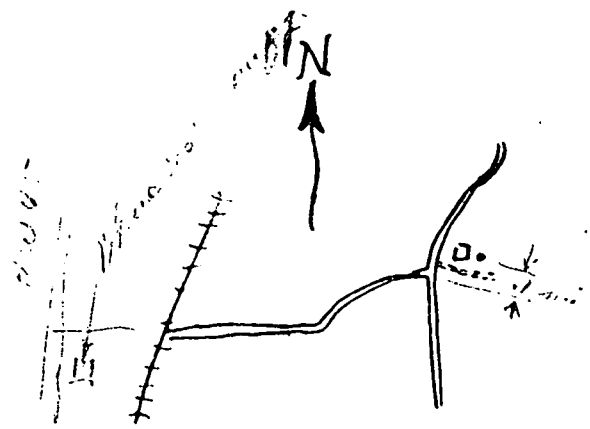
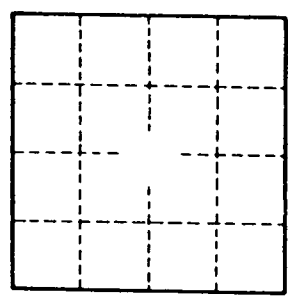

Well No. H 64

H E 64

9-26-62

WATER WELL DRILLERS LOG

Date: 9-26, 1962, Driller: Johnny Webb County Lee

(1) Owner of Land: Charles mess (Name)	Description & Color of Materials Sand, Clay, Red Clay, Shell, etc.	Thick- ness Feet	Depth Feet
Supelo mess (Address)	Soil to 14 ft sand to 35 ft blue marl		
(2) Location: NW 1/4, W 1/4, Sec. 9 T 1 R 6 E 5 miles north of Supelo (distance) (direction) (Nearest Town)	to 250 ft water rock 4" sand to 350 ft		
(3) Topography: <input checked="" type="checkbox"/> (Hilly) <input type="checkbox"/> (Flat) <input type="checkbox"/> (Level)			
(4) Purpose of Well: (Domestic Irrigation Municipal, Industrial, Other)			
Information upon completion of well:			
(1) Diameter 4 inches.			
(2) Total Depth 350 feet.			
(3) Water Level 87 feet below top of ground.			
(4) Cased to 4 2/4" Size 4"			
(5) Screen: Size _____, Length _____			
(6) Were any formations sealed against pollution? _____ yes, _____ no.			
If YES depth of formation _____			
Why _____			
Drillers Remarks: _____			
_____			
_____			
S.P. ELEM 306			

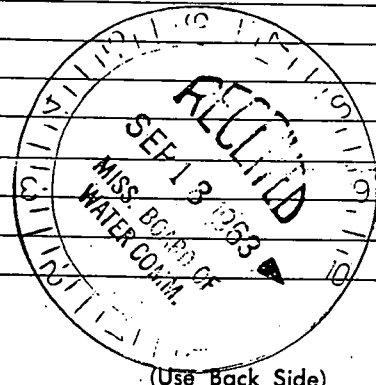

Mail this copy to Board of Water Commissioners 429 Miss. St. Jackson, Miss

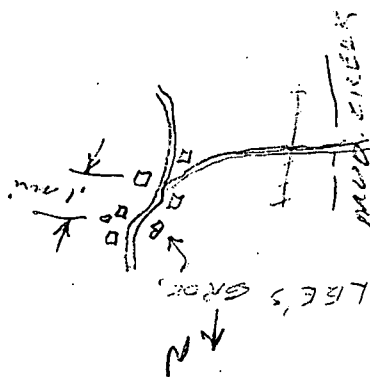

# TUPELO QUAD

