

GW6824
0410015-05

WPD Exp. (G?)
April 1966

Well No. H 40

Tupelo

WELL SCHEDULE

E Log 17

U. S. DEPT. OF THE INTERIOR

GEOLOGICAL SURVEY

WATER RESOURCES DIVISION

PUNCHED

TRANSMITTED FOR ADP

MASTER CARD

Record by THOMSON (WASSON-C) Source of data LOG, DRILLER Date 4-26-63 Map Tupelo

State MISSISSIPPI County LEE (or town) LEE

Latitude: 34° 16' 12" N Longitude: 088° 42' 34" W Sequential number: 1

Lat-long accuracy: 10' T. 9° R 6° W, Sec 30, NE 1/4, NW 1/4, SE 1/4

Local well number: H 0 4 0 8 0 3 0 0 9 5 0 6 E Other number: CITY # 12 CHURCH ST

Local use: _____ Owner or name: TUPELO Address: _____

Ownership: County, Fed Gov't, (M) City, Corp or Co, Private, State Agency, Water Dist M

Use of water: Air cond, Bottling, Comm, Dewater, Power, Fire, Dom, Irr, Med, Ind, (P) P S, Rec, Stock, Instit, Unused, Repressure, Recharge, Desal-P.S., Desal-other, Other SP

Use of well: Anode, Drain, Seismic, Heat Res, Obs, Oil-gas, Recharge, Test, Unused, (W) Withdraw, Waste, Destroyed W

DATA AVAILABLE: Well data Freq. W/L meas.: Irregular I Field aquifer char.

Hyd. lab. data: _____ EUTW

Qual. water data; type: LAYNE partial (N-63)

Freq. sampling: _____ Pumpage inventory: no, period: _____

Aperture cards: _____

Log data: E LOG # 17, CUTTING SAMPLES DRIG LOG D E

WELL-DESCRIPTION CARD

SAME AS ON MASTER CARD Depth well: 655 ft Meas. GOOD DRIG LOG 3

Depth cased: 433 ft Casing type: STEEL; Diam. 12 in 1 2

Finish: porous concrete, gravel w. (C) screen, gravel, horz. open perf., screen, sd. pt., shored, open hole, other G

Method: (M) hyd drilled: air bored, cable, dug, rot, jetted, air percussion, rotary, drive wash, other H

Date Drilled: 1963 9 6 3 Pump intake setting: 418 ft 4 1 8

Driller: CARLOS WELL CO MEMPHIS

Lift (type): (A) air, bucket, cent, jet, (L) multiple, (M) multiple, (N) none, (P) piston, (R) rot, (S) submerg, (T) turb, other T Deep Shallow

Power (type): diesel, (elec) nat, gas, gasoline, hand, gas, wind; H.P. 75 V Trans. or meter no. _____

Descrip. MP _____ ft above LSD- Alt. MP _____

Alt. LSD: 340 3 4 0 Accuracy: (source) TOPO MAP 5

Water Level: 218 ft above MP 2 8 0 Accuracy: 360 @ #70 A

Date meas: Oct '63 0 6 3 Yield: 510 gpm 5 1 0 Method determined 1

Drawdown: 108 ft 1 0 8 Accuracy: AIR LINE 2 Pumping period 25 hrs 2 5

QUALITY OF WATER DATA: Iron 0.2 ppm Sulfate 4.44 ppm Chloride 73 ppm Hard. 91 ppm

Sp. Conduct _____ K x 10⁶ Temp. _____ °F _____ Date sampled _____

Taste, color, etc. _____

use main multiple screen? See E. log. 5118 1-11-78 W.L.: 275. 4/17/0

Well No.

H

40

Well No. H 40

Latitude-longitude _____
d m s d m s

HYDROGEOLOGIC CARD

SAME AS ON MASTER CARD Physiographic Province: _____ Section: 03

D Drainage Basin: _____ Subbasin: 13C

Top of well site: (D) depression, stream channel, dunes, flat, hilltop, sink, swamp, (E) (F) (H) (K) (L) (P) (S) (T) (U) (V) offshore, pediment, hillside, terrace, undulating, valley flat T

MAJOR AQUIFER: _____ system _____ series K3 aquifer, formation, group MCSHAN MS

Lithology: _____ Origin: 6 Aquifer Thickness: 87 ft

87 Length of well open to: 81 ft 81 Depth to top of: _____ ft 366

MINOR AQUIFER: _____ system _____ series K3 aquifer, formation, group GORDO G0

Lithology: _____ Origin: _____ Aquifer Thickness: 68 ft

68 Length of well open to: 40 ft 40 Depth to top of: 581 ft 581

Intervals Screened: 440-521 and 614-654

Depth to consolidated rock: _____ ft _____ Source of data: _____

Depth to basement: _____ ft _____ Source of data: _____

Surficial material: _____ Infiltration characteristics: _____

Coefficient Trans: _____ gpd/ft _____ Coefficient Storage: _____

Perm: _____ gpd/ft²; Spec cap: 4.7 gpm/ft; Number of geologic cards: _____

W.L. 335 ft 11-3-66 (AIR LINE) Pumping level
430 gpm (surrounding material)

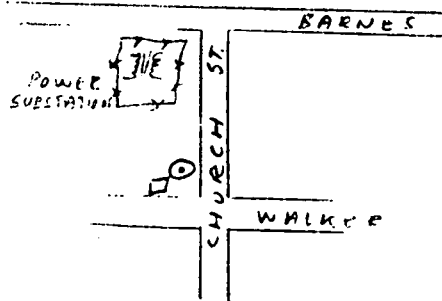
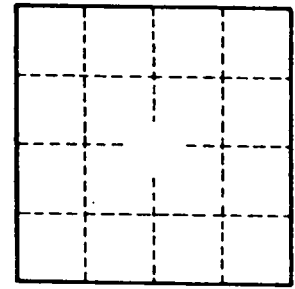

Eastw
&
Gord

Well No. H 40