

9-185
(October 1950)

UNITED STATES
DEPARTMENT OF THE INTERIOR
GEOLOGICAL SURVEY
WATER RESOURCES DIVISION

City #6

WELL SCHEDULE

Date 10-20, 1965 Field No. _____
Record by J. A. CALLAHAN Office No. 422
Source of data Obs, records and Mr. Posey (Supt. Water Works)

1. Location: State MISS County LEE

Map _____
NW 1/4 NW 1/4 sec 31 T 7 N R 6 W

2. Owner City of Tupelo Address Tupelo Miss
Tenant _____ Address Park + Leake St. well
Driller Layne-Central Co Address Memphis Tenn

3. Topography _____

4. Elevation _____ ft. above
_____ ft. below

5. Type: Dug, (drilled) driven, bored, jetted 519.45

6. Depth: Rept. _____ ft. Meas. _____ ft.

7. Casing: Diam. _____ in., to _____ in., Type _____
Depth 430 ft., Finish 60' of 8" shutter

8. Chief Aquifer _____ From _____ ft. to _____ ft.

Others _____

9. Water level 162.84 ft. rept. 10-20 1965 above 11'
vent on pump bowl meas. below which is 3.7 ft. above surface
below

10. Pump: Type Turbine Capacity _____ G. M.

Power: Kind Elec. Horsepower _____

11. Yield: Flow _____ G. M., Pump _____ G. M., Meas., Rept. Est. _____

Drawdown _____ ft. after _____ hours pumping _____ G. M.

12. Use: Dom., Stock, PS., RR., Ind., Irr., Obs pump still on well

Adequacy, permanence _____

13. Quality _____ Temp _____ °F.

Taste, odor, color _____ Sample Yes No

Unfit for _____

14. Remarks: (Log, Analyses, etc.) Gravel-wall well

370' of 12" 45# std line
60' of 8" 25# std line
60' of 8" shutter screen

Tape Down. 164.00

Wet Tape 1.16

162.84

Used (13.7) above ground.

159.14

N ↑

JACKSON

45 Hwy

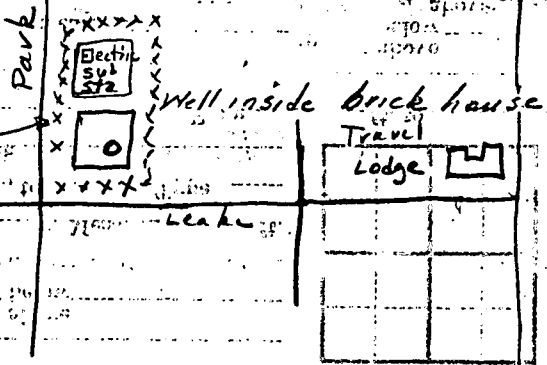

Test 8-13-54

Time	gpm.
0	440
20	400
30	380
40	360
50	350
60	340
70	315
80	300
100	

shut off head pressure



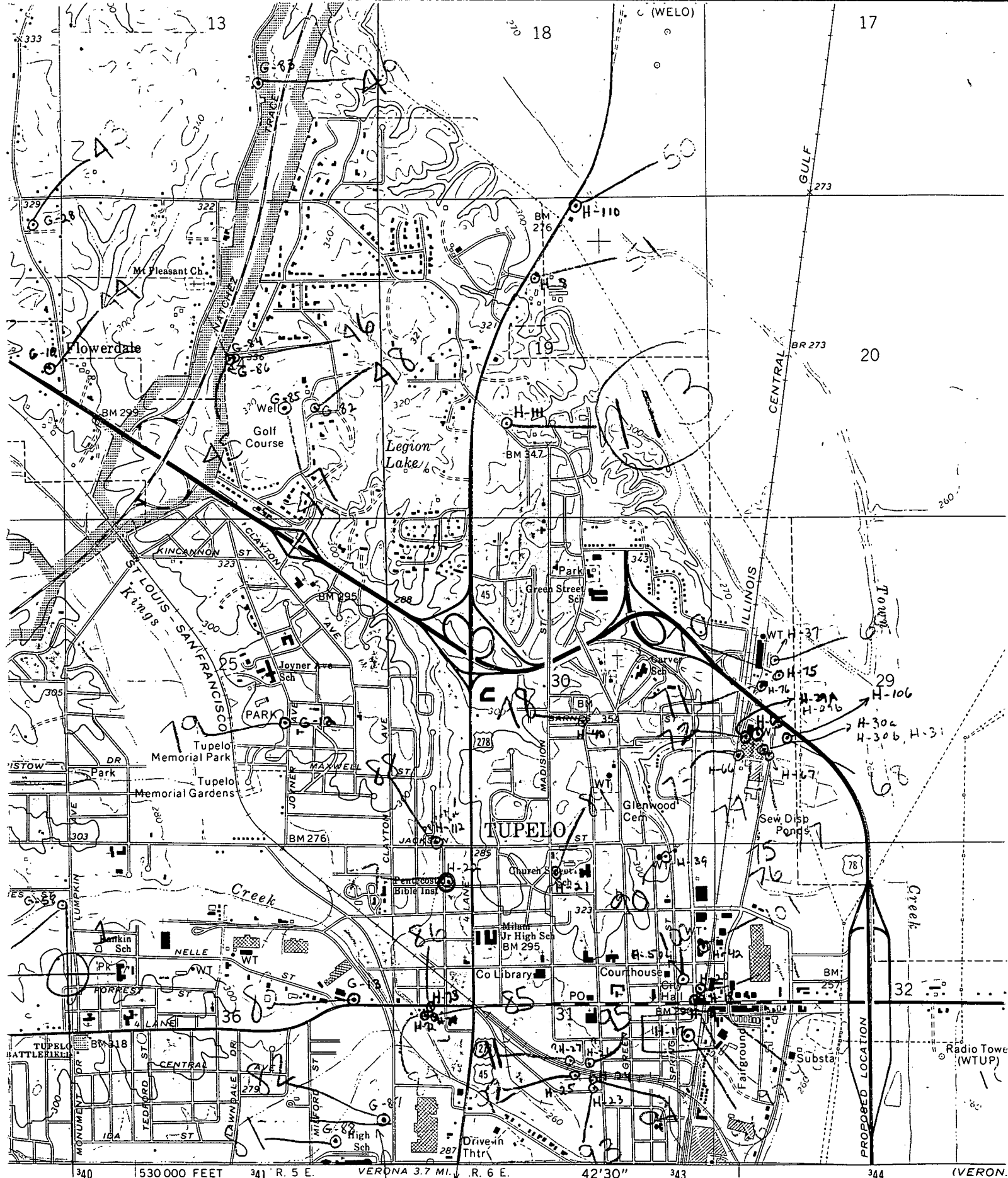

Published by the Geological Survey
 USGS
 metric methods from aerial
 Field checked 1973
 grid ticks: Mississippi coordinate
 (true Mercator)
 transverse Mercator grid ticks,

VERONA 3.7 MI. R. 5 E.
 COLUMBUS 64 MI. R. 6 E.

*There must be a road from
 road 45 to road 104*

TUPELO QUAD

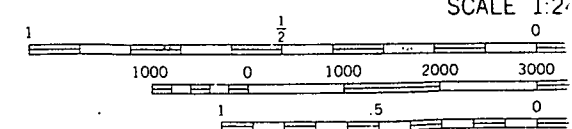

0° 57' 17 MILS
 3 1/2° 62 MILS

H-514 is

CONTOUR INTERVAL
 DOTTED LINES REPRESENT
 NATIONAL GEODETIC VERTI

(VERON.
 3252 II N

SCALE 1:2