

GW7468

Tupelo

RD Exp. (RM)
April 1966

Well No. H 21

WELL SCHEDULE

U. S. DEPT. OF THE INTERIOR GEOLOGICAL SURVEY WATER RESOURCES DIVISION

TRANSMITTED FOR ADP

MASTER CARD

Record by Thomson (F0177a -40) Source of data water users' cont. Date July 18, 1960 Map

State MISSISSIPPI County 28 (or town) LEE Sequential number: 41

Latitude: 34 15 49 N Longitude: 08 84 23 9 Sequential number: 1

Lat-long accuracy: 1 T. 9 R. 6 S. Sec 31, NW, NW, NE

Local well number: 10216A3109S06E Other number: CITY OF MADISON ST.

Local use: 064 Owner or name: CITY OF TUPELO Address: _____

Ownership: County, Fed Gov't, City, Corp or Co, Private, State Agency, Water Dist M

Use of water: (A) Air cond, Bottling, Comm, Dewater, Power, Fire, Dom, Irr, Med, Ind, P, Rec, (S) Stock, Instit, Unused, Repressure, Recharge, Desal-P S, Desal-other, Other U

Use of well: (A) Anode, Drain, Seismic, Heat Res, Obs, Oil-gas, Recharge, Test, Unused, Withdraw, Waste, Destroyed U

DATA AVAILABLE: Well data I Freq. W/L meas.: Irregular Field aquifer char. I

Hyd. lab. data: _____

Qual. water data; type: MSBH

Freq. sampling: _____ Pumpage inventory: _____

Aperture cards: _____

Log data: _____

Well #4
N. Madison

WELL-DESCRIPTION CARD

SAME AS ON MASTER CARD Depth well: 450 ft Meas. 450 accuracy 6

Depth cased: 370 ft Casing type: STEEL; Diam. 12 in 12

Finish: porous concrete, gravel w. screen, gravel w. horiz. gallery, open perf., screen, sd. pt., shored, open hole, other 6

Method Drilled: (A) air bored, (B) cable, (C) dug, (D) hyd rot, (E) jetted, (F) air percussion, (G) rotary, (H) reverse, (I) trenching, (J) driven, (K) wash, (L) other 4

Date Drilled: JUNE 1935 Pump intake setting: _____ ft

Driller: LAIN CENTRAL, MEMPHIS

Lift (type): (A) air, (B) bucket, (C) cent, (D) jet, (E) multiple, (F) multiple, (G) none, (H) piston, (I) rot, (J) submerg, (K) turb, (L) other T Deep D

Power (type): diesel, elec, gas, gasoline, hand, gas, wind; H.P. 40 Trans. or meter no. V

Descrip. MP TOP OF CASING 1 ft above LSD. Alt. MP 301

Alt. LSD: 300 Accuracy: 5

Water Level: 216 Accuracy: A

Date meas: 376 Yield: _____ gpm Method determined 61

Drawdown: _____ ft Accuracy: _____ Pumping period _____ hrs

QUALITY OF WATER DATA: Iron 0 Sulfate 5.6 Chloride 60 Hard. 93

Sp. Conduct 0 Temp. _____ Date sampled Nov 1960

Taste, color, etc. Good

Well No.

H 21

Well No. H-21

Latitude-longitude _____
d m s N S d m s

HYDROGEOLOGIC CARD

1 SAME AS ON MASTER CARD 19 Physiographic Province: 03 Section: _____
22 D Drainage Basin: 13C Subbasin: _____ 26

Top of well site: (D) depression, stream channel, dunes, flat, hilltop, sink, swamp, (E) (F) (H) (K) (L) (M) (P) (S) (T) (U) (V) offshore, pediment, hillside, terrace, undulating, valley flat 27 7

MAJOR AQUIFER: _____ system _____ series K3 _____ aquifer, formation, group MS 28 29 30 31

Lithology: _____ Origin: 3 Aquifer Thickness: _____ ft 32 33 34

Length of well open to: _____ ft _____ Depth to top of: _____ ft _____ 35 37 38 40 41 43

MINOR AQUIFER: _____ system _____ series _____ aquifer, formation, group _____ 44 45 46 47

Lithology: _____ Origin: _____ Aquifer Thickness: _____ ft 48 49 50

Length of well open to: _____ ft _____ Depth to top of: _____ ft _____ 51 53 54 56 57 59

Intervals Screened: 50' between 370-450'

Depth to consolidated rock: _____ ft _____ Source of data: _____ 60 63 64

Depth to basement: _____ ft _____ Source of data: _____ 65 68 69

Surficial material: _____ Infiltration characteristics: _____ 70 71 72

Coefficient Trans: _____ gpd/ft _____ Coefficient Storage: _____ 73 75 76 78

Coefficient Perm: _____ gpd/ft²; Spec cap: _____ gpm/ft; Number of geologic cards: _____ 77 79

W.L. 190.8 10-4-67 WL: 127.5 9.58
WL 216.36 3-17-76

ON N. MADISON ST NEAR SWIMMING POOL

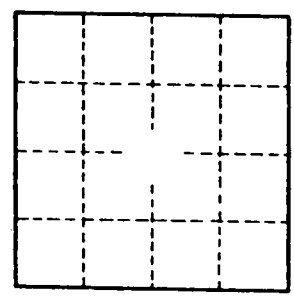
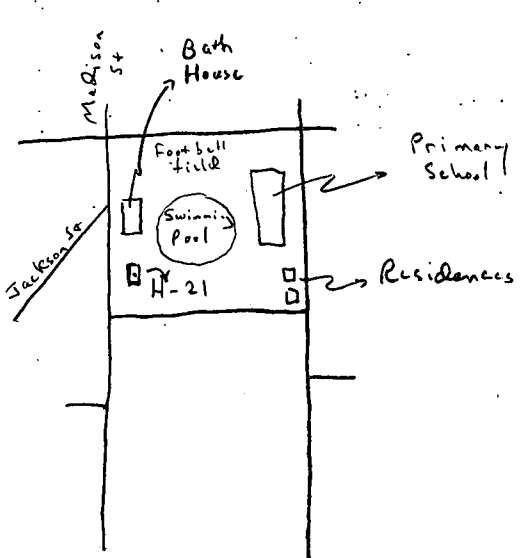

Well No. H-21

UP-DATED _____