

Recorded by WTD  
Date 2/76

U.S. GEOLOGICAL SURVEY  
WATER RESOURCES DIVISION  
MISSISSIPPI DISTRICT  
WELL RECORD

Well No. G82  
E-Log No. 78  
County Lee

Site ID 341709088432301 R=0\* T=A\* 2=W\*

GEN. SITE DATA

Data reliab. 3=C\*<sup>C</sup> Report. agency 4=USGS\* Dist. 6=28\* 7=28\* Co. 8=081\*  
Lat. Long./ 9=341709\* 10=0884323\* Well No. 12=5082\*  
Location 13=NESE S 24 T 09 S R 05 E\* Alt. 16=~~340~~ 380?  
Hyd. Unit (OWDC) 20= Date 21=11/18/1975\*  
Well use 23=I\* Water Use 24=U\* Hole depth 27=716\* Well depth 28= \*  
WL 30= Date 31= Source 33= \*  
Status 273= Project No. 5=

OWNER

R=158\* T=A\* Date 159# 11/18/1975\* Owner No.  
Owner 161= TUPELO

FIELD LOG

R=192\* T=A\* Date 193# Temp. 196#00010\* 197= \*  
R=192\* T=A\* Date 193# Cond. 196#00095\* 197= \*  
R=192\* T=A\* Date 193# pH 196#00400\* 197= \*

LOGGING

R=58\* T=A\* 59#1\* Date 60=11/18/1978\* Remarks  
Drig. 63=06.4\* Name Loyne Method 65=H\* Finish 66= \*

LOGGING

R=76\* T=A\* 59#1\*  
Top csgn. 77# Bot. csgn. 78= Diam. 79# \*  
R=76\* T=A\* 59#1\*  
Top csgn. 77# Bot. csgn. 78= Diam. 79# \*

LOGGING

R=82\* T=A\* 59#1\* Top 83# Bottom 84= \*  
Type 85= Diam. 87= Size 88= \*  
R=82\* T=A\* 59#1\* Top 83# Bottom 84= \*  
Type 85= Diam. 87= Size 88= \*

LOGGING

R= T=A\* 147# I\* Q 150= Q/S 272= \*

LIFT

R=42\* T= A \* Lift type 43# \* Intake 44= \* Power type 45= \*

Date 38= / / H.P. 46= \*

LOGS

R=198\* T= A \* Log 199# E \* Top 200= 2. \* Bot 201= 7.1.6. \*

R=198\* T= A \* Log 199# \* Top 200= \* Bot 201= \*

R=189\* T= A \* E Log No. 190# 0.1.8. \* 191= M I S S D I S T \*

ANAL.

R=114\* T= A \* Year 115# \* Type 120= \*

AQUIFERS

R=90\* T= A \* 236# 1 \* Top 91= \* Bot 92= \*

Unit ID 93= \* Name of Unit \_\_\_\_\_

R=90\* T= A \* 256# 1 \* Top 91= \* Bot 92= \*

Unit ID 93= \* Name of Unit \_\_\_\_\_

HYDRAULICS

R=98\* T= A \* 99# 1 \* Unit tested 100= \* 103= \*

R=105\* T= A \* 99# 1 \* Test No. 106# \*

107= \* Transmissivity (gal/d)/ft \_\_\_\_\_

108= \* Hydraul. cond. (gal/d)/ft<sup>2</sup> \_\_\_\_\_

110= \* Storage coeff. Boundaries \_\_\_\_\_

R=121\* T= \* Yr Begin 122# \*

Water Level Data Collection (1)

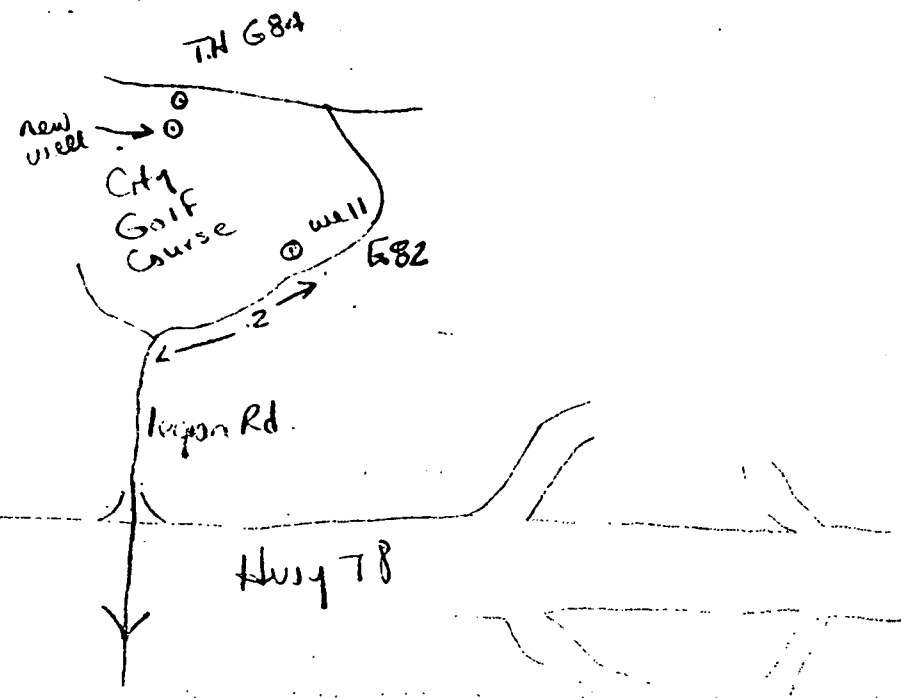

# TUPELO QUAD

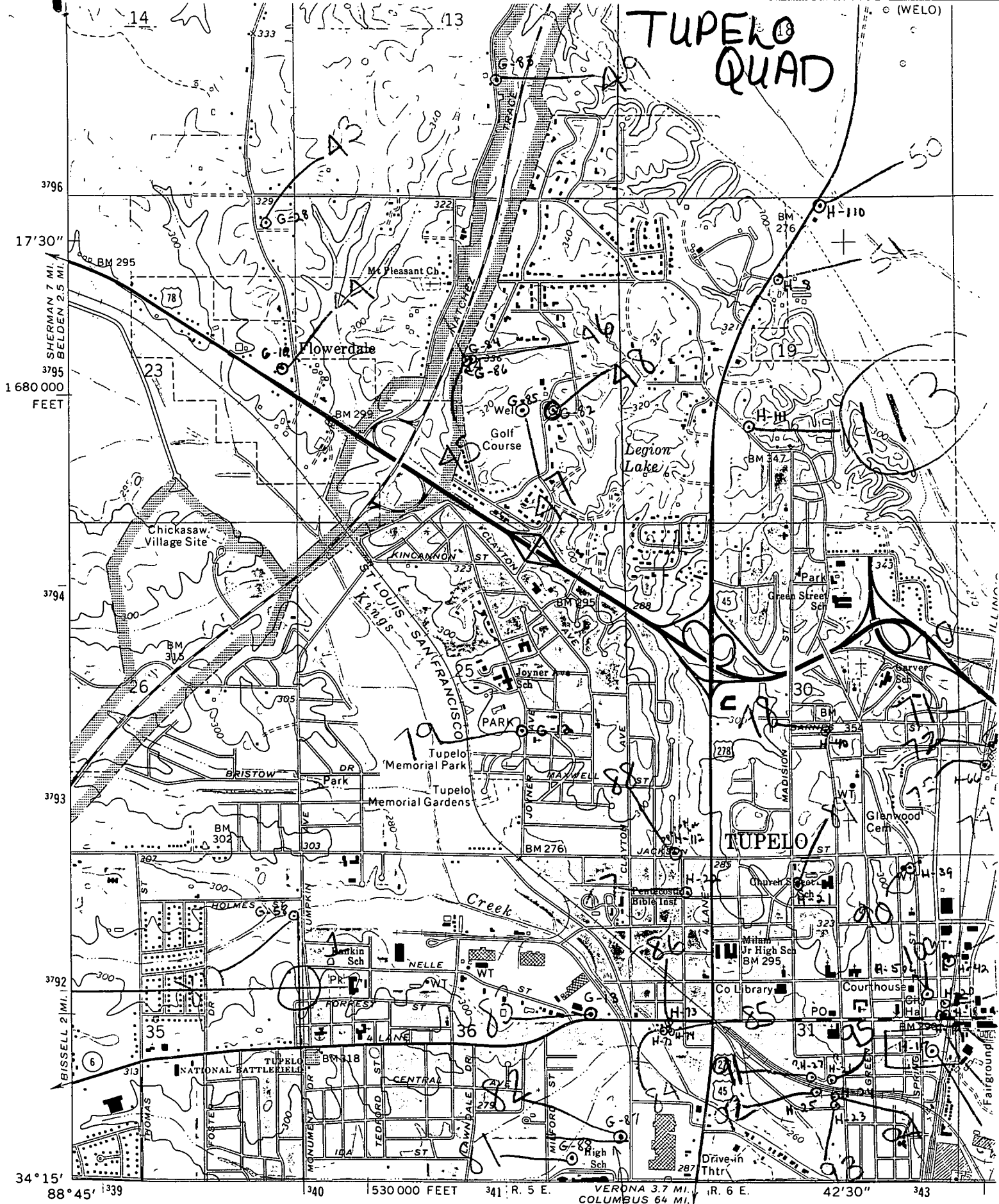

Mapped, edited, and published by the Geological Survey

Control by USGS and USC&GS

Topography by photogrammetric methods from aerial photographs taken 1972. Field checked 1973

Projection and 10,000-foot grid ticks: Mississippi coordinate system, east zone (transverse Mercator)

1000-metre Universal Transverse Mercator grid ticks, east zone, 1927 North American datum

*There must be a road here now*

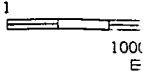
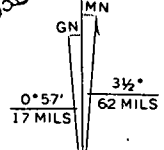

H-514

(BISSELL)  
3252 III NE