

Tupelo

WAD Exp. (GW)
April 1966

Well No. **G 28**

WELL SCHEDULE

U. S. DEPT. OF THE INTERIOR

GEOLOGICAL SURVEY

WATER RESOURCES DIVISION

TRANSMITTED FOR ADP

MASTER CARD

Record by Thompson Source of data Bowc Date 3/22/67 Map _____

State 28 County (or town) Lee 41

Latitude: 34 17 31 N Longitude: 08 84 42 2 Sequential number: 1

Lat-long accuracy: 3 T. 9 R. 5 Sec 23 SW, NE, NE

Local well number: 6028AA2309505E Other number: 129 B & M

Local use: _____ Owner or name: _____

Owner or name: SILAS COCKRAN Address: _____

Ownership: County, Fed Gov't, City, Corp or Co, Private, State Agency, Water Dist P

Use of water: (A) Air cond, (B) Bottling, (C) Comm, (D) Dewater, (E) Power, (F) Fire, (G) Dom, (H) Irr, (I) Med, (J) Ind, (K) P S, (L) Rec, (M) Stock, (N) Instit, (O) Unused, (P) Repressure, (Q) Recharge, (R) Desal-P S, (S) Desal-other, (T) Other H

Use of well: (A) Anode, (B) Drain, (C) Seismic, (D) Heat Res, (E) Obs, (F) Oil-gas, (G) Recharge, (H) Test, (I) Unused, (J) Withdraw, (K) Waste, (L) Destroyed W

DATA AVAILABLE: Well data I Freq. W/L meas.: _____ Field aquifer char. _____

Hyd. lab. data: _____

Qual. water data; type: USGS PARTIAL

Freq. sampling: _____ Pumpage inventory: no period: _____

Aperture cards: _____

Log data: DRILLERS LOG

WELL-DESCRIPTION CARD

SAME AS ON MASTER CARD Depth well: 500 ft Meas. 3

Depth cased: (first perf.) 162 ft Casing type: _____; Diam. 4 in

Finish: (C) concrete, (F) gravel w. (G) gravel w. (H) horiz. (I) open (J) screen, (K) sd. pt., (L) shored, (M) other X

Method: (A) air, (B) bored, (C) cable, (D) dug, (E) hyd jetted, (F) air, (G) reverse, (H) trenching, (I) driven, (J) drive, (K) rot., (L) percussion, (M) rotary, (N) wash, (O) other H

Date Drilled: 961 Pump intake setting: _____ ft

Driller: O.C. WEBB

Lift (type): (A) air, (B) bucket, (C) cent, (D) jet, (E) multiple, (F) multiple, (G) none, (H) piston, (I) rot, (J) submerg, (K) turb, (L) other Deep

Power (type): (A) diesel, (B) elec, (C) gas, (D) gasoline, (E) hand, (F) gas, (G) wind, (H) H.P. Trans. or meter no.

Descrip. MP _____ ft above below LSD. Alt. MP _____

Alt. LSD: 335 Accuracy: (source) 5

Water Level _____ ft above below MP; Ft below LSD 119 Accuracy: _____

Date meas: 10-12-61 Yield: 061 gpm Method determined _____

Drawdown: _____ ft Accuracy: _____ Pumping period _____ hrs

QUALITY OF WATER DATA: Iron _____ ppm Sulfate _____ ppm Chloride _____ ppm Hard. _____ ppm

Sp. Conduct 320 K x 10⁶ Temp. _____ °F Date sampled 2-17-67

Taste, color, etc. _____

Well No.

G 28

Well No. 628

Latitude-longitude _____
N
S
d m s d m s

HYDROGEOLOGIC CARD

SAME AS ON MASTER CARD Physiographic Province: 03 Section: _____
Drainage Basin: D Subbasin: 13C

Topo of well site: (D) depression, stream channel, dunes, flat, hilltop, sink, swamp, (E) offshore, pediment, hillside, terrace, undulating, valley flat (F) (G) (H) (I) (J) (K) (L) (M) (N) (O) (P) (Q) (R) (S) (T) (U) (V) _____ 27 S

MAJOR AQUIFER: _____ system _____ series K3 aquifer, formation, group EUTAW _____ 30 E2

Lithology: _____ Origin: 6 Aquifer Thickness: _____ ft
Length of well open to: _____ ft 190 Depth to top of: _____ ft 360

MINOR AQUIFER: _____ system _____ series _____ aquifer, formation, group _____ 46 _____

Lithology: _____ Origin: _____ Aquifer Thickness: _____ ft
Length of well open to: _____ ft _____ Depth to top of: _____ ft _____

Intervals Screened: _____

Depth to consolidated rock: _____ ft _____ Source of data: _____ 64 _____

Depth to basement: _____ ft _____ Source of data: _____ 69 _____

Surficial material: _____ Infiltration characteristics: _____ 77 _____

Coefficient Trans: _____ gpd/ft _____ Coefficient Storage: _____ 78 _____

Coefficient Perm: _____ gpd/ft²; Spec cap: _____ gpm/ft; Number of geologic cards: _____ 79 _____

WL 140.80 2/17/67

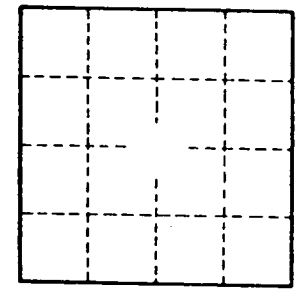
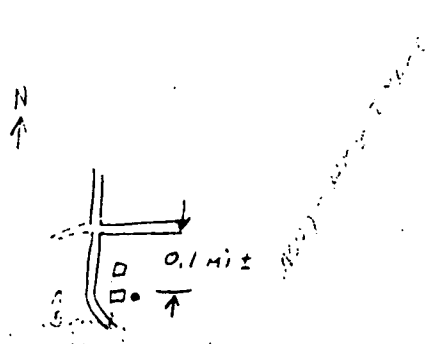

Well No. 628

#G28

10-12-61

WATER WELL DRILLERS LOG

312

H-309

Date: 10-12, 1961, Driller: C.C. Welch County:

(Name)

(1) Owner of Land: Delas Cockman
(Name)

Tupelo Miss
(Address)

(2) Location: 1/4, 1/4, Sec. 23 T9R5
1 miles north of Tupelo
(distance) (direction) (Nearest Town)

(3) Topography:
(Hilly) (Flat) (Level)

(4) Purpose of Well:
(Domestic Irrigation
Municipal, Industrial, Other)

Description & Color of Materials Sand, Clay, Red Clay, Shell, etc.	Thick- ness Feet	Depth Feet
Soil to 23 ft		
Sand & Blue		
Rock to 155 ft		
Blue sand to		
36 ft water rock		
6" water sand		
to 500 ft		

Information upon completion of well:

(1) Diameter 4 inches.

(2) Total Depth 500 feet.
140.80 2/17/67

(3) Water Level 114 feet below top of ground.

(4) Cased to 162 ft, Size 4"

(5) Screen: Size 0, Length 0

(6) Were any formations sealed against pollution?
 yes, no.

If YES depth of formation

Why

Drillers Remarks:

129 ELEV B35

(Use Back Side)

Well No.

Mail this copy to Board of Water Commissioners 429 Miss. St. Jackson, Miss.

TUPELO QUAD

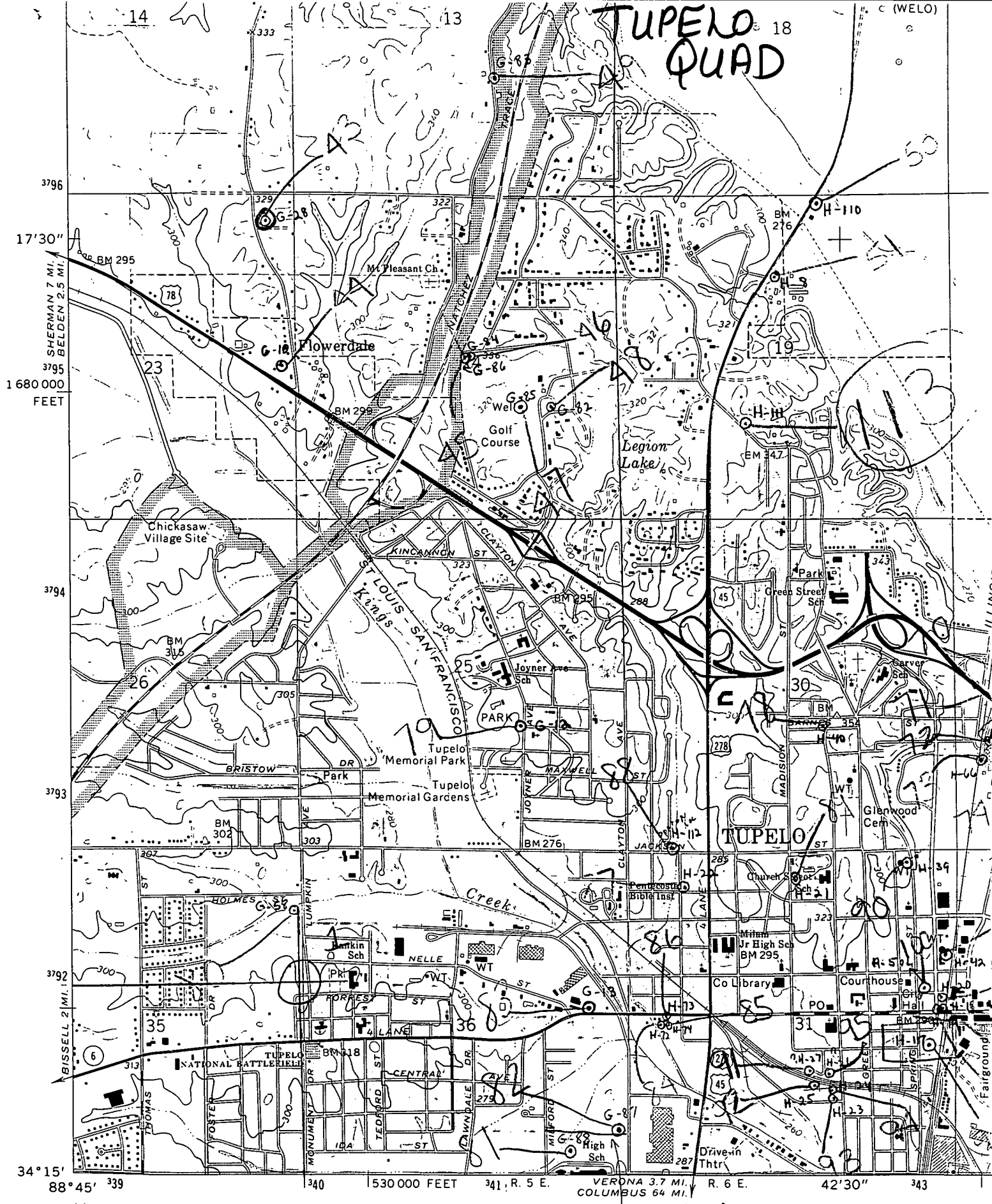

Mapped, edited, and published by the Geological Survey

Control by USGS and USC&GS

Topography by photogrammetric methods from aerial photographs taken 1972. Field checked 1973

Projection and 10,000-foot grid ticks: Mississippi coordinate system, east zone (transverse Mercator)

1000-metre Universal Transverse Mercator grid ticks, zone 18, above is true, 1927 North American datum

There is a new road

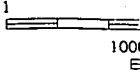
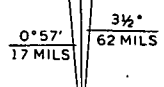

H-514

(BISSELL)
3252-III NE