

WRD Exp. (CU)  
April 1966

Well No. F 5

WELL SCHEDULE

U. S. DEPT. OF THE INTERIOR

GEOLOGICAL SURVEY

WATER RESOURCES DIVISION

TRANSMITTED FOR ADP

MASTER CARD

Record by WASSON Source of data DRILLER Date 3/2/67 Map \_\_\_\_\_

State 28 County (or town) LEE 41

Latitude: 34 21 45 N Longitude: 08 83 24 1 Sequential number: 1

Lat-long accuracy: 3 0 8 7 7 27 NE SE NE

Local well number: F005AA2708507E Other number: \_\_\_\_\_ B & H

Local use: \_\_\_\_\_ Owner or name: Charles Thompson

Owner or name: C THOMPSON Address: \_\_\_\_\_

Ownership: County, Fed Gov't, City, Corp or Co, Private, State Agency, Water Dist \_\_\_\_\_ P

Use of water: (A) Air cond, Bottling, Comm, Dewater, Power, Fire, Dom, Irr, Med, Ind, P S, Rec, (S) Stock, Instit, Unused, Repressure, Recharge, Desal-P.S., Desal-other, Other \_\_\_\_\_ H

Use of well: (A) Anode, Drain, Seismic, Heat Res, Obs, Oil-gas, Recharge, Test, Unused, Withdraw, Waste, Destroyed, (W) \_\_\_\_\_ W

DATA AVAILABLE: Well data \_\_\_\_\_ Freq. W/L meas.: \_\_\_\_\_ 0 Field aquifer char. \_\_\_\_\_

Hvd. lab. data: \_\_\_\_\_

Qual. water data; type: PARTIAL USGS

Freq. sampling: \_\_\_\_\_ Pumpage inventory: no period: \_\_\_\_\_

Aperture cards: \_\_\_\_\_

Log data: \_\_\_\_\_

WELL-DESCRIPTION CARD

SAME AS ON MASTER CARD Depth well: 220 ft Meas. 220 Meas. 3

Depth cased: 22 ft Casing type: \_\_\_\_\_; Diam. 4 in 9

Finish: porous concrete, gravel w. (perf.), gravel w. (screen), gravel w. (horiz. gallery), gravel w. (horiz. end), open perf., screen, sd. pt., shored, open hole, other \_\_\_\_\_ X

Method Drilled: (A) air rot, (B) bored, (C) cable, (D) dug, (H) hyd rot., (J) jet, (P) percussion, (R) rotary, (T) air reverse, (I) trenching, (V) driven, (W) wash, other \_\_\_\_\_ H

Date Drilled: 966 Pump intake setting: \_\_\_\_\_ ft \_\_\_\_\_

Driller: EWING GAS, TUPELO

Lift (type): (A) air, (B) bucket, (C) cent, (J) multiple, (L) multiple, (M) multiple, (N) none, (P) piston, (R) rot, (S) submerg, (T) turb, other \_\_\_\_\_ J Deep \_\_\_\_\_ Shallow \_\_\_\_\_

Power (type): diesel, elec, gas, gasoline, hand, gas, wind; H.P. 3/4 S Trans. or meter no. \_\_\_\_\_

Descrip. MP \_\_\_\_\_ ft above \_\_\_\_\_ ft below LSD. Alt. MP \_\_\_\_\_

Alt. LSD: 345 345 Accuracy: (source) \_\_\_\_\_ 5

Water Level 57 ft above MP; Ft below LSD 57 Accuracy: \_\_\_\_\_ A

Date meas: 3/2/67 367 Yield: \_\_\_\_\_ gpm Method determined \_\_\_\_\_

Drawdown: \_\_\_\_\_ ft Accuracy: \_\_\_\_\_ Pumping period \_\_\_\_\_ hrs \_\_\_\_\_

QUALITY OF WATER DATA: Iron \_\_\_\_\_ Sulfate \_\_\_\_\_ Chloride \_\_\_\_\_ Hard. \_\_\_\_\_

Sp. Conduct 440251 K x 10<sup>6</sup> 3 Temp. \_\_\_\_\_ °F \_\_\_\_\_ Date sampled 3/2/67 367

Taste, color, etc. \_\_\_\_\_

Well No. F 5

Well No. F 5

Latitude-longitude \_\_\_\_\_  
N  
S  
d m s d m s

HYDROGEOLOGIC CARD

SAME AS ON MASTER CARD  
Physiographic Province: 03 Section: \_\_\_\_\_  
Drainage Basin: D Subbasin: 13B

Topo of well site: (D) depression, stream channel, dunes, flat, hilltop, sink, swamp, (E) offshore, pediment, hillside, terrace, undulating, valley flat  
(F) (G) (H) (I) (J) (K) (L) (M) (N) (O) (P) (Q) (R) (S) (T) (U) (V) H

MAJOR AQUIFER: system \_\_\_\_\_ series K3 aquifer, formation, group E2  
EUTAW

Lithology: US Origin: 6 Aquifer Thickness: \_\_\_\_\_ ft  
Length of well open to: \_\_\_\_\_ ft Depth to top of: \_\_\_\_\_ ft

MINOR AQUIFER: system \_\_\_\_\_ series \_\_\_\_\_ aquifer, formation, group \_\_\_\_\_  
Lithology: \_\_\_\_\_ Origin: \_\_\_\_\_ Aquifer Thickness: \_\_\_\_\_ ft

Length of well open to: \_\_\_\_\_ ft Depth to top of: \_\_\_\_\_ ft

Intervals Screened: \_\_\_\_\_

Depth to consolidated rock: \_\_\_\_\_ ft Source of data: \_\_\_\_\_

Depth to basement: \_\_\_\_\_ ft Source of data: \_\_\_\_\_

Surficial material: \_\_\_\_\_ Infiltration characteristics: \_\_\_\_\_

Coefficient Trans: \_\_\_\_\_ gpd/ft<sup>2</sup> Coefficient Storage: \_\_\_\_\_

Coefficient Perm: \_\_\_\_\_ gpd/ft<sup>2</sup>; Spec cap: \_\_\_\_\_ gpm/ft; Number of geologic cards: \_\_\_\_\_

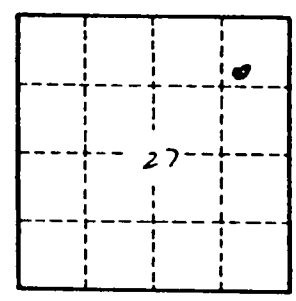
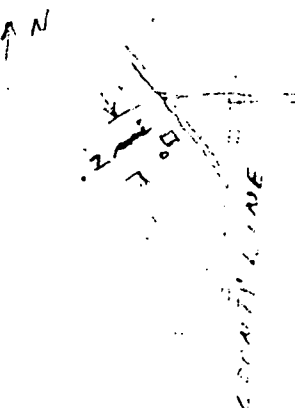

Well No. \_\_\_\_\_

F 5

# MOOREVILLE QUAD

3252 1 NE (RATLIFF)

354 35' 355 356 357 358 32'30"

