

9-185 July, 1918

#19 105D 576

Mr. Caldwell  
(analysis) (log)  
DEPARTMENT OF THE INTERIOR  
UNITED STATES GEOLOGICAL SURVEY  
WATER RESOURCES BRANCH

Owned by  
W.E. MILAM, JR.  
1958

Well Schedule

Date: Sept. 16 19 19 Field No. 85  
Record by: L. W. Stephenson Office No. E11

1. Location: State Saltillo, Mex. County Lee

Quadrangle 1st yds. S. of M. & O. R. P. Station  
NE NW 1/4 sec. 2N T. 8 R. 6

2. Owner Mrs. H. E. Williams Address Saltillo, Mex.

Driller \_\_\_\_\_ Address \_\_\_\_\_

3. Topography Alluvial bottom (creek)

4. Altitude 300 ft above 10 ft below Track at station

5. Type: Dug, drilled, driven, bored Drilled

6. Depth 350 ft. Date 1907

7. Diameter: top 5" bottom 3"

8. Chief Aquifer Ke

9. Casing: Type Steel Depth 40 ft. Diam. 5" to \_\_\_\_\_

Finish Open hole below casing

10. Water level \_\_\_\_\_ ft. above \_\_\_\_\_ below \_\_\_\_\_

11. Pump: Type Hand operated Capacity \_\_\_\_\_ G. M.

Power: Kind Hand Elec. Horsepower \_\_\_\_\_

12. Yield: Flow \_\_\_\_\_ G. M. Pump \_\_\_\_\_ G. M. Meas. Rept \_\_\_\_\_

Drawdown \_\_\_\_\_ ft.; pumping \_\_\_\_\_ G. M.; time \_\_\_\_\_

13. Use: Dom., Stock, PS, RR, Ind, DW, Irr Quantity \_\_\_\_\_

Adequacy, permanence Plenty

14. Quality: Good, fair, bad Good Sample Yes yes No \_\_\_\_\_

Taste, odor, color \_\_\_\_\_ Temp \_\_\_\_\_ °F

Unfit for \_\_\_\_\_

Sanitation \_\_\_\_\_

15. Cost: Well, \$ \_\_\_\_\_; Plant (well, pump, power, etc.), \$ \_\_\_\_\_

Operating, \$ \_\_\_\_\_ per \_\_\_\_\_ inc. \_\_\_\_\_ exc. \_\_\_\_\_

Log, analysis, authority \_\_\_\_\_ on back page \_\_\_\_\_

(Over) WR 508 871 (complete)

DEPARTMENT OF THE INTERIOR  
UNITED STATES GEOLOGICAL SURVEY  
WATER RESOURCES BRANCH

Mr. Kidwell;

Date: \_\_\_\_\_  
Record # \_\_\_\_\_  
Office No. \_\_\_\_\_

analysis to

Mr. A. E. Milam

N. Saltillo, Miss

MAIN ST. SALTILLO

Red & blue  
Please  
Large white  
Loose 1/2 green  
top  
Will appear  
back of house

1. Location: State \_\_\_\_\_

2. County: \_\_\_\_\_

3. District: \_\_\_\_\_

4. Section: \_\_\_\_\_

5. Township: \_\_\_\_\_

6. Range: \_\_\_\_\_

7. Section: \_\_\_\_\_

8. Name of well: \_\_\_\_\_

9. Date of installation: \_\_\_\_\_

10. Name of owner: \_\_\_\_\_

11. Name of operator: \_\_\_\_\_

12. Name of engineer: \_\_\_\_\_

13. Name of analyst: \_\_\_\_\_

14. Quality: Good fair bad \_\_\_\_\_

15. Taste odor color \_\_\_\_\_

16. Sulfur \_\_\_\_\_

17. Sulfur \_\_\_\_\_

18. Corrosive \_\_\_\_\_

19. Operating \_\_\_\_\_

20. \_\_\_\_\_

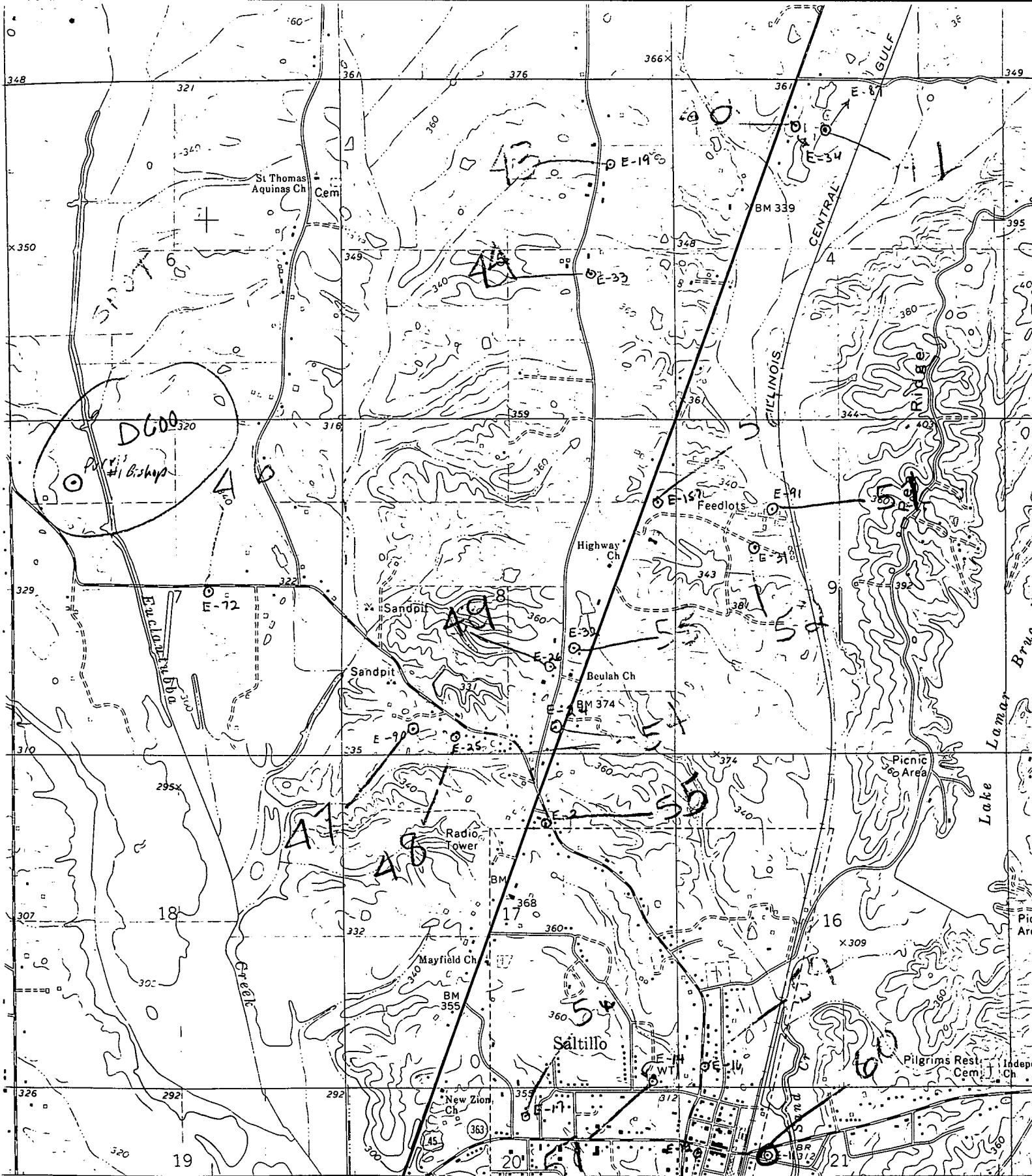

R 6 E 42'30" TUPELO 8 MI. COLUMBUS 74 MI. (TUPELO) 345 3252 1 SW 346 40'

SCALE 1:24 000

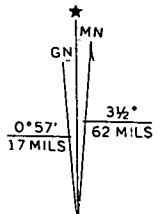
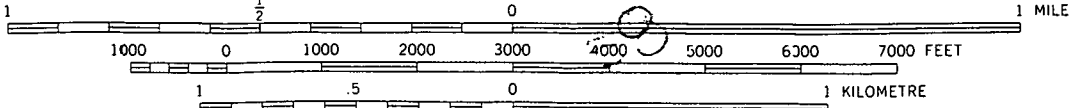

CONTOUR INTERVAL 20 FEET  
 DOTTED LINES REPRESENT 10-FOOT CONTOURS  
 NATIONAL GEODETIC VERTICAL DATUM OF 1929

**GUNTOWN  
 QUAD**