

OIL & GAS WELL SCHEDULE

County: 81

Well No.: D600

Company: Purvis Oil Corp.

Well: #1 Herman Bishop

Location: 990' FNL + 990' FNL <sup>SE, NW, NW</sup> S7 T8S R6E

Elevation:

G.L.: 306

D.F.: \_\_\_\_\_

K.B.: 300

# GUNTOWN QUAD

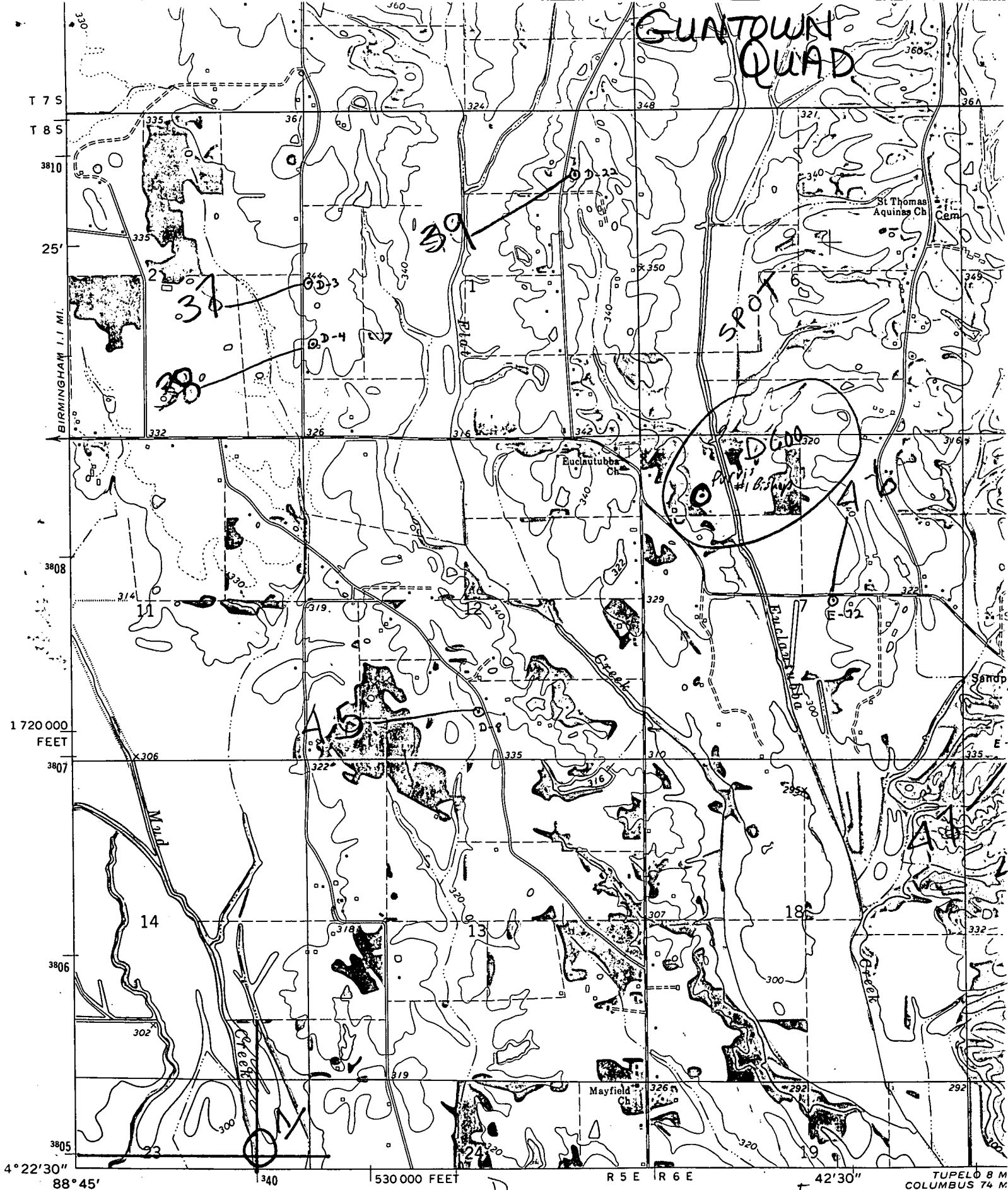

1 720 000 FEET

530 000 FEET

530 000 FEET

530 000 FEET

530 000 FEET

88° 45'

88° 45'

88° 45'

88° 45'

R 5 E R 6 E

42' 30"

TUPELO 8 M

COLUMBUS 74 M

Mapped, edited, and published by the Geological Survey

Control by USGS and USC&GS

Topography by photogrammetric methods from aerial photographs taken 1972. Field checked 1973

Projection and 10,000-foot grid ticks: Mississippi coordinate system, east zone (transverse Mercator)

1000-metre Universal Transverse Mercator grid ticks,

0° 57' 17 MILS

3 1/2° 62 MILS

1000

1