

9-185  
(October 1950)

UNITED STATES  
DEPARTMENT OF THE INTERIOR  
GEOLOGICAL SURVEY  
WATER RESOURCES DIVISION

WELL SCHEDULE

Date 9-15-56, 19\_\_\_\_ Field No. 124  
Record by H.F.F. Office No. D.3  
Source of data Mr. Murphy

1. Location: State Miss County Lee  
Map \_\_\_\_\_

N W SW 1/4 SW 1/4 sec 1 T 3 NR 5 EW

2. Owner: J.F. Murphy Address Gun town R3  
Tenant: MURPHY Address \_\_\_\_\_  
Driller \_\_\_\_\_ Address \_\_\_\_\_

3. Topography rolling hill

4. Elevation 350 ft. above  
below \_\_\_\_\_

5. Type: Dug, drilled, driven, ~~bored~~, jetted \_\_\_\_\_ 19\_\_\_\_

6. Depth: Rept. 200+ ft. Meas. \_\_\_\_\_ ft.

7. Casing: Diam. 4 in., to \_\_\_\_\_ in., Type \_\_\_\_\_  
Depth \_\_\_\_\_ ft., Finish \_\_\_\_\_

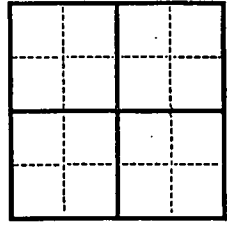

8. Chief Aquifer KG KSL From \_\_\_\_\_ ft. to \_\_\_\_\_ ft.  
Others \_\_\_\_\_

9. Water level 100 ft. rept. meas. \_\_\_\_\_ 1951 above  
below \_\_\_\_\_ which is \_\_\_\_\_ ft. above  
below surface

10. Pump: Type B Capacity \_\_\_\_\_ G. M.  
Power: Kind 400 Horsepower \_\_\_\_\_

11. Yield: Flow \_\_\_\_\_ G. M., Pump \_\_\_\_\_ G. M., Meas., Rept. Est. \_\_\_\_\_  
Drawdown \_\_\_\_\_ ft. after \_\_\_\_\_ hours pumping \_\_\_\_\_ G. M.

12. Use: Dom., Stock, PS., RR., Ind., Irr., Obs. \_\_\_\_\_  
Adequacy, permanence \_\_\_\_\_

13. Quality slightly limy Temp \_\_\_\_\_ °F.  
Taste, odor, color \_\_\_\_\_ Sample Yes  
No \_\_\_\_\_  
Unfit for \_\_\_\_\_

14. Remarks: (Log, Analyses, etc.) \_\_\_\_\_

Possible use for domestic purposes

14. Name of person or organization: \_\_\_\_\_  
 15. Address: \_\_\_\_\_  
 16. City: \_\_\_\_\_ State: \_\_\_\_\_  
 17. Country: \_\_\_\_\_  
 18. Telephone: \_\_\_\_\_  
 19. Name of person to whom correspondence should be sent: \_\_\_\_\_  
 20. Title: \_\_\_\_\_  
 21. Name of organization: \_\_\_\_\_  
 22. Address: \_\_\_\_\_  
 23. City: \_\_\_\_\_ State: \_\_\_\_\_  
 24. Country: \_\_\_\_\_  
 25. Telephone: \_\_\_\_\_



26. Name of person to whom correspondence should be sent: *See 123*  
 27. Title: \_\_\_\_\_  
 28. Name of organization: \_\_\_\_\_

MAIL SCHEDULE

MAIL RESOURCES DIVISION  
 GEOLOGICAL SURVEY  
 DEPARTMENT OF THE INTERIOR  
 UNITED STATES

(Circular stamp)  
 1950

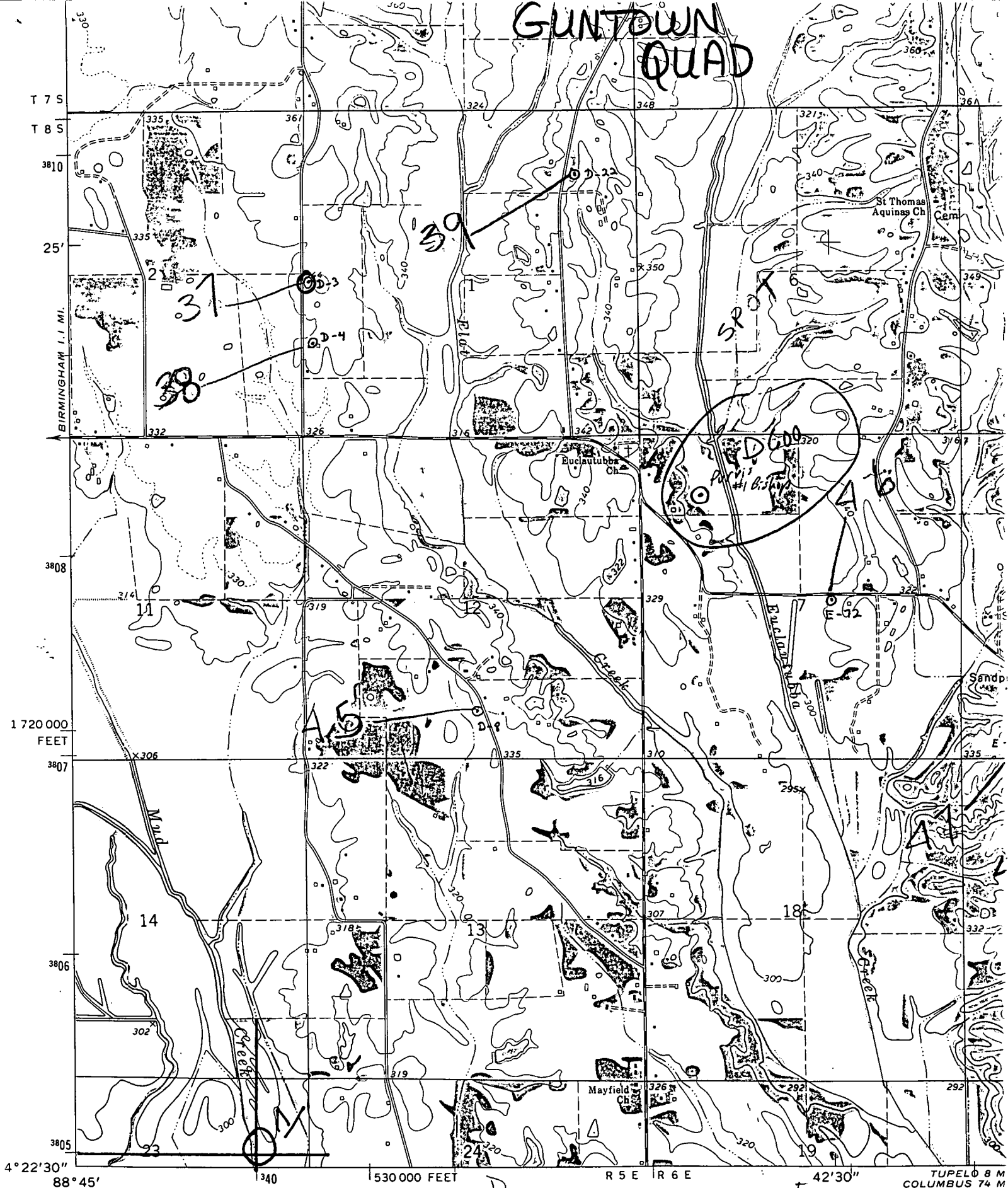
# GUNTOWN QUAD



4° 22' 30" 88° 45' 530000 FEET R 5 E R 6 E 42' 30" TUPELO 8 M COLUMBUS 74 M

Mapped, edited, and published by the Geological Survey

Control by USGS and USC&GS

Topography by photogrammetric methods from aerial photographs taken 1972. Field checked 1973

Projection and 10,000-foot grid ticks: Mississippi coordinate system, east zone (transverse Mercator)  
1000-metre Universal Transverse Mercator grid ticks,

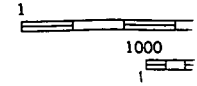
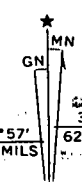

14 62 5000