

Ratliff

WRD Exp. (GW)
April 1966

Well No. C4

WELL SCHEDULE

Location does not match

U. S. DEPT. OF THE INTERIOR

GEOLOGICAL SURVEY

WATER RESOURCES DIVISION

TRANSMITTED FOR ADP

MASTER CARD

Record by Hitt Source of data O. Wigginton Date 10/30/56 Map Tupelo 1:62,500

State 28 County (or town) Lee 41

Latitude: 34 28 22 N Longitude: 08 8 3 6 3 2 Sequential number: 1

Lat-long accuracy: 2 7 7 W Sec 18 SE NW

Local well number: C004C1807507E Other number: B & M

Local use: _____ Owner or name: Stubbs Est.

Owner or name: STUBBS ESTATE Address: Rt 3 Baldwin

Ownership: County, Fed Gov't, City, Corp or Co, Private, State Agency, Water Dist P

Use of water: S (S) (T) (U) (V) (W) (X) (Y) (Z) Stock, Instat, Unused, Repressure, Recharge, Desal-P S; Desal-other, Other S

Use of well: U (A) (D) (G) (H) (I) (M) (N) (P) (R) (U) (W) (X) (Z) Anode, Drain, Seismic, Heat Res, Obs, Oil-gas, Recharge, Test, Unused, Withdraw, Waste, Destroyed U

DATA AVAILABLE: Well data Freq. W/L meas.: Field aquifer char.

Hyd. lab. data:

Qual. water data; type:

Freq. sampling: Pumpage inventory: period: _____

Aperture cards: yes

Log data:

WELL-DESCRIPTION CARD

SAME AS ON MASTER CARD Depth well: 360-365 ft 365 Meas. 6

Depth cased; (first perf.) _____ ft Casing type: _____; Diam. 4 in

Finish: porous concrete, gravel w. (perf.), gravel w. (screen), horiz. gallery, open end, perf., screen, sd. pt., shored, other H

Method Drilled: H (A) (B) (C) (D) (H) (J) (P) (R) (T) (V) (W) (Z) air bored, cable, dug, hyd rot., jetted, air percussion, rotary, reverse trenching, driven, drive wash, other

Date Drilled: _____ Pump intake setting: _____ ft

Driller: _____ name _____ address _____

Lift (type): N (A) (B) (C) (J) (L) (M) (N) (P) (R) (S) (T) (Z) air, bucket, cent, jet, multiple, multiple, none, piston, rot, submerg, turb, other N Deep Shallow

Power (type): _____ nat _____ LP _____ Trans. or meter no.

Descrip. MP _____ above _____ ft below LSD, Alt. MP _____

Alt. LSD: 310 310 Accuracy: Topo map 5

Water Level: 2 ft above below MP; Ft above below LSD +2 Accuracy: _____ A

Date meas: 10/30/56 0.56 Yield: _____ gpm Method determined _____

Drawdown: _____ ft Accuracy: _____ Pumping period _____ hrs

QUALITY OF WATER DATA: Iron _____ ppm Sulfate _____ ppm Chloride _____ ppm Hard. _____ ppm

Sp. Conduct _____ K x 10⁶ Temp. _____ °F Date sampled _____

Taste, color, etc. Good, clear

Well No.

C4

Well No. C4

Latitude-longitude 34 28 22 ^N OFF 86 32
d m s d m s

HYDROGEOLOGIC CARD

SAME AS ON MASTER CARD 03 Section: _____
 Physiographic Province: _____
 Drainage Basin: D Subbasin: 13B

Topo of well site: (D) (C) (E) (F) (H) (K) (L) _____
 (φ) (P) (S) (T) (U) (V) _____
 offshore, pediment, hillside, terrace, undulating, valley flat _____

MAJOR AQUIFER: _____ system _____ series K3 _____ aquifer, formation, group KM _____ MS

Lithology: _____ Origin: 3 _____ Aquifer Thickness: _____ ft
 Length of well open to: _____ ft _____ Depth to top of: _____ ft _____

MINOR AQUIFER: _____ system _____ series _____ aquifer, formation, group _____

Lithology: _____ Origin: _____ Aquifer Thickness: _____ ft
 Length of well open to: _____ ft _____ Depth to top of: _____ ft _____

Intervals Screened: _____

Depth to consolidated rock: _____ ft _____ Source of data: _____

Depth to basement: _____ ft _____ Source of data: _____

Surficial material: _____ Infiltration characteristics: _____

Coefficient Trans: _____ gpd/ft _____ Coefficient Storage: _____

Coefficient Perm: _____ gpd/ft²; Spec cap: _____ gpm/ft; Number of geologic cards: _____

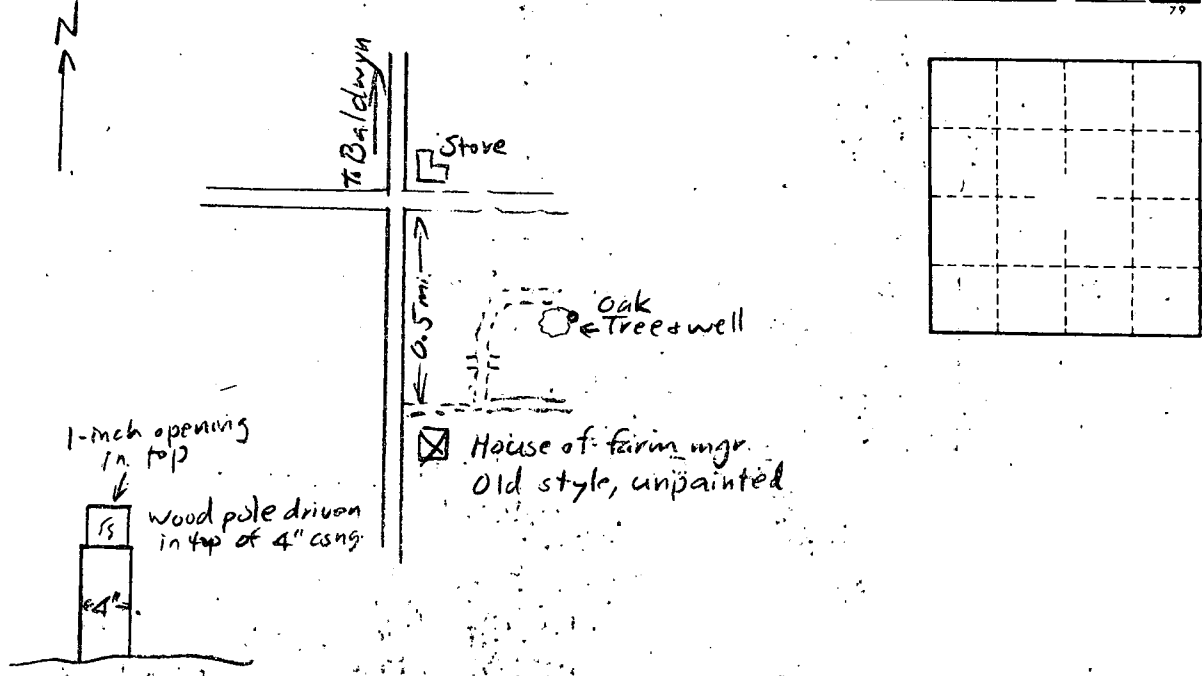

Well No. C4