

WRD Exp. (GW)  
April 1966

Well No. B 38

WELL SCHEDULE

U. S. DEPT. OF THE INTERIOR

GEOLOGICAL SURVEY

WATER RESOURCES DIVISION

TRANSMITTED FOR ADP

MASTER CARD

Record by THOMSON Source of data Bowling Date 3/9/67 Map \_\_\_\_\_

State 28 County (or town) LEE 41

Latitude: 34 26 52 N Longitude: 08 39 30 Sequential number: 1

Lat-long accuracy: 3 T. 7 N. R. 6 W. Sec. 27 SE/SE, NE, NW

Local well number: B0388A2707506E Other number: 25 B & M

Local use: \_\_\_\_\_ Owner or name: WILLIAM J HALL Address: GUNTOWN

Ownership: County, Fed Gov't, City, Corp or Co, Private, State Agency, Water Dist. P

Use of water: (A) Air cond, (B) Bottling, (C) Comm, (D) Dewater, (E) Power, (F) Fire, (G) Dom, (H) Irr, (I) Med, (J) P S, (K) Rec, (L) Stock, (M) Instit, (N) Unused, (O) Reppure, (P) Recharge, (Q) Desal-P S, (R) Desal-other, (S) Other. H

Use of well: (A) Anode, (B) Drain, (C) Seismic, (D) Heat Res, (E) Obs, (F) Oil-gas, (G) Recharge, (H) Test, (I) Unused, (J) Withdraw, (K) Waste, (L) Destroyed. W

DATA AVAILABLE: Well data  Freq. W/L meas.:  Field aquifer char.

Hyd. lab. data:

Qual. water data; type: \_\_\_\_\_

Freq. sampling: \_\_\_\_\_ Pumpage inventory:  period: \_\_\_\_\_

Aperture cards: \_\_\_\_\_

Log data: DRILLERS LOG D

WELL-DESCRIPTION CARD

SAME AS ON MASTER CARD

Depth well: 200 ft Meas. 3 accuracy

Depth cased; (first perf.): \_\_\_\_\_ ft Casing type: \_\_\_\_\_; Diam. in 4

Finish: (C) porous concrete, (F) gravel w. (perf.), (G) gravel w. (screen), (H) horiz. gallery, (I) open end, (J) other. (K) perf., (L) screen, (M) sd. pt., (N) shored, (O) open hole, (P) other. X

Method Drilled: (A) air rot., (B) bored, (C) cable, (D) dug, (E) hyd rot., (F) jetted, (G) air percussion, (H) reverse, (I) rotary, (J) trenching, (K) driven, (L) drive wash, (M) other. H

Date Drilled: 963 Pump intake setting: \_\_\_\_\_ ft

Driller: HERNDON SHANNON

Lift (type): (A) air, (B) bucket, (C) cent, (D) jet, (E) multiple, (F) multiple, (G) none, (H) piston, (I) rot, (J) submerg, (K) turb, (L) other. Deep  Shallow

Power (type): (A) diesel, (B) elec, (C) gas, (D) gasoline, (E) hand, (F) gas, (G) wind, (H) H.P., (I) Trans. or meter no.

Descrip. MP 395 ft above below LSD. Alt. MP \_\_\_\_\_

Alt. LSD: 400 Accuracy: (source) 5

Water Level: \_\_\_\_\_ ft above below MP; \_\_\_\_\_ ft above below LSD. Accuracy: D

Date meas: 2-13-63 Yield: 263 gpm Method determined: \_\_\_\_\_

Drawdown: \_\_\_\_\_ ft Accuracy: \_\_\_\_\_ Pumping period: \_\_\_\_\_ hrs

QUALITY OF WATER DATA: Iron \_\_\_\_\_ ppm Sulfate \_\_\_\_\_ ppm Chloride \_\_\_\_\_ ppm Hard. \_\_\_\_\_ ppm

Sp. Conduct \_\_\_\_\_ K x 10<sup>6</sup> Temp. \_\_\_\_\_ °F Date sampled: \_\_\_\_\_

Taste, color, etc. \_\_\_\_\_

Well No. B 38

Well No. B38

Latitude-longitude \_\_\_\_\_  
N  
S  
d m s d m s

**HYDROGEOLOGIC CARD**

SAME AS ON MASTER CARD Physiographic Province: \_\_\_\_\_ Section: 03  
Drainage Basin: D Subbasin: 13B

Topo of well site: (D) depression, stream channel, dunes, flat, hilltop, sink, swamp, (K) (L) offshore, pediment, hillside, terrace, undulating, valley flat (S)

MAJOR AQUIFER: system \_\_\_\_\_ series K3 aquifer, formation, group COFFE CIS  
Lithology: \_\_\_\_\_ UX Origin: 6 Aquifer Thickness: \_\_\_\_\_ ft

Length of well open to: \_\_\_\_\_ ft Depth to top of: \_\_\_\_\_ ft

MINOR AQUIFER: system \_\_\_\_\_ series \_\_\_\_\_ aquifer, formation, group \_\_\_\_\_  
Lithology: \_\_\_\_\_ Origin: \_\_\_\_\_ Aquifer Thickness: \_\_\_\_\_ ft

Length of well open to: \_\_\_\_\_ ft Depth to top of: \_\_\_\_\_ ft

Intervals Screened: \_\_\_\_\_

Depth to consolidated rock: \_\_\_\_\_ ft Source of data: \_\_\_\_\_

Depth to basement: \_\_\_\_\_ ft Source of data: \_\_\_\_\_

Surficial material: \_\_\_\_\_ Infiltration characteristics: \_\_\_\_\_

Coefficient Trans: \_\_\_\_\_ gpd/ft Coefficient Storage: \_\_\_\_\_

Coefficient Perm: \_\_\_\_\_ gpd/ft<sup>2</sup>; Spec cap: \_\_\_\_\_ gpm/ft; Number of geologic cards: \_\_\_\_\_

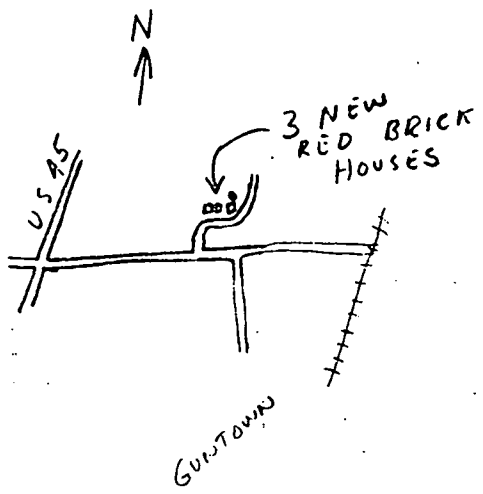
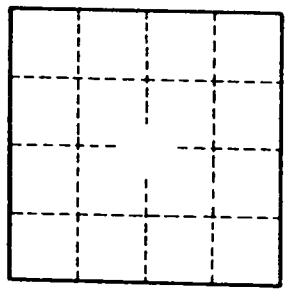

Well No. B38

LEE

B 38

2-13-63

WATER WELL DRILLERS LOG

HERNDON WELL & SUPPLY CO.

Date: Feb 13, 1963, Driller: P. O. BOX 42 County Lee

SHANNON, MISSISSIPPI (Name)

Contractor		Description & Color of Materials Sand, Clay, Red Clay, Shell, etc.	Thick- ness Feet	Depth Feet
(1) Owner of Land: <u>William J. Hays</u> (Name)	<u>Georgetown, Miss.</u> (Address)	<u>surface sand &amp; clay</u>		0
(2) Location: <u>1/4, 1/4, Sec 27 T 75 R 6E</u>	<u>Georgetown</u> (Nearest Town)	<u>Blue rock</u>		17
(3) Topography: <u>Flat</u> (Hilly) (Flat) (Level)		<u>sand</u>		80
(4) Purpose of Well: <u>Domestic</u> (Domestic Irrigation Municipal, Industrial, Other)		<u>Bottom 200 Three red brick casing</u>		

Information upon completion of well:

- (1) Diameter 4 inches.
- (2) Total Depth 200 feet.
- (3) Water Level 80 feet below top of ground.
- (4) Cased to 19'6", Size 4"
- (5) Screen: Size —, Length —
- (6) Were any formations sealed against pollution?  
 yes,  no.

If YES depth of formation 17 ft.

Why surface & sand

Drillers Remarks:

25 ✓ FLEW 400

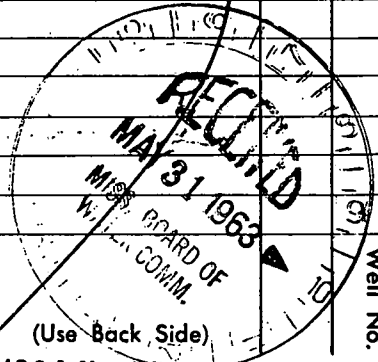
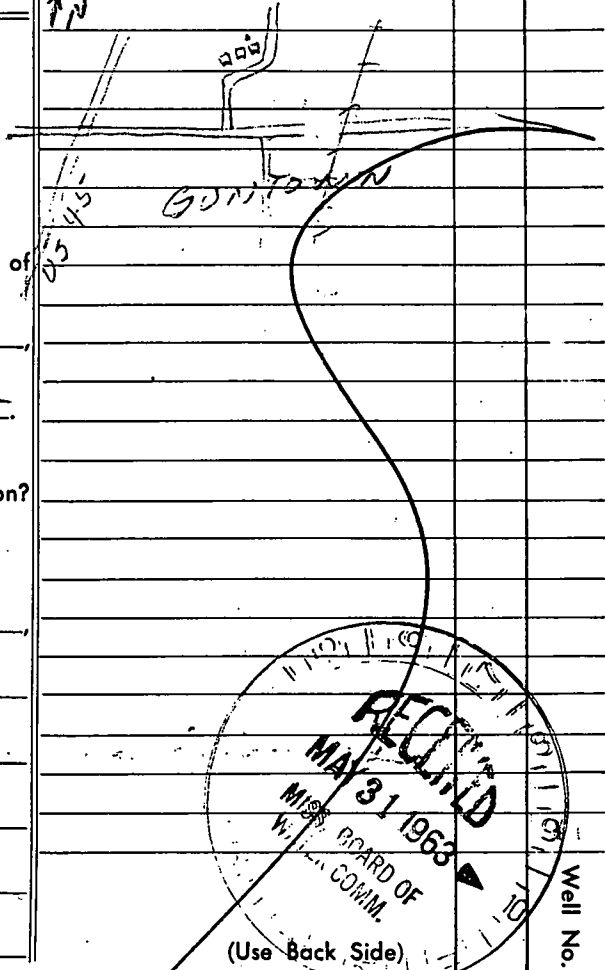

(Use Back Side)

Well No.

Mail this copy to Board of Water Commissioners 429 Miss. St. Jackson, Miss.

# GUNTOWN QUAD

