

WRD Exp. (GW)  
April 1966

Well No. F 9 a

### WELL SCHEDULE

U. S. DEPT. OF THE INTERIOR

GEOLOGICAL SURVEY

WATER RESOURCES DIVISION

#### MASTER CARD

25

Record by J. Harrell Source of data Bowc Date 8/1/68 Map \_\_\_\_\_

State 56 County 28 (or town) Leake 40

Latitude: 32° 45' 43" N Longitude: 08° 9' 32" W Sequential number: 1

Lat-long accuracy: 5 T. 110 S, R 7 E, Sec 36, NW

Local well number: F009 B3611 N07E Other number: \_\_\_\_\_

Local use: 032 Owner or name: Red Water Indian School

Owner or name: RED WATER ISCH Address: Carthage

Ownership: County, Fed Gov't, City, Corp or Co, Private, State Agency, Water Dist E

Use of water: (A) Air cond, (B) Bottling, (C) Comm, (D) Dewater, (E) Power, (F) Fire, (G) Dom, (H) Irr, (I) Med, (J) Ind, (K) P S, (L) Rec, (M) Stock, (N) Inscit, (O) Unused, (P) Repressure, (Q) Recharge, (R) Desal-P S, (S) Desal-other, (T) Other stand by well

Use of well: (A) Anode, (B) Drain, (C) Seismic, (D) Heat Res, (E) Obs, (F) Oil-gas, (G) Recharge, (H) Test, (I) Unused, (J) Withdraw, (K) Waste, (L) Destroyed U

DATA AVAILABLE: Well data  Freq. W/L meas.:  Field aquifer char.

Hyd. lab. data: \_\_\_\_\_

Qual. water data; type: 11-16-62 MSB0H

Freq. sampling:  Pumpage inventory:  yes, no, period: \_\_\_\_\_

Aperture cards: \_\_\_\_\_ yes

Log data: Test Log to Winona Sand 312-332 D

#### WELL-DESCRIPTION CARD

SAME AS ON MASTER CARD Depth well: 136 ft Meas. rept accuracy 3

Depth cased: (first perf.) 126 ft Casing type: \_\_\_\_\_; Diam. 6 in 6

Finish: (C) porous concrete, (E) gravel w. (perf.), (G) gravel w. (screen), (H) horiz. gallery, (I) open end, (J) perf., (K) screen, (L) sd. pt., (M) shored, (N) open hole, (O) other S

Method Drilled: (A) air rot, (B) bored, (C) cable, (D) dug, (E) hyd rot., (F) jetted, (G) air percuss, (H) rotary, (I) reverse, (J) trenching, (K) driven, (L) drive wash, (M) other H

Date Drilled: 10/62 962 Pump intake setting: \_\_\_\_\_ ft \_\_\_\_\_

Driller: \_\_\_\_\_ name (L) \_\_\_\_\_ address \_\_\_\_\_

Lift (type): (A) air, (B) bucket, (C) cent. jet, (D) multiple, (E) multiple, (F) none, (G) piston, (H) rot, (I) submerg, (J) turb, (K) other S Deep  Shallow

Power (type): diesel, elec, nat gas, gasoline, hand, gas, wind; H.P. 1 T Trans. or meter no. \_\_\_\_\_

Descrip. MP \_\_\_\_\_ ft above \_\_\_\_\_ ft below LSD. Alt. MP \_\_\_\_\_

Alt. LSD: 405 Accuracy: (source) 5

Water Level 22 ft above MP; 23 ft below LSD Accuracy: D

Date meas: 062 Yield: \_\_\_\_\_ gpm 30 Method determined 61

Drawdown: \_\_\_\_\_ ft 9 Accuracy: \_\_\_\_\_ Pumping period \_\_\_\_\_ hrs \_\_\_\_\_

QUALITY OF WATER DATA: Iron 0.2 ppm Sulfate \_\_\_\_\_ ppm Chloride 2.0 ppm Hard. \_\_\_\_\_ ppm

Sp. Conduct \_\_\_\_\_ K x 10<sup>6</sup> Temp. \_\_\_\_\_ °F Date sampled \_\_\_\_\_

Taste, color, etc. iron problem

11/14/80  
 WL-22.87 JMP  
 MP- 5' above LSD  
 top of casing  
 (access hole  
 in sandstone)  
 WL-22.37 J LSD  
 405  
 22  
 383

REVIEWED AND VERIFIED  
DATE \_\_\_\_\_ BY \_\_\_\_\_

Well No.

F 9 a

Well No. F9a

Latitude-longitude N  
S  
d m s d m s

HYDROGEOLOGIC CARD

**SAME AS ON MASTER CARD** Physiographic Province: 03 Section:

D Drainage Basin: 137 Subbasin:   

Topo of well site: (D) depression, stream channel, dunes, flat, hilltop, sink, swamp, (E) (F) (H) (K) (L) (O) (P) (S) (T) (U) (V) offshore, pediment, hillside, terrace, undulating, valley flat 27

MAJOR AQUIFER: system: series: TE aquifer, formation, group: 55

Lithology: series: US Origin: 2 Aquifer Thickness: 42 - 147 ft

105 Length of well open to: 10 slot ft ft: 10 Depth to top of: 42 ft

MINOR AQUIFER: system: series: aquifer, formation, group: Aquifer Thickness: ft:

Lithology: series: Origin: Depth to top of: ft:

Intervals Screened: 126 - 136' 4"

Depth to consolidated rock: ft: Source of data: ft:

Depth to basement: ft: Source of data: ft:

Surficial material: Infiltration characteristics: ft:

Coefficient Trans: gpd/ft: Coefficient Storage: ft:

Coefficient Perm: gpd/ft<sup>2</sup>; Spec. cap: gpm/ft; Number of geologic cards: ft:

*3/72 Well on standby. UOE.  
 School now uses city of Carthage water.*

*Test hole to Winina @ 332*

*(pumping level 32 1/2 feet)*

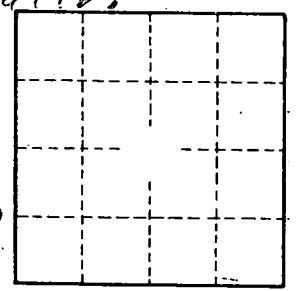
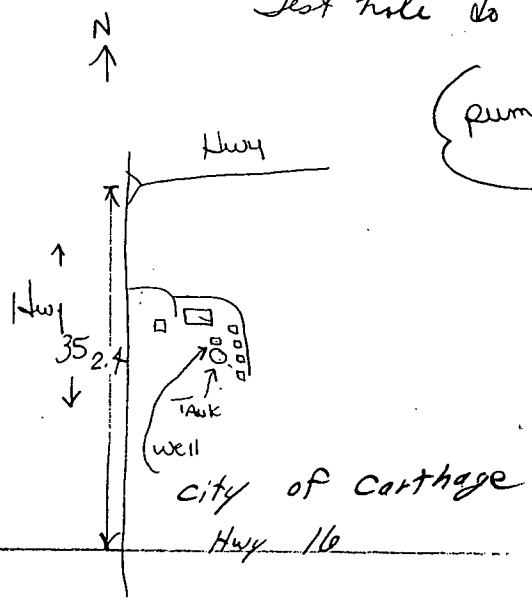

Well No.

F9a