

WRD Exp. (GW)
April 1966

ID 325154089400301

Well No. A6

WELL SCHEDULE

E Log # 16

U. S. DEPT. OF THE INTERIOR

GEOLOGICAL SURVEY

WATER RESOURCES DIVISION

PRODUCED AND VERIFIED
BY THE QUALIFICATION BRANCH

6/20/95
65.55

MASTER CARD

Record by C. Jessup Source of data MSG5 Date 8-16-66 Map 11

State Missouri County 28 (or town) Leake MO 40

Latitude: 32° 51' 56" N Longitude: 089° 40' 03" W Sequential number: 1

Lat-long accuracy: 2 T. 120 S. R. 60 Sec 27 SW 1/4, NE 1/4

Local well number: A006CA2712N06E Other number: _____ B & M

Local use: 064016 869 11 Owner or name: Town of Thomastown

Owner or name: THOMASTOWN Address: _____

Ownership: County, Fed Gov't, City, Corp or Co, Private, State Agency, Water Dist N

Use of water: (A) Air cond, (B) Bottling, (C) Comm, (D) Dewater, (E) Power, (F) Fire, (G) Dom, (H) Irr, (I) Med, (J) Ind, (K) P S, (L) Rec, (M) Stock, (N) Insitit, (O) Unused, (P) Repressure, (Q) Recharge, (R) Desal-P S, (S) Desal-other, (T) Other P

Use of well: (A) Anode, (B) Drain, (C) Seismic, (D) Heat Res, (E) Obs, (F) Oil-gas, (G) Recharge, (H) Test, (I) Unused, (J) Withdraw, (K) Waste, (L) Destroyed W

DATA AVAILABLE: Well data 0 Freq. W/L meas.: 0 Field aquifer char. Z

Hyd. lab. data: _____

Qual. water data; type: MSB04 USGS -3-18-70

Freq. sampling: _____ Pumpage inventory: _____

Aperture cards: _____

Log data: E log 10-1608 ft. Samples (see) D-E

WELL-DESCRIPTION CARD

SAME AS ON MASTER CARD Depth well: 251 ft Meas. rept 2:4:6 accuracy 3

Depth cased: (first perf.) 206 ft Casing type: steel Diam. 8x6 in 8

Finish: porous concrete, gravel w. concrete, (perf.), gravel w. (screen), horiz. gallery, end, open perf., screen, sd. pt., shored, open hole, other S

Method drilled: (A) air rot, (B) bored, (C) cable, (D) dug, (E) hyd rot, (F) jetted, (G) air percussion, (H) rotary, (I) reverse trenching, (J) driven, (K) drive wash, (L) other H

Date drilled: 7-29-66 Pump intake setting: 9:6 ft 36 38

Driller: Layne - Central Co. Jackson Miss

Lift (type): (A) air, (B) bucket, (C) cent, (D) jet, (E) multiple, (F) multiple, (G) none, (H) piston, (I) rot, (J) submerg, (K) turb, (L) other M Deep 39 Shallow 40

Power (type): (A) diesel, (B) elec, (C) gas, (D) gasoline, (E) hand, (F) gas, (G) wind, (H) H.P. 15 Trans. or meter no. U

Descrip. MP Breather hole - pump base 2± ft above LSD Alt. MP _____

Alt. LSD: 400 T. (G.L.) 400 Accuracy: (source) 4

Water Level: _____ ft above MP; _____ ft below LSD Accuracy: 64

Date meas: 8:69 Yield: _____ gpm 150 Method determined 1

Drawdown: _____ ft Accuracy: _____ Pumping period: _____ hrs 1

QUALITY OF WATER DATA: Iron 2 Sulfate 2 Chloride 0 Hard. 0

Sp. Conduct 60 K x 10⁶ Temp. 19 °C °F Date sampled 370

Taste, color, etc. pH = 5.2 Cl = 7 = Fe 0.5 total solids = 18 SO₄ = 13

12/17/80
70
3.0
- 67.0
MP 2
65.0
400
65
335

Well No.

A6

Well No. A 6

Latitude-longitude N
S
d m s d m s

HYDROGEOLOGIC CARD

SAME AS ON MASTER CARD Physiographic Province: _____ Section: 03

D Drainage Basin: 137 Subbasin: _____

Topo of well site: (D) depression, stream channel, dunes, flat, hilltop, sink, swamp, (P) offshore, pediment, hillside, terrace, undulating, valley flat 27

MAJOR AQUIFER: T.E aquifer, formation, group: S.S

Lithology: U.S Origin: 2 Aquifer Thickness: 125 ft

160 Length of well open to: _____ ft Depth to top of: 40 ft e-log: _____ ft 206

MINOR AQUIFER: _____ aquifer, formation, group: _____

Lithology: _____ Origin: _____ Aquifer Thickness: _____ ft

206-246 Intervals Screened: 6" x 40' 55

Depth to consolidated rock: _____ ft Source of data: _____

Depth to basement: _____ ft Source of data: _____

Surficial material: _____ Infiltration characteristics: _____

Coefficient Trans: 65000 gpd/ft Coefficient Storage: 653

Coefficient Perm: 400 gpd/ft²; Spec cap: 10.6 gpm/ft; Number of geologic cards: _____

Run 1 10-520 ft
 8.4.66 Run 2 12-805 ft
 8.26.66 Run 3 10-1608 ft
 MBOWL HAS DRILLERS LOG.

Top lower water just below this log

Storage 4,500 gal Hydro Pneumatic
 Treatment Coke tray Aerator Lime feeder
 Chlorination
 98 Consumes

D66 - 64 FT (GL)
 869 - 64 FT (GL)

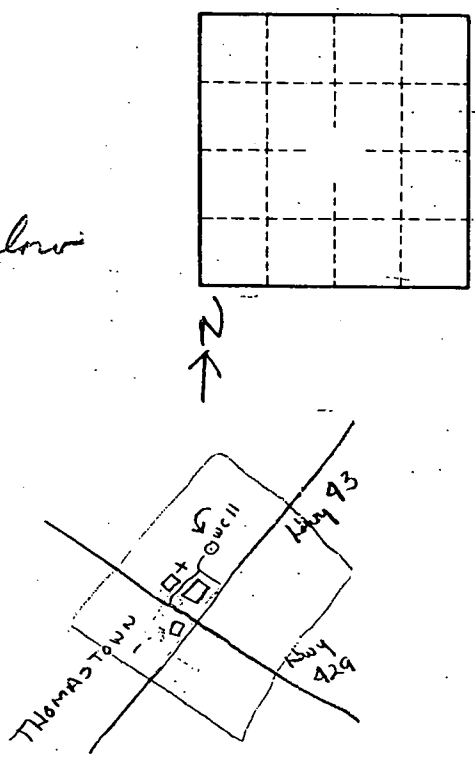

Well No. A 6