

WELL SCHEDULE

U. S. DEPT. OF THE INTERIOR

GEOLOGICAL SURVEY

WATER RESOURCES DIVISION

PUNCHED and VERIFIED
ROLLA COMPUTATION BRANCH

MASTER CARD

Record by J. A. Callahan Source of data Mr. Summer Date 6-7-66 Map

State Miss 28 County Lawrence 39
(or town)

Latitude: 31° 30' 38" N Longitude: 090° 07' 48" W Sequential number: 1
deg min sec 12 degrees 15 min sec 18

Lat-long accuracy: 3 T. 6 S. R. 11 W. Sec 5, SE 1/4, SE 1/4, 19

Local well number: K00200506N11E Other number: B & M

Local use: BETHEL CHURCH Owner or name: Bethel Church

Owner or name: BETHEL CHURCH Address: Monticello

Ownership: County, Fed Gov't, City, Corp or Co, Private, State Agency, Water Dist P

Use of water: (A) Air cond, Bottling, Comm, Dewater, Power, Fire, Dom, Irr, Med, Ind, P S, Rec, (H) H

Use of well: (A) Anode, Drain, Seismic, Heat Res, Obs, Oil-gas, Recharge, Test, Unused, Withdraw, Waste, Destroyed. W

DATA AVAILABLE: Well data N Freq. W/L meas.: N Field aquifer char. 72

Hyd. lab. data: 73

Qual. water data; type: 74

Freq. sampling: 75 Pumpage inventory: yes no, period: 76

Aperture cards: yes 77

Log data: 78 79

WELL-DESCRIPTION CARD

SAME AS ON MASTER CARD Depth well: 684 ft 684 Meas. accuracy 24 G

Depth cased; (first perf.) ft 23 28 Casing Type: 2 in 2 Diam. 29 30

Finish: (C) porous concrete, (F) gravel w. (perf.), (G) gravel w. (screen), (H) horiz. gallery, (I) open end, (P) perf., (S) screen, (T) sd. pt., (W) shored, (X) open hole, (Z) other 31

Method Drilled: (A) air rot, (B) bored, (C) cable, (D) dug, (H) hyd. rot., (J) jetted, (P) air percussion, (R) reverse, (T) trenching, (V) driven, (W) drive wash, (Z) other 32 H

Date Drilled: ? Pump intake setting: 33 35 ft 36 38

Driller: McLain Hud, Monticello

Lift (type): A (A) air, (B) bucket, (C) cent, (J) jet, (L) multiple, (M) multiple, (N) none, (P) piston, (R) rot, (S) submerg, (T) turb, (Z) other 39 A Deep 40 Shallow

Power (type): 5 (nat) diesel, (lec) gas, gasoline, hand, gas, wind; H.P. 5 Trans. or meter no. 41

Descrip. MP 5 above ft below LSD, Alt. MP 47

Alt. LSD: 42 43 Accuracy: (source) 47

Water Level: 48 51 ft above below MP; Ft below LSD Accuracy: 52

Date meas: 53 55 Yield: 50 60 gpm Method determined 61

Drawdown: 62 64 ft Accuracy: 65 Pumping period 66 68 hrs

QUALITY OF WATER DATA: Iron 69 ppm Sulfate 70 ppm Chloride 71 ppm Hard. 72 ppm

Sp. Conduct 73 K x 10⁶ Temp. 74 76 °F Date sampled 77 79

Taste, color, etc. 79

Well No. K2

Well No. K2

Latitude-longitude N
S
d m s d m s

HYDROGEOLOGIC CARD

SAME AS ON MASTER CARD Physiographic Province: 03 Section: _____

D Drainage Basin: 13V Subbasin: _____

Topo of well site: (D) depression, stream channel, dunes, flat, hilltop, sink, swamp, (P) offshore, pediment, hillside, terrace, undulating, valley flat (H) H

MAJOR AQUIFER: TM series _____ aquifer, formation, group MZ

Lithology: US Origin: 3 Aquifer Thickness: _____ ft

Length of well open to: _____ ft Depth to top of: _____ ft

MINOR AQUIFER: _____ series _____ aquifer, formation, group _____

Lithology: _____ Origin: _____ Aquifer Thickness: _____ ft

Length of well open to: _____ ft Depth to top of: _____ ft

Intervals Screened: _____

Depth to consolidated rock: _____ ft Source of data: _____

Depth to basement: _____ ft Source of data: _____

Surficial material: _____ Infiltration characteristics: _____

Coefficient Trans: _____ gpd/ft Coefficient Storage: _____

Coefficient Perm: _____ gpd/ft²; Spec cap: _____ gpm/ft; Number of geologic cards: _____

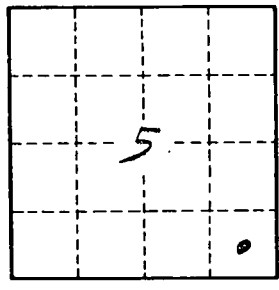
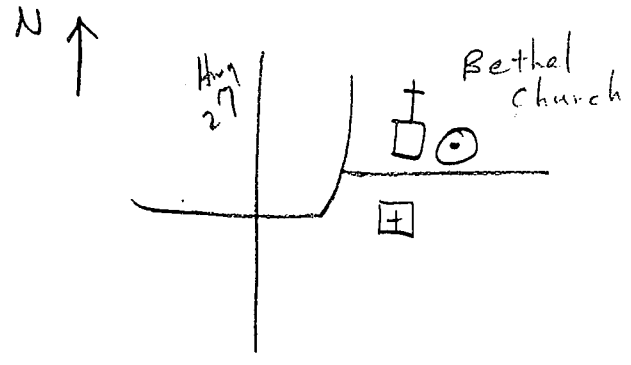

Well No.

K2