

WRD Exp. (GW)
April 1966

Well No. H4

WELL SCHEDULE

U. S. DEPT. OF THE INTERIOR

GEOLOGICAL SURVEY

WATER RESOURCES DIVISION

MASTER CARD

PUNCHED and VERIFIED
FOLLOWS COMPUTATION BRANCH

Record by J. A. Callahan Source of data _____ Date 6-14-66 Map _____

State Miss County (or town) Lawrence

Latitude: 31° 34' 44" N Longitude: 090° 22' 29" W Sequential number: 1

Lat-long accuracy: 3 T. 70 S, R. 20 E, W Sec 17, NW, NW

Local well number: H0048B1707N20W Other number: _____

Local use: _____ Owner or name: Roscoe Hooker

Owner or name: ROSCOE HOOKER Address: Rt 1 Silver Creek Box 232

Ownership: County, Fed Gov't, City, Corp or Co, Private, State Agency, Water Dist P

Use of water: (A) Air cond, Bottling, Comm, Dewater, Power, Fire, Irr, Med, Ind, P S, Rec, (B) Stock, (C) Instit, (D) Unused, (E) Reppure, (F) Recharge, (G) Desal-P S, (H) Desal-other, (I) Other H

Use of well: (A) Anode, (B) Drain, (C) Seismic, (D) Heat Res, (E) Obs, (F) Oil-gas, (G) Recharge, (H) Test, (I) Unused, (J) Withdraw, (K) Waste, (L) Destroyed. W

DATA AVAILABLE: Well data Freq. W/L meas.: Field aquifer char.

Hyd. lab. data: _____

Qual. water data; type: _____

Freq. sampling: _____ Pumpage inventory: yes, no, period: _____

Aperture cards: _____

Log data: _____

WELL-DESCRIPTION CARD

SAME AS ON MASTER CARD Depth well: 99 ft Meas. accuracy 6

Depth cased: _____ Casing type: _____ Diam. 2 in

Finish: (C) porous concrete, (F) gravel w. (perf.), (G) gravel w. (screen), (H) horiz. gallery, (I) open end, (J) other H

Method Drilled: (A) air rot, (B) bored, (C) cable, (D) dug, (E) hyd, (F) jetted, (G) air percussion, (H) reverse, (I) rotary, (J) other H

Date Drilled: June 1962 Pump intake setting: _____ ft

Driller: C.C. Rouse Columbia

Lift (type): (A) air, (B) bucket, (C) cent, (D) multiple, (E) multiple, (F) none, (G) piston, (H) rot, (I) submerg, (J) turb, (K) other J Deep Shallow

Power (type): diesel, elec, gas, gasoline, hand, gas, wind; H.P. 5 Trans. or meter no. _____

Descrip. MP _____ ft above, _____ ft below LSD, Alt. MP _____

Alt. LSD: _____ Accuracy: _____

Water Level: 24 ft above MP; 24 ft below LSD Accuracy: _____

Date meas: June 1962 Yield: _____ gpm Method determined _____

Drawdown: _____ ft Accuracy: _____ Pumping period _____ hrs

QUALITY OF WATER DATA: Iron _____ ppm Sulfate _____ ppm Chloride _____ ppm Hard. _____ ppm

Sp. Conduct _____ K x 10⁶ Temp. _____ °F Date sampled _____

Taste, color, etc. iron stain

Well No. H4

Well No. H4

Latitude-longitude N
S
d m s d m s

HYDROGEOLOGIC CARD

SAME AS ON MASTER CARD Physiographic Province: 03 Section: _____

D Drainage Basin: 1131V Subbasin: _____

Topo of well site: (D) depression, (C) stream channel, (E) dunes, (F) flat, (H) hilltop, (K) sink, (L) swamp, (S) offshore, pediment, hillside, terrace, undulating, valley flat 5

MAJOR AQUIFER: system _____ series TM aquifer, formation, group MZ

Lithology: US Origin: 3 Aquifer Thickness: _____ ft
Length of well open to: _____ ft Depth to top of: _____ ft

MINOR AQUIFER: system _____ series _____ aquifer, formation, group _____

Lithology: _____ Origin: _____ Aquifer Thickness: _____ ft
Length of well open to: _____ ft Depth to top of: _____ ft

Intervals Screened: _____

Depth to consolidated rock: _____ ft Source of data: _____

Depth to basement: _____ ft Source of data: _____

Surficial material: _____ Infiltration characteristics: _____

Coefficient Trans: _____ gpd/ft Coefficient Storage: _____

Coefficient Perm: _____ gpd/ft²; Spec cap: _____ gpm/ft; Number of geologic cards: _____

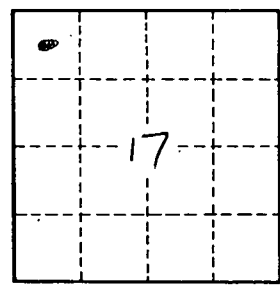
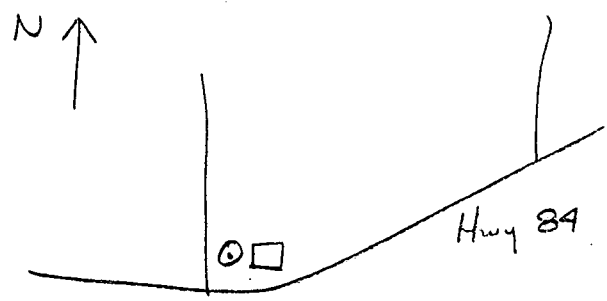

Well No. H4