

6/78 WTO

TRANSMITTED FOR ADP

Recorded by WTO

U.S. GEOLOGICAL SURVEY  
WATER RESOURCES DIVISION  
MISSISSIPPI DISTRICT  
WELL RECORD

Well No. 632

Date 6/5/79

E-Log No. \_\_\_\_\_

County LAWRENCE

Site ID 313343090051401 R=0\* T=A\* 2=W\*

Data reliab. 3=U\*<sup>C</sup> Report. agency 4=USGS\* Dist. 6=28\* 7=28\* Co. 8=077\*

Lat. \_\_\_\_\_ Long. 9=313343\* 10=0900514\* Well No. 12=5032\*

Location 13=NE NW, S 23, T 07 N, R 21 W\* Alt. 16=190.\* <sup>195 SSU</sup>

Hyd. Unit (OWDC) 20= \_\_\_\_\_ Date 21=05/13/1979\*

Well use 23=W\* Water Use 24=Z\* Hole depth 27=315.\* Well depth 28=315.\*

WL 30=-6.\* Date 31=11/10/1981\* Source 33= \_\_\_\_\_\*

Status 273= \_\_\_\_\_\* Project No. 5= \_\_\_\_\_\*

R=158\* T=A\* Date 159#05/13/1979\* Owner No. Oil well supply

Owner 161=INEXCO OIL CO\*

R=192\* T=A\* Date 193# \_\_\_\_\_\* Temp. 196#00010\* 197= \_\_\_\_\_\*

R=192\* T=A\* Date 193# \_\_\_\_\_\* Cond. 196#00095\* 197= \_\_\_\_\_\*

R=192\* T=A\* Date 193# \_\_\_\_\_\* pH 196#00400\* 197= \_\_\_\_\_\*

R=58\* T=A\* 59#1\* Date 60=05/13/1979\* Remarks \_\_\_\_\_

Drig. 63=184\* Name Griner Drig Method 65=H\* Finish 66=X\*

R=76\* T=A\* 59#1\* Top csng. 77# 0.\* Bot. csng. 78=294.\* Diam. 79# 3.\*

R=76\* T=A\* 59#1\* Top csng 77# \_\_\_\_\_\* Bot. csng. 78= \_\_\_\_\_\* Diam. 79# \_\_\_\_\_\*

R=82\* T=A\* 59#1\* Top 83# 294.\* Bottom 84=315.\*

Type 85=X\* Diam. 87=3.\* Size 88= \_\_\_\_\_\*

R=82\* T=A\* 59#1\* Top 83# \_\_\_\_\_\* Bottom 84= \_\_\_\_\_\*

Type 85= \_\_\_\_\_\* Diam. 87= \_\_\_\_\_\* Size 88= \_\_\_\_\_\*

*est 20 gpm flow 11/10/79*

R=134\* T=A\* 147#1\* Q 150=90.\* Q/S 272= \_\_\_\_\_\*

134 flows 146 pumped

R=42\* T= A \* Lift type 43# \* Intake 44= \* Power type 45= \*

Date 38= / / H.P. 46= \*

LIFT

R=198\* T= A \* Log 199# D \* Top 200= 0. \* Bot 201= 315. \*

R=198\* T= A \* Log 199# \* Top 200= \* Bot 201= \*

R=189\* T= A \* E Log No. 190# \* 191= M I S S D I S T \*

LOGS

R=114\* T= A \* Year 115# \* Type 120= \*

ANAL.

R=90\* T= A \* 256# 1 \* Top 91= 210. \* Bot 92= 315. \*

Unit ID 93= 122 MOCN \* Name of Unit

R=90\* T= A \* 256# 1 \* Top 91= \* Bot 92= \*

Unit ID 93= \* Name of Unit

AQUIFERS

R=98\* T= A \* 99# 1 \* Unit tested 100= \* 103= \*

R=105\* T= A \* 99# 1 \* Test No. 106# \*

107= \* Transmissivity (gal/d)/ft

108= \* Hydraul. cond. (gal/d)/ft<sup>2</sup>

110= \* Storage coeff. Boundaries

HYDRAULICS

R=121\* T= \* Yr Begin 122# \* Network 258= \*

Water Level Data Collection (1)

(1500'S + 2200'E of NW Cor)

well Flows

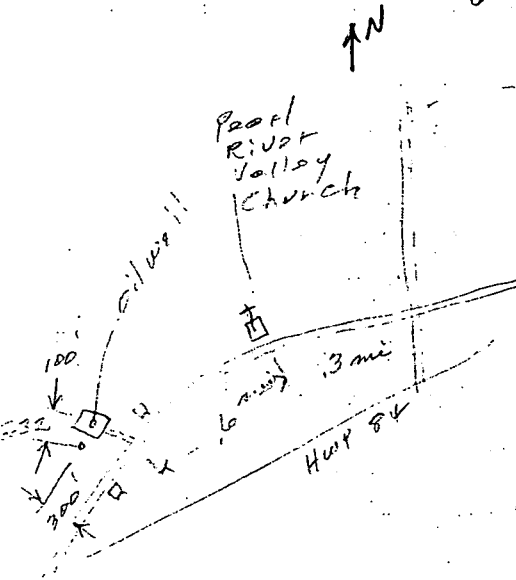

| description of formations encountered | from | to  |
|---------------------------------------|------|-----|
| clay + sand                           | 0    | 105 |
| clay                                  | 105  | 168 |
| clay + sand                           | 168  | 210 |
| sand with pea gravel                  | 210  | 315 |