

WRD Exp. (GW)  
April 1966

Well No. G 2

RECEIVED  
APR 22 1975

TRANSMITTED FOR ADP

# WELL SCHEDULE REPLACEMENT

U. S. DEPT. OF THE INTERIOR

GEOLOGICAL SURVEY

WATER RESOURCES DIVISION

## MASTER CARD

Record by W.T. Oakley Source of data EM. Graham Mayor Date 8-18-65 Map County

State Miss County (or town) Lawrence

Latitude: 31° 33' 10" N Longitude: 090° 06' 20" W Sequential number: 1

Lat-long accuracy: 2' T. 70 R. 11 Sec 28 NW 1/4, NW 1/4

Local well number: G0026B2807N11E Other number: Old well #2

Local use: 064 767 Owner or name: Monticello (Town of)

Owner or name: MONTICELLO Address: Monticello, Miss

Ownership: County, Fed Gov't, City, Corp or Co, Private, State Agency, Water Dist M

Use of water: (A) Air cond, Bottling, Comm, Dewater, Power, Fire, Dom, Irr, Med, Ind, P S, Rec, (P) Rec

Use of well: (A) Anode, Drain, Seismic, Heat Res, Obs, Oil-gas, Recharge, Test, Unused, Withdraw, Waste, Destroyed W

DATA AVAILABLE: Well data  Freq. W/L meas.: None Field aquifer char. Z

Hyd. lab. data:

Qual. water data; type: Complete Chemical Analysis

Freq. sampling: Original Pumpage inventory: no period:

Aperture cards:

Log data:

## WELL-DESCRIPTION CARD

SAME AS ON MASTER CARD Depth well: 895 ft Meas. 895 Meas. rept accuracy 6

Depth cased: 835 ft Casing type: 835 Diam. 10-6 in

Finish: (C) porous concrete, (F) gravel w. (perf.), (G) gravel w. (screen), (H) horiz. gallery, (P) open perf., (S) screen, (T) sd. pt., (W) shored, (X) open hole, (Z) other S

Method Drilled: (A) air rot, (B) bored, (C) cable, (D) dug, (H) hyd rot, (J) jetted, (P) air percussion, (R) reverse, (T) trenching, (V) driven, (W) drive wash, (Z) other H

Date Drilled: Nov. 1949 Pump intake setting: 949 ft

Driller: Layne Central, Jackson, Miss

Lift (type): (A) air, (B) bucket, (C) cent, (J) multiple, (L) multiple, (M) multiple, (N) none, (P) piston, (R) rot, (S) submerg, (T) turb, (Z) other T Deep D

Power (type): elec nat LP 15 Trans. or meter no. U

Descrip. MP top of 8" casing at 0.2' ft below LSD Alt. MP 117.15

Alt. LSD: 240 Accuracy: 198 (source) 11/4/51

Water Level: 116.95 ft above below MP; Ft below LSD 18 Accuracy: 150

Date meas: 11/7/51 Yield: 150 gpm Method determined 1

Drawdown: 198 ft Accuracy: 117 Pumping period 8 hrs

QUALITY OF WATER DATA: Iron 0.04 Sulfate 3.0 Chloride 2.1 Hard. 0

Sp. Conduct 254 K x 10<sup>6</sup> Temp. 76 °F Date sampled 8-16-66

Taste, color, etc. Field sp. cond. was 270

11/6/81  
12.5  
71.95  
117.15  
116.95  
198  
117  
81

Well No. G 2

Well No. G2

Latitude-longitude \_\_\_\_\_  
N S  
d m s d m s

**HYDROGEOLOGIC CARD**

SAME AS ON MASTER CARD  
Physiographic Province: Coastal Plain 03 Section: East Gulf Coastal

Plain 13V Drainage Basin: \_\_\_\_\_ Subbasin: \_\_\_\_\_

Topo of well site: (D) depression, stream channel, dunes, flat, hilltop, sink, swamp, (E) (F) (H) (K) (L) (M) (N) (O) (P) (S) (T) (U) (V) offshore, pediment, hillside, terrace, undulating, valley flat T

MAJOR AQUIFER: Tertiary, Miocene T.M Catahoula ss C.A  
system series aquifer, formation, group

Lithology: unconsolidated sands U.S Origin: Deltaic 3 Aquifer Thickness: \_\_\_\_\_ ft

Length of well open to: \_\_\_\_\_ ft 50 Depth to top of: \_\_\_\_\_ ft 60

MINOR AQUIFER: \_\_\_\_\_ system \_\_\_\_\_ series \_\_\_\_\_ aquifer, formation, group

Lithology: \_\_\_\_\_ Origin: \_\_\_\_\_ Aquifer Thickness: \_\_\_\_\_ ft

Length of well open to: \_\_\_\_\_ ft \_\_\_\_\_ Depth to top of: \_\_\_\_\_ ft \_\_\_\_\_

Intervals Screened: 825-875 6" screen

Depth to consolidated rock: \_\_\_\_\_ ft \_\_\_\_\_ Source of data: \_\_\_\_\_

Depth to basement: \_\_\_\_\_ ft \_\_\_\_\_ Source of data: \_\_\_\_\_

Surficial material: \_\_\_\_\_ Infiltration characteristics: \_\_\_\_\_

Coefficient Trans: \_\_\_\_\_ gpd/ft 472 Coefficient Storage: \_\_\_\_\_

Coefficient Perm: 94 gpd/ft<sup>2</sup>; Spec cap: \_\_\_\_\_ gpm/ft; Number of geologic cards: \_\_\_\_\_

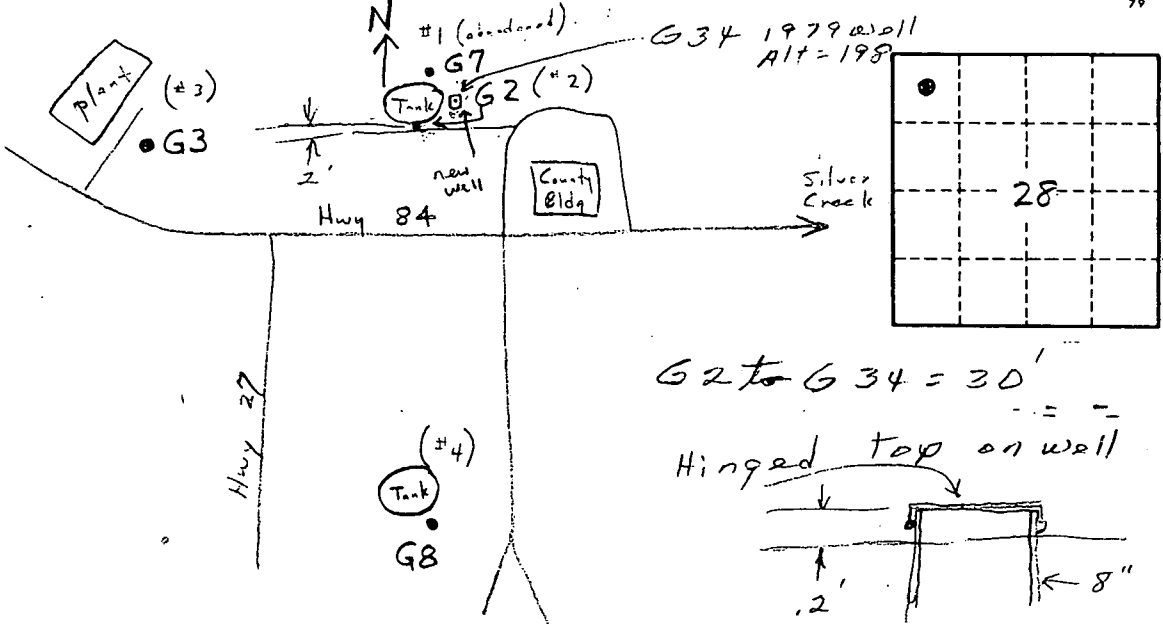

5/14/96  
WL 34.8