

WRD Exp. (GW)
April 1966

Well No. D 15 ✓

WELL SCHEDULE

U. S. DEPT. OF THE INTERIOR

GEOLOGICAL SURVEY

WATER RESOURCES DIVISION

PUNCHED AND VERIFIED
WATER RESOURCES DIVISION BRANCH

MASTER CARD

Record by: J. A. Callahan Source of data: owner Date: 10-19-67 Map: Lauderdale
 State: Miss County (or town): Lauderdale Sequential number: 38
 Latitude: 32° 31' 22" N Longitude: 088° 30' 58" W
 Lat-long accuracy: 3 T. 8 S. R. 17 W. Sec 24, SE 1/4, NW 1/4
 Local well number: D 0 1 5 D B 2 4 0 1 N 1 7 E Other number: _____
 Local use: 055 067 25 Owner or name: J. D. Clark & son
 Owner or name: J. D. CLARK & SON Address: Lauderdale, Miss
 Ownership: County, Fed Gov't, City, Corp or Co, Private, State Agency, Water Dist F
 Use of Air cond, Bottling, Comm, Dewater, Power, Fire, Dom, Irr, Med, Ind, P S, Rec, water: _____
 Use of (S) (T) (U) (V) (W) (X) (Y) (Z) Stock, Instic, Unused, Repressure, Recharge, Desal-P S, Desal-other, Other U
 Use of (A) (D) (G) (H) (I) (P) (R) (T) (U) (W) (X) (Z) well: Anode, Drain, Seismic, Heat Res, Obs, Oil-gas, Recharge, Test, Unused, Withdraw, Waste, Destroyed U
 DATA AVAILABLE: Well data Y Freq. W/L meas.: _____ Field aquifer char. Y
 Hyd. lab. data: _____
 Qual. water data; type: _____
 Freq. sampling: _____ Pumpage inventory: _____ yes _____ no, period: _____
 Aperture cards: _____ yes _____
 Log data: _____

WELL-DESCRIPTION CARD

SAME AS ON MASTER CARD Depth well: 156 ft Meas. rept. accuracy 6
 Depth cased: _____ ft Casing type: _____; Diam. _____
 Finish: (C) porous concrete, (F) gravel w. (G) gravel w. (H) horiz. (I) open (P) perf., (S) screen, (T) sd. pt., (W) shored, (X) open hole, (Z) other S
 Method: (A) air rot, (B) bored, (C) auger, (D) dug, (H) jetted, (J) air reverse, (P) percussive, (R) rotary, (T) trenching, (U) driven, (V) drive wash, (W) other U
 Date Drilled: _____ Pump intake setting: _____ ft
 Driller: _____ name _____ address _____
 Lift (type): (A) air, (B) bucket, (C) cent. jet, (J) multiple, (L) multiple, (M) multiple, (N) none, (P) piston, (R) rot, (S) submerg, (T) turb, (Z) other J Deep U Shallow U
 Power (type): (A) diesel, (B) elec, (C) gas, (D) gasoline, (E) hand, (F) gas, (G) wind, (H) H.P. U Trans. or meter no. _____
 Descrip. MP _____ above _____ ft below LSD. Alt. MP _____
 Alt. LSD: 820 Accuracy: 100
 Water Level: 10 ft above MP; 12 ft below LSD Accuracy: rest
 Date meas: 12-19-65 Yield: 75 gpm Method determined U
 Drawdown: _____ ft Accuracy: _____ Pumping period: 9 min. hrs _____
 QUALITY OF WATER DATA: Iron _____ ppm Sulfate _____ ppm Chloride _____ ppm Hard. _____ ppm
 Sp. Conduct K x 10⁶ _____ Temp. _____ °F Date sampled _____
 Taste, color, etc. High iron iron.

Well No. D 15

Well No. D15

Latitude-longitude N
S
d m s d m s

HYDROGEOLOGIC CARD

SAME AS ON MASTER CARD Physiographic Province: 03 Section: _____

Drainage Basin: D 13K Subbasin: _____

Topo of well site: (D) depression, stream channel, dunes, flat, hilltop, sink, swamp, (C) _____, (E) _____, (F) _____, (H) _____, (K) _____, (L) _____, (P) _____, (S) _____, (T) _____, (U) _____, (V) valley flat

MAJOR AQUIFER: Tertiary system, Eocene series, TE aquifer, formation, group, LW

Lithology: Sand U.S. Origin: 2 Aquifer Thickness: 20 (est) ft

Length of well open to: 20 ft Depth to top of: _____ ft

MINOR AQUIFER: _____ system, _____ series, _____ aquifer, formation, group

Lithology: _____ U.S. Origin: _____ Aquifer Thickness: _____ ft

Length of well open to: _____ ft Depth to top of: _____ ft

Intervals Screened: _____

Depth to consolidated rock: _____ ft Source of data: _____

Depth to basement: _____ ft Source of data: _____

Surficial material: _____ Infiltration characteristics: _____

Coefficient Trans: 7,000 gpd/ft 702 Coefficient Storage: .001 104

Coefficient Perm: _____ gpd/ft²; Spec cap: 2.5 gpm/ft; Number of geologic cards: _____

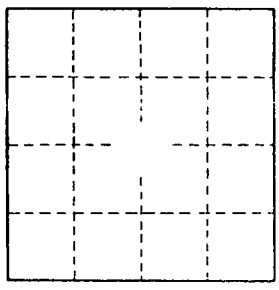
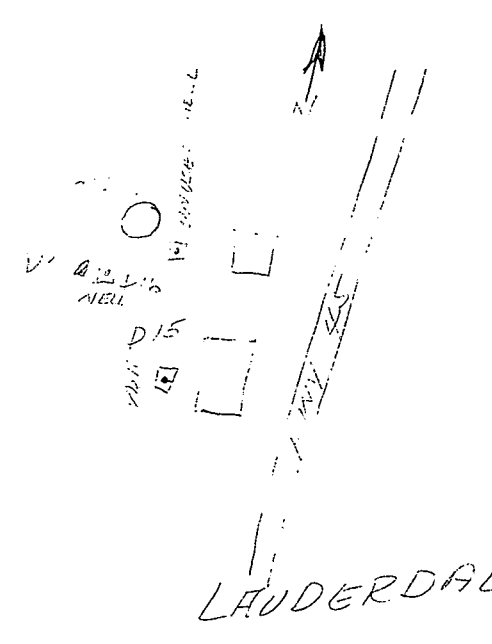

Well No. D15