

6/78 WTO

Recorded by P.D.
Date 9-29-80

U.S. GEOLOGICAL SURVEY
WATER RESOURCES DIVISION
MISSISSIPPI DISTRICT
WELL RECORD

Well No. A-36
E-Log No. 86
County HANCOCK
TRANSMITTED FOR ADP

Site ID 3.0.3.3.5.0.0.8.9.2.6.3.8.0.1 R=0* T=A* 2=W*

Data reliab. 3=C* Report. agency 4=USGS* Dist. 6=28* 7=28* Co. 8=045*

Lat. 9=3.0.3.3.5.0* 10=0.8.9.2.6.3.8* Well No. 12=A036*

Location 13=SESE S 35 T 05 S R 15 W* Alt. 16=135.*

Hyd. Unit (OWDC) 20= * Date 21=08.1.15.1.19.80*

Well use 23=W* Water Use 24=P* Hole depth 27=1231.* Well depth 28=1197.*

WL 30=62.* Date 31=12.1.15.1.19.80* Source 33=S*

Status 273= * Project No. 5= *

GEN. SITE DATA

OWNER

R=158* T=A* Date 159#12.1.15.1.19.80* Owner No. TALMAR INC

Owner 161#WHITE CYPRESS LK EST*

FIELD QW

R=192* T=A* Date 193#01.12.19.81* Temp. 196#00010* 197=29.5*

R=192* T=A* Date 193# / / * Cond. 196#00095* 197=

R=192* T=A* Date 193#01.12.19.81* pH 196#00400* 197=8.4*

CONSTR.

R=58* T=A* 59#1* Date 60=12.1.15.1.19.80* Remarks

Drlg. 63=184.* Name GRINER DRILLING METHOD 65=H* Finish 66=S*
SERVICE

CASING

R=76* T=A* 59#1*

Top csng. 77# 0.* Bot. csng. 78=1137.* Diam. 79# 8.*

R=76* T=A* 59#1*

Top csng 77# 1090.* Bot. csng. 78=1147.* Diam. 79# 6.*

OPENINGS

R=82* T=A* 59#1* Top 83# 1147.* Bottom 84=1197.*

Type 85=S* Diam. 87=6.* Size 88= *

R=82* T=A* 59#1* Top 83# * Bottom 84= *

Type 85= * Diam. 87= * Size 88= *

YIELD

R=146* T=A* 147# 1* Q 150=205.* Q/S 272= *

134 flows 146 pumped

LIFT

R=42* T= A * Lift type 43# T* Intake 44= * Power type 45= E*

Date 38= 12/15/1980* H.P. 46= 15.*

LOGS

R=198* T= A * Log 199# E* Top 200= 10.* Bot 201= 1231.*

R=198* T= A * Log 199# D* Top 200= 0.* Bot 201= 1227.*

R=189* T= A * E Log No. 190# 0.86* 191= M I S S D I S T *

ANAL.

R=114* T= A * Year 115# * Type 120= *

AQUIFERS

R=90* T= A * 256# 1 * Top 91= 1120.* Bot 92= 1220.*

Unit ID 93= 122 MOCN * Name of Unit

R=90* T= A * 256# 1 * Top 91= * Bot 92= *

Unit ID 93= * Name of Unit

R=98* T= A * 99# 1 * Unit tested 100= * 103= *

R=105* T= A * 99# 1 * Test No. 106# *

107= * Transmissivity (gal/d)/ft

108= * Hydraulic cond. (gal/d)/ft²

110= * Storage coeff. Boundaries

R=121* T= * Yr Begin 122# * Network 258= *

Water Level Data Collection (1)

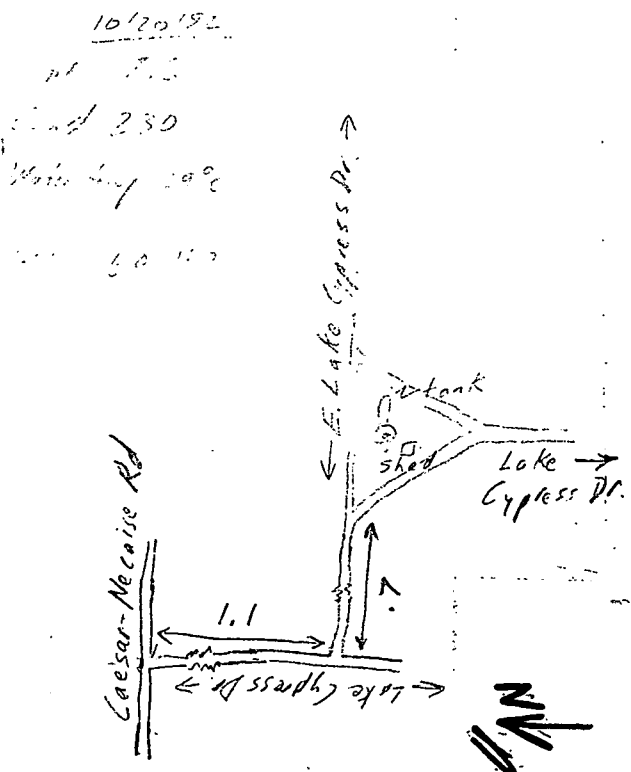

description of formations encountered	from	to
Top soil	0	3
SAND	3	25
CLAY	25	190
SAND & CLAY STRATIFIED	190	240
CLAY	240	250
SAND	250	252
CLAY	252	252
SAND & CLAY STRATIFIED	252	335
SAND	335	433
CLAY	433	633
SAND	633	704
CLAY & MUD CLS	704	764
SAND	764	1016
CLAY	1016	1177
SAND	1177	1221
CLAY	1221	1221

11/13/85 JMK
70 ft
450
65.5
2.9
62.6

Heath 230051-01
#