

WRD Exp. (GW)
April 1966

REPLACEMENT

Well No. N 22

WELL SCHEDULE

U. S. DEPT. OF THE INTERIOR

GEOLOGICAL SURVEY

WATER RESOURCES DIVISION

PUNCHED and VERIFIED
ROLLA COMPUTATION CENTER

MASTER CARD

Record by H.B. Harris Source of data H.W. Patch Date 10-6-61 Map County

State Miss County (or town) Lamar 28 3:7

Latitude: 31° 02' 14" N Longitude: 089° 29' 52" W Sequential number: 1

Lat-long accuracy: 2' T. 1 S. R. 15 Sec 22, NW 1/4, NW 1/4, NW 1/4

Local well number: N 022 B B 220 / N 15 W Other number: N22-1 B & M

Local use: X O Owner or name: H.W. Patch

Owner or name: H W PATCH Address: Lumberton Rt

Ownership: County, Fed Gov't, City, Corp or Co, Private, State Agency, Water Dist P

Use of water: (A) Air cond, (B) Bottling, (C) Comm, (D) Dewater, (E) Power, (F) Fire, (G) Irr, (H) Med, (I) Ind, (M) P S, (N) Rec, (P) Stock, (S) Instit, (T) Unused, (U) Repressure, (V) Recharge, (W) Desal-P S, (X) Desal-other, (Y) Other H

Use of well: (A) Anode, (D) Drain, (G) Seismic, (H) Heat Res, (I) Obs, (M) Oil-gas, (N) Recharge, (P) Test, (R) Unused, (T) Withdraw, (U) Waste, (W) Destroyed W

DATA AVAILABLE: Well data Freq. W/L meas.: none Field aquifer char. N

Hyd. lab. data:

Qual. water data; type: USGS complete 1-22-62

Freq. sampling: original pumpage inventory: yes no period:

Aperture cards: yes

Log data:

WELL-DESCRIPTION CARD

SAME AS ON MASTER CARD Depth well: 132 ft Meas. accuracy 132

Depth cased: 126 ft Casing type: galv; Diam. 2 in

Finish: (C) porous concrete, (F) gravel w. (perf.), (G) gravel w. (screen), (H) horiz. gallery, (I) open end, (J) other, (K) perf., (L) screen, (M) sd. pt., (N) shored, (O) open hole, (P) other S

Method Drilled: (A) air rot, (B) bored, (C) cable, (D) dug, (E) hyd. rot., (F) jetted, (G) air percussion, (H) reverse, (I) rotary, (J) trenching, (K) driven, (L) wash, (M) other H

Date Drilled: 1957 9:57 Pump intake setting: 314 ft

Driller: Quick & Grace, Hattiesburg, Miss

Lift (type): (A) air, (B) bucket, (C) cent. jet, (D) multiple (cent.), (E) multiple (turb.), (F) none, (G) piston, (H) rot, (I) submerg, (J) turb, (K) other J Deep Shallow

Power (type): (A) diesel, (B) nat gas, (C) gasoline, (D) hand, (E) gas, (F) wind; (G) H.P. 5 Trans. or meter no. 5

Descrip. MP above LSD, Alt. MP ft below

Alt. LSD: 46 ft above MP; 46 ft below LSD Accuracy: rp

Water Level 46 ft above MP; 46 ft below LSD Accuracy: rp

Date meas: 10-5-61 0.61 Yield: 0 gpm Method determined 0

Drawdown: 0 ft Accuracy: 0 Pumping period 0 hrs

QUALITY OF WATER DATA: Iron 0.21 ppm Sulfate 0.4 ppm Chloride 2.9 ppm Hard. 7 ppm

Sp. Conduct 47 K x 10⁶ Temp. 64 °F Date sampled 1-22-62 162

Taste, color, etc. good

TRANSMITTED FOR ADP.

Well No. N 22

Well No. N22

Latitude-longitude _____
d m s N S d m s

HYDROGEOLOGIC CARD

SAME AS ON MASTER CARD

Physiographic Province: Coastal Plain 03 Section: East Gulf

Coastal Plain D Drainage Basin: 11319 Subbasin: 26

Topo of well site: (D) depression, stream channel, dunes, flat, hill top, sink, swamp, (H) offshore, pediment, hillside, terrace, undulating, valley flat H

MAJOR AQUIFER: Tertiary, Pliocene TP Citronelle CI

Lithology: Unconsolidated sd U:5 Origin: 2 Aquifer Thickness: _____ ft
Length of well open to: 6 ft Depth to top of: _____ ft

MINOR AQUIFER: _____ Origin: _____ Aquifer Thickness: _____ ft

Lithology: _____ Origin: _____ Aquifer Thickness: _____ ft
Length of well open to: _____ ft Depth to top of: _____ ft

Intervals Screened: 126-132 6' x 2" # 26 stainless steel screen

Depth to consolidated rock: _____ ft Source of data: _____

Depth to basement: _____ ft Source of data: _____

Surficial material: Sandy Unconsolidated R:U Infiltration characteristics: _____

Coefficient Trans: _____ gpd/ft Coefficient Storage: _____

Coefficient Perm: _____ gpd/ft²; Spec cap: _____ gpm/ft; Number of geologic cards: _____

State Chem Anal - medium hard
no filter needed

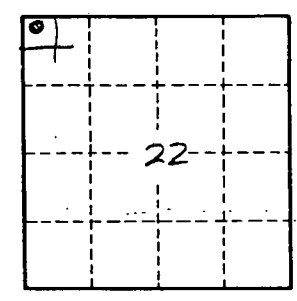
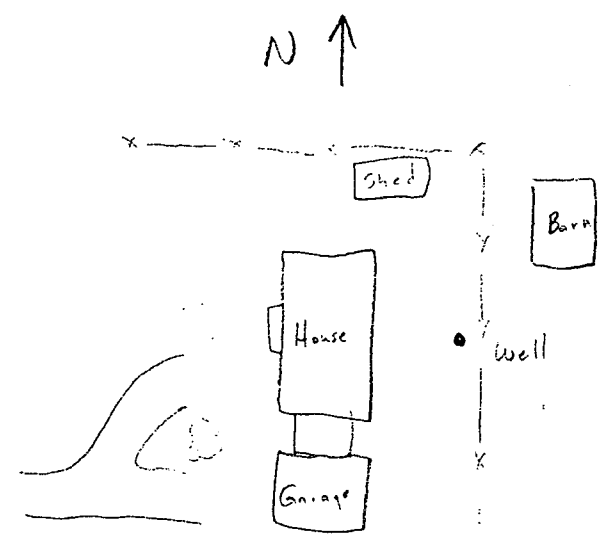

Well No. N22