

REPLACEMENT

WRD Exp. (GW)
April 1966

Well No. M7 **PUNCHED**

WELL SCHEDULE

U. S. DEPT. OF THE INTERIOR

GEOLOGICAL SURVEY

WATER RESOURCES DIVISION

MASTER CARD

Record by T. N. Shows Source of data C. G. Johnson Date 9-1-61 Map County

State Miss County (or town) Lamar 28 37

Latitude: 31° 04' 50" N Longitude: 089° 35' 10" W Sequential number: 2

Lat-long accuracy: 2' T. 1 S. R. 16 Sec 2, SE 1/4, NW 1/4

Local well number: M 0 0 7 D B 0 2 0 1 N 1 6 W Other B & M number: M2-5 AEC

Local use: 1 2 6 Owner or name: C. G. Johnson

Owner or name: C. G. Johnson Address: Rt 4, Lumberton, Miss

Ownership: County, Fed Gov't, City, Corp or Co, Private, State Agency, Water Dist P

Use of water: (A) Air cond, Bottling, Comm, Dewater, Power, Fire, (H) Dom, Irr, Med, Ind, P S, Rec, (S) Stock, Inscit, Unused, Repressure, Recharge, Desal-P S, Desal-other, Other H

Use of well: (A) Anode, Drain, Seismic, Heat Res, Obs, Oil-gas, Recharge, Test, Unused, Withdraf, Waste, Destroyed (W) W

DATA AVAILABLE: Well data Freq. W/L meas.: none Field aquifer char. N

Hyd. lab. data:

Qual. water data; type: USGS complete 9-1-61

Freq. sampling: Original Pumpage inventory: no period:

Aperture cards:

Log data:

WELL-DESCRIPTION CARD

SAME AS ON MASTER CARD Depth well: 173 ft Meas. accuracy 1 7 3 6

Depth cased: (first perf.) 169 ft Casing type: galv Diam. 2 in

Finish: (C) porous concrete, (F) gravel w. (G) gravel w. (H) horiz. open perf., (S) screen, (T) sd. pt., (W) shored, (X) open hole, (Z) other T

Method Drilled: (A) air rot, (B) bored, (C) cable, (D) dug, (H) hyd rot, (J) jetted, (P) air percussion, (R) reverse, (T) trenching, (V) driven, (W) drive wash, (Z) other H

Date Drilled: 1952 9 5 2 Pump intake setting: ft

Driller: T. C. Cabiness name address Purvis Miss

Lift (type): (A) air, (B) bucket, (C) jer, (L) multiple, (M) multiple, (N) none, (P) piston, (R) rot, (S) submerg, (T) turb, other J Deep D Shallow 40

Power (type): diesel, elec, gas, gasoline, hand, gas, wind; H.P. 3/4 Trans. or meter no. 5

Descrip. MP none above ft below LSD. Alt. MP

Alt. LSD: Accuracy: (source)

Water Level 90 ft above MP; Ft below LSD 90 Accuracy: reported

Date meas: 1952 5 2 Yield: gpm Method determined

Drawdown: ft Accuracy: Pumping period hrs

QUALITY OF WATER DATA: Iron 0.15 Sulfate 0.8 Chloride 2.0 Hard. 14

Sp. Conduct 34 K x 10⁶ Temp. 69 °F Date sampled 9-1-61

Taste, color, etc. red color

TRANSMITTED FOR ADP

Well No. M7

Well No. M7

Latitude-longitude N
S
d m s d m s

HYDROGEOLOGIC CARD

SAME AS ON MASTER CARD Province: Coastal Plain 03 Section: East Gulf Coastal

Plain D Drainage Basin: 1 1310 Subbasin: 20

Topo of well site: (D) depression, stream channel, dunes, (C) flat, (E) hilltop, (F) sink, (H) swamp, (K) offshore, pediment, hillside, terrace, undulating, valley flat (L) F

MAJOR AQUIFER: Tertiary system, Pliocene series, TP aquifer, formation, group, Citronelle Form CI

Lithology: unconsolidated sands 45 Origin: Fluvial 2 Aquifer Thickness: ft

Length of well open to: 4 ft 4 Depth to top of: at surface ft 0

MINOR AQUIFER: system, series, aquifer, formation, group,

Lithology: Origin: Aquifer Thickness: ft

Length of well open to: ft Depth to top of: ft

Intervals Screened: 169-173 ft, 4 ft sandpoint

Depth to consolidated rock: ft Source of data:

Depth to basement: ft Source of data:

Surficial material: Infiltration characteristics:

Coefficient Trans: gpd/ft Coefficient Storage:

Coefficient Perm: gpd/ft²; Spec cap: gpm/ft; Number of geologic cards:

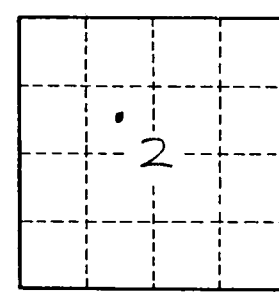
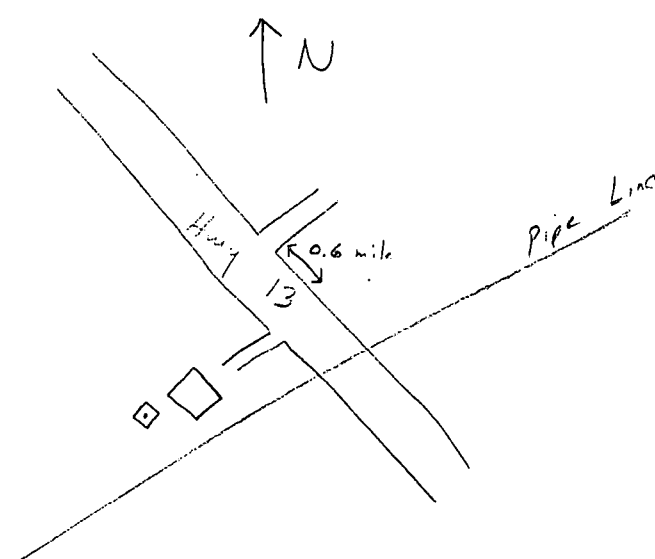

Well No. M7