

6/78 WTO

6W01392

0370009-02

Purvis Quad

Recorded by WTO

U.S. GEOLOGICAL SURVEY
WATER RESOURCES DIVISION
MISSISSIPPI DISTRICT

Well No. L94
E-Log No. 114
County LAMAR

Date 12/5/78

TRANSMITTED FOR ADP

WELL RECORD

MAR 1979

352 A.C.

Site ID 31081X089243X01 R=0* T=A* 2-W*

GEN. SITE DATA

Data reliab. 3=C Report. agency 4=USGS* Dist. 6=28* 7=28* Co. 8=0,73*

Lat. 9=31081X Long. 10=089243X Well No. 12=L094*

Location 13=SWNE1/4 T02N R14W* Alt. 16=348*

Hyd. Unit (OWDC) 20= Date 21=10/18/1978*

Well use 23=W* Water Use 24=P* Hole depth 27=1582* Well depth 28=261*

WL 30=113* Date 31=02/19/1979* Source 33=S*

Status 273= Project No. 5=

OWNER

R=158* T=A* Date 159#01/15/1979* Owner No. Well #2

Owner 161=PURVIS

Owner is Lamar County Board of Education (16th Section land)

FIELD OW

R=192* T=A* Date 193# Temp. 196#00010* 197=
R=192* T=A* Date 193# Cond. 196#00095* 197=
R=192* T=A* Date 193# pH 196#00400* 197=

CONSTR.

R=58* T=A* 59#1* Date 60=01/15/1979* Remarks S
Drlg. 63=1,84* Name Griner Method 65=H* Finish 66=Z*

CASING

R=76* T=A* 59#1*
Top csng. 77#0* Bot. csng. 78= Diam. 79#0*
R=76* T=A* 59#1*
Top csng. 77# Bot. csng. 78= Diam. 79#

OPENINGS

R=82* T=A* 59#1* Top 83#201* Bottom 84=261*
Type 85=S* Diam. 87=8* Size 88=
R=82* T=A* 59#1* Top 83# Bottom 84=
Type 85= Diam. 87= Size 88=

YIELD

R=46* T=A* 147#1* Q 150=300 400* Q/S 272=

134 flows 146 pumped

R=42* T= A * Lift type 43# T* Intake 44= * Power type 45= E*

Date 38= 01/15/1979* H.P. 46= 4.0.*

LIFT

R=198* T= A * Log 199# D* Top 200= 0.* Bot 201= 1582.*

R=198* T= A * Log 199# E* Top 200= 10.* Bot 201= 1581.*

R=189* T= A * E Log No. 190# 114* 191= M I S S D I S T *

LOGS

R=114* T= A * Year 115# * Type 120= * 2

ANAL.

R=90* T= A * 256# 1 * Top 91= 170.* Bot 92= 260.*

Unit ID 93= 122MOCN * Name of Unit PCGL (Tim) USING CRNL (Permit) 11/01

R=90* T= A * 256# 1 * Top 91= * Bot 92= *

Unit ID 93= * Name of Unit

AQUIFERS

R=98* T= A * 99# 1 * Unit tested 100= * 103= *

R=105* T= A * 99# 1 * Test No. 106# *

107= * Transmissivity (gal/d)/ft

108= * Hydraul. cond. (gal/d)/ft²

110= * Storage coeff. Boundaries

HYDRAULICS

R=121* T= A * Yr Begin 122# 1979 * Network 258= *

Water Level Data Collection (1)
5/19/83
WL = 120. - 2.00 = 118.

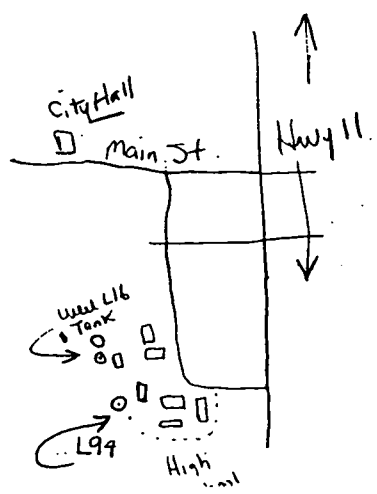

description of formations encountered	from	to
Top Soil	0	3
Clay, Red	3	18
SAND w/Play Stratics	18	82
CLAY	82	170
SAND medium w/pen gravel	170	260
CLAY w/Rocks + sandstone	260	845
CLAY	845	1020
CLAY SAND, Medium	845	1020
CLAY	1010	1125
BANDY CLAY	1125	1235
CLAY	1235	1275
SAND + CLAY STRATICS	1275	1557
CLAY + ROCKS	1557	1582

LAMAR
 94
 1/79
 Log # 114

MISSISSIPPI
 BOARD OF WATER COMMISSIONERS
 416 North State Street
 Jackson, Mississippi 39201

WATER WELL DRILLERS LOG CODED

Jan. 1979 WATER DRILLING SERVICE LAMAR
 date well completed firm name county well located

LANDOWNER: CITY OF PURVIS, WELL NO. 2
 (mailing address)

WELL LOCATION: North SW 1/4 NE 1/4
 sec. 16 T. 2 N. R. 14 E. S. 5 W. W
 (distance) miles (direction) of (nearest town)

WELL PURPOSE: (home, irrigation, municipal, industrial)

WELL COMPLETION DATA:
 (1) diameter (inches) 10 3/4"
 (2) total depth (feet) 261'
 (3) static water level (feet) 119.20 below top of ground.
 (4) casing Steel 297' (material) (depth)
10 3/4" (size) if telescope see back.
 (5) screen 60 20' (length) (depth to top)
8" 304 S.S. (size) (material)
 (6) pump 40 4-60 (HP) (yield gpm).
Elect. (type power)
 (7) electric log Yes (yes or no)
MGS (organization running log)
 (8) how well bottom plugged BACK WASH
VALVE

description of formations encountered	from	to
Top Soil	0	3
Clay, Red	3	18
SAND w/ clay streaks	18	82
CLAY	82	170
SAND, medium w/ pea gravel	170	260
CLAY w/ rocks + sand streaks	260	345
SAND, medium	107	
SAND, medium	345	1010
CLAY	1010	1175
BANDY CLAY	1175	1235
CLAY	1235	1275
SAND + CLAY STREAKS	1275	1557
CLAY + ROCKS	1557	1582

CODED

Miss. Board of Water Comm.

MAR 5 - 1979

RECEIVED

DRILLERS REMARKS:

DEPARTMENT OF ENVIRONMENTAL QUALITY - OLWR

PUBLIC SUPPLY WELLS PROJECT

Purvis
quad

GPS LOG

USER NAME(S): SHO + CAH DATE: 7-14-94
UNIT DEQ #: 82555 FILE #: C071420B
HEALTH DEPT. #: 370009-02 ELEV: 345
USGS #: 252 294 OLWR #: GW 1392
OWNER: Town of Purvis
LOCATION: S 16 T 2N R 14W COUNTY: Lamar
LOCATION DESCRIPTION: South of High School about 2/10 mi. west of
Hwy 11 S at Purvis. (west of School Bus yard.)
CASING DIA: _____ PUMP TYPE & SIZE: Sub Pump
GPS FIELD LOCATION: LAT. 31° 08.217 LONG. 89° 24.501
GPS CORRECTED LOCATION: LAT. 31.137016 LONG. 89.408101
REMARKS: GPS at well

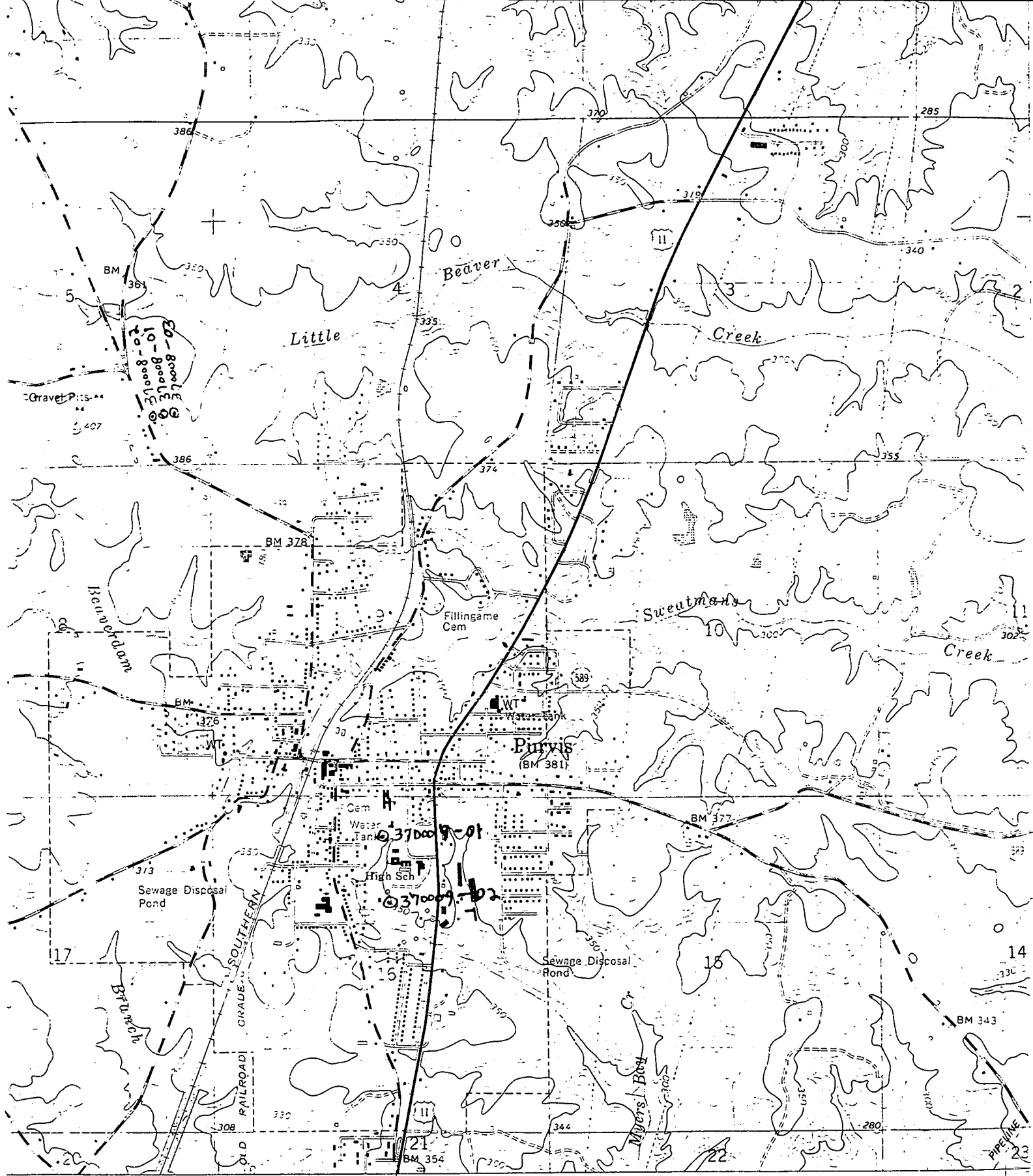

269 25' 270000m.E LUMBERTON 9 MI. POPLARVILLE 22 MI. INTERIOR—GEOLOGICAL SURVEY, RESTON, VIRGINIA—1982 89°

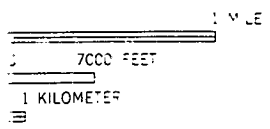

ROAD CLASSIFICATION			
Heavy-duty		Light-duty	
Medium-duty		Unimproved dirt	
	U. S. Route		State Route

