

WELL SCHEDULE

U. S. DEPT. OF THE INTERIOR

GEOLOGICAL SURVEY

WATER RESOURCES DIVISION

MASTER CARD

Record by PEG+RET Source of data Gbs. Date 4-30-63 Map _____

State 28 County (or town) 37

Latitude: 31° 06' 35" N Longitude: 089° 31' 46" W Sequential number: 7

Lat-long accuracy: 3 T. 2 S. R. 15 W. Sec. 29 NE NW

Local well number: K130 AB 2902 N15 W Other number: K29-9

Local use: UNK Owner or name: _____

Owner or name: MARVIN BRAZEALE Address: _____

Ownership: County, Fed Gov't, City, Corp or Co, Private, State Agency, Water Dist P

Use of water: (A) Air cond, Bottling, Comm, Dewater, Power, Fire, Dom, Irr, Med, Ind, P S, Rec, (S) Stock, (T) Instat, (U) Unused, (V) Reppure, (W) Recharge, (X) Desal-P S, (Y) Desal-other, (Z) Other H

Use of well: (A) Anode, (D) Drain, (G) Seismic, (H) Heat Res, (I) Obs, (J) Oil-gas, (K) Recharge, (L) Test, (M) Unused, (N) Withdraw, (O) Waste, (P) Destroyed W

DATA AVAILABLE: Well data Freq. W/L meas.: N Field aquifer char.

Hyd. lab. data:

Qual. water data; type:

Freq. sampling: N Pumpage inventory: yes no, period:

Aperture cards: yes

Log data:

WELL-DESCRIPTION CARD

SAME AS ON MASTER CARD Depth well: _____ ft 65 Meas. 6

Depth cased: (first perf.) _____ ft _____ Casing type: Concrete tile Diam. _____ in 6

Finish: (C) porous concrete, (E) gravel w. (perf.), (G) gravel w. (screen), (H) horiz. open perf., (I) screen, (J) sd. pt., (K) shored, (L) open hole, (M) other

Method Drilled: (A) air bored, (B) cable, (C) dug, (D) hyd rot., (E) jetted, (F) air reverse, (G) trenching, (H) driven, (I) wash, (J) other

Date Drilled: _____ Pump intake setting: _____ ft _____

Driller: _____ name _____ address _____

Lift (type): (A) air, (B) bucket, (C) cent, (D) jet, (E) multiple, (F) multiple, (G) none, (H) piston, (I) rot, (J) submerg, (K) turb, (L) other J Deep Shallow

Power (type): diesel, elec nat gas, gasoline, hand, gas, wind; H.P. 5 Trans. or meter no. _____

Descrip. MP _____ ft above LSD, Alt. MP _____

Alt. LSD: _____ Accuracy: (source) _____

Water Level: _____ ft above MP; _____ ft below LSD Accuracy: _____

Date meas.: _____ Yield: _____ gpm Method determined _____

Drawdown: _____ ft Accuracy: _____ Pumping period _____ hrs _____

QUALITY OF WATER DATA: Iron _____ ppm Sulfate _____ ppm Chloride _____ ppm Hard. _____ ppm

Sp. Conduct _____ K x 10 _____ Temp. _____ °F Date sampled _____

Taste, color, etc. _____

Well No. K130

025201019

Well No. K130

Latitude-longitude N
S
d m s d m s

HYDROGEOLOGIC CARD

SAME AS ON MASTER CARD Physiographic Province: 03 Section: _____

D Drainage Basin: 130 Subbasin: _____

(D) (C) (E) (F) (H) (K) (L)
Topo of well site: depression, stream channel, dunes, flat, hilltop, sink, swamp,
(O) (P) (S) (T) (U) (V)
offshore, pediment, hillside, terrace, undulating, valley flat _____

MAJOR AQUIFER: _____ system, _____ series TP _____ aquifer, formation, group CI

Lithology: _____ Origin: 2 Aquifer Thickness: _____ ft

Length of well open to: _____ ft _____ Depth to top of: _____ ft _____

MINOR AQUIFER: _____ system, _____ series _____ aquifer, formation, group _____

Lithology: _____ Origin: _____ Aquifer Thickness: _____ ft

Length of well open to: _____ ft _____ Depth to top of: _____ ft _____

Intervals Screened: _____

Depth to consolidated rock: _____ ft _____ Source of data: _____

Depth to basement: _____ ft _____ Source of data: _____

Surficial material: _____ Infiltration characteristics: _____

Coefficient Trans: _____ gpd/ft _____ Coefficient Storage: _____

Coefficient Perm: _____ gpd/ft²; Spec cap: _____ gpm/ft; Number of geologic cards: _____

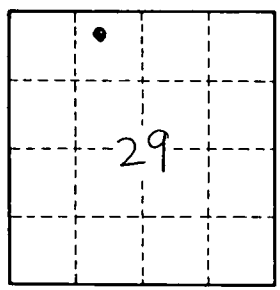
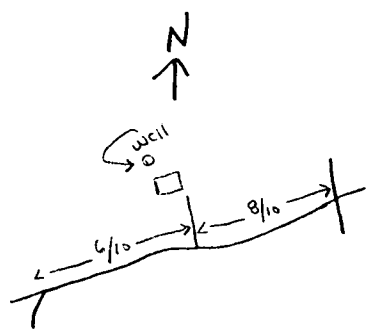

Well No. K130