

WELL SCHEDULE

U. S. DEPT. OF THE INTERIOR

GEOLOGICAL SURVEY

WATER RESOURCES DIVISION

MASTER CARD

Record by TNS Source of data owner Date 3-22-61 Map _____

State 28 County (or town) 37

Latitude: 31° 07' 21" N Longitude: 089° 30' 24" W Sequential number: 1

Lat-long accuracy: 2' T. 2 S, R. 15 W Sec 21, NE 1/4, SW 1/4, NE 1/4

Local well number: K094CA2102N15W Other number: K21-3

Local use: X03 Owner or name: _____

Owner or name: JAMES PARKER Address: _____

Ownership: County, Fed Gov't, City, Corp or Co, Private, State Agency, Water Dist P

Use of water: (A) Air cond, Bottling, Comm, Dewater, Power, Fire, Dom, Irr, Med, Ind, P S, Rec, (S) Stock, Instit, Unused, Repressure, Recharge, Desal-P S, Desal-other, Other H

Use of well: (A) Anode, Drain, Seismic, Heat Res, Obs, Oil-gas, Recharge, Test, Unused, Withdraw, Waste, Destroyed W

DATA AVAILABLE: Well data Freq. W/L meas.: Field aquifer char.

Hyd. lab. data: _____

Qual. water data; type: _____

Freq. sampling: N Pumpage inventory: no, period: _____

Aperture cards: _____

Log data: _____

WELL-DESCRIPTION CARD

SAME AS ON MASTER CARD Depth well: _____ ft 55 Meas. rept accuracy 6

Depth cased: (first perf.) _____ ft 50 Casing type: _____; Diam. _____ in 2

Finish: porous concrete, gravel w. (perf.), gravel w. (screen), horiz. gallery, open end, other T

Method: (A) air bored, (B) cable, (C) dug, (D) hyd jetted, (E) air rot., (F) percussion, (G) rotary, (H) reverse trenching, (I) driven, (J) drive wash, (K) other B

Date Drilled: 9-5-5 Pump intake setting: _____ ft _____

Driller: Thomas Parber

Lift (type): (A) air, (B) bucket, (C) cent, (D) jet, (E) multiple, (F) multiple, (G) none, (H) piston, (I) rot, (J) submerg, (K) turb, (L) other P Deep 40

Power (type): diesel, elec, gas, gasoline, hand, gas, wind; H.P. 1/3 Trans. or meter no. 5

Descrip. MP _____ ft above below LSD, Alt. MP _____

Alt. LSD: _____ Accuracy: (source) _____

Water Level: _____ ft above below MP; _____ ft above below LSD 27 Accuracy: _____

Date meas: D60 Yield: _____ gpm Method determined _____

Drawdown: _____ ft Accuracy: _____ Pumping period _____ hrs _____

QUALITY OF WATER DATA: Iron _____ ppm Sulfate _____ ppm Chloride _____ Hard. _____

Sp. Conduct _____ K x 10 6 Temp. _____ °F Date sampled _____

Taste, color, etc. _____

Well No. K94

Well No. K94

Latitude-longitude _____

HYDROGEOLOGIC CARD

SAME AS ON MASTER CARD Physiographic Province: 03 Section: _____

D Drainage Basin: 130 Subbasin: _____

(D) depression, stream channel, dunes, flat, hilltop, sink, swamp,
 (P) offshore, pediment, hillside, terrace, undulating, valley flat S

MAJOR AQUIFER: T.P. system, series, aquifer, formation, group C.I.

Lithology: S Origin: 2 Aquifer Thickness: _____ ft

Length of well open to: _____ ft 5 Depth to top of: _____ ft

MINOR AQUIFER: _____ system, series, aquifer, formation, group

Lithology: _____ Origin: _____ Aquifer Thickness: _____ ft

Length of well open to: _____ ft _____ Depth to top of: _____ ft

Intervals Screened: 50' - 55'

Depth to consolidated rock: _____ ft _____ Source of data: _____

Depth to basement: _____ ft _____ Source of data: _____

Surficial material: _____ Infiltration characteristics: _____

Coefficient Trans: _____ gpd/ft _____ Coefficient Storage: _____

Coefficient Perm: _____ gpd/ft²; Spec cap: _____ gpm/ft; Number of geologic cards: _____

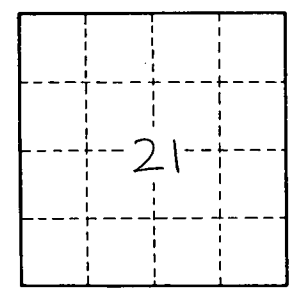
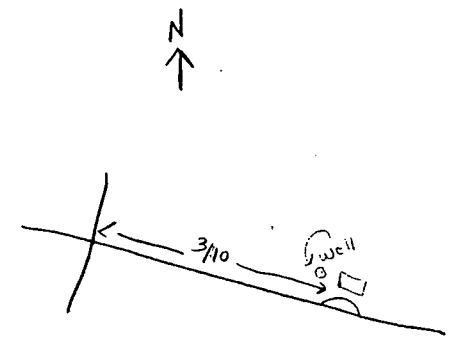

Well No. K94