

# REPLACEMENT

WRD Exp. (GW)  
April 1966

Well No. K13

## WELL SCHEDULE

U. S. DEPT. OF THE INTERIOR

GEOLOGICAL SURVEY

WATER PUNCHED and VERIFIED  
ROLLA COMPUTATION BRANCH

### MASTER CARD

Record by TNS Source of data owner Date 3-22-61 Map \_\_\_\_\_

State 28 County (or town) 37

Latitude: 310758 N Longitude: 0893256 Sequential number: 1

Lat-long accuracy: 2 T. 2 S, R. 16 W Sec. 18, NE  $\frac{1}{4}$ , NW  $\frac{1}{4}$ , SW  $\frac{1}{4}$

Local well number: K0136e1802N16W Other number: K18-4

Local use: 000 Owner or name: \_\_\_\_\_

Owner or name: R. L. ANDERSON JR. Address: Rt #4, Lumberton

Ownership: County, Fed Gov't, City, Corp or Co, Private, State Agency, Water Dist P

Use of water: (A) Air cond, (B) Bottling, (C) Comm, (D) Dewater, (E) Power, (F) Fire, (G) Dom, (H) Irr, (I) Med, (J) P S, (K) Rec, (L) Stock, (M) Uninst, (N) Unused, (O) Reppure, (P) Recharge, (Q) Desal-P S, (R) Desal-other, (S) Other 2

Use of well: (A) Anode, (B) Drain, (C) Seismic, (D) Heat Res, (E) Obs, (F) Oil-gas, (G) Recharge, (H) Test, (I) Unused, (J) Withdraw, (K) Waste, (L) Destroyed 2

DATA AVAILABLE: Well data 0 Freq. W/L meas.: 0 Field aquifer char. 0

Hyd. lab. data: \_\_\_\_\_

Qual. water data; type: USGS Complete 1-19-62

Freq. sampling: 0 Pumpage inventory: no period: \_\_\_\_\_

Aperture cards: \_\_\_\_\_

Log data: \_\_\_\_\_

### WELL-DESCRIPTION CARD

SAME AS ON MASTER CARD Depth well: 62 ft Meas. 6

Depth cased: (first perf.) \_\_\_\_\_ ft Casing type: \_\_\_\_\_; Diam. \_\_\_\_\_ in

Finish: porous concrete, gravel w. (perf.), gravel w. (screen), horiz. gallery, open end, other T

Method Drilled: (A) air bored, (B) cable, (C) dug, (D) hyd jetted, (E) air rot., (F) reverse, (G) percussive, (H) rotary, (I) trenching, (J) driven, (K) wash, (L) other N

Date Drilled: 9:50 Pump intake setting: \_\_\_\_\_ ft

Driller: owner name \_\_\_\_\_ address \_\_\_\_\_

Lift (type): (A) air, (B) bucket, (C) cent, (D) jet, (E) multiple, (F) multiple, (G) none, (H) piston, (I) rot, (J) submerg, (K) turb, (L) other P Deep 0 Shallow 40

Power (type): diesel, elec, gas, gasoline, hand, gas, wind; H.P. 1/2 Trans. or meter no. 5

Descrip. MP \_\_\_\_\_ ft above LSD, Alt. MP \_\_\_\_\_

Alt. LSD: \_\_\_\_\_ Accuracy: (source) \_\_\_\_\_

Water Level \_\_\_\_\_ ft above below MP; Ft below LSD \_\_\_\_\_ Accuracy: \_\_\_\_\_

Date meas: \_\_\_\_\_ Yield: \_\_\_\_\_ gpm Method determined 4

Drawdown: \_\_\_\_\_ ft Accuracy: \_\_\_\_\_ Pumping period \_\_\_\_\_ hrs

QUALITY OF WATER DATA: Iron \_\_\_\_\_ ppm Sulfate \_\_\_\_\_ ppm Chloride \_\_\_\_\_ ppm Hard. \_\_\_\_\_ ppm

Sp. Conduct \_\_\_\_\_ K x 10<sup>6</sup> Temp. 67 Date sampled \_\_\_\_\_

Taste, color, etc. \_\_\_\_\_

Well No. K13

Well No. K13

Latitude-longitude \_\_\_\_\_ N  
d m s S d m s

**HYDROGEOLOGIC CARD**

SAME AS ON MASTER CARD Physiographic Province: 03 Section: \_\_\_\_\_

D Drainage Basin: 13V Subbasin: \_\_\_\_\_

Topo of well site: (D) depression, stream channel, dunes, flat, hilltop, sink, swamp, (E) (F) (H) (K) (L) (O) (P) (S) (T) (U) (V) offshore, pediment, hillside, terrace, undulating, valley flat H

MAJOR AQUIFER: \_\_\_\_\_ system \_\_\_\_\_ series TP \_\_\_\_\_ aquifer, formation, group CI

Lithology: \_\_\_\_\_ Origin: 3 Aquifer Thickness: \_\_\_\_\_ ft  
Length of well open to: \_\_\_\_\_ ft Depth to top of: \_\_\_\_\_ ft

MINOR AQUIFER: \_\_\_\_\_ system \_\_\_\_\_ series \_\_\_\_\_ aquifer, formation, group \_\_\_\_\_

Lithology: \_\_\_\_\_ Origin: \_\_\_\_\_ Aquifer Thickness: \_\_\_\_\_ ft  
Length of well open to: \_\_\_\_\_ ft Depth to top of: \_\_\_\_\_ ft

Intervals Screened: \_\_\_\_\_

Depth to consolidated rock: \_\_\_\_\_ ft \_\_\_\_\_ Source of data: \_\_\_\_\_

Depth to basement: \_\_\_\_\_ ft \_\_\_\_\_ Source of data: \_\_\_\_\_

Surficial material: \_\_\_\_\_ Infiltration characteristics: \_\_\_\_\_

Coefficient Trans: \_\_\_\_\_ gpd/ft \_\_\_\_\_ Coefficient Storage: \_\_\_\_\_

Coefficient Perm: \_\_\_\_\_ gpd/ft<sup>2</sup>; Spec cap: \_\_\_\_\_ gpm/ft; Number of geologic cards: \_\_\_\_\_

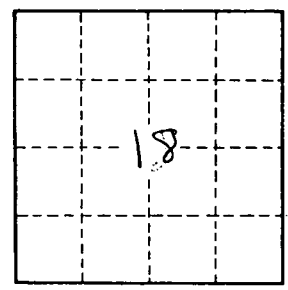
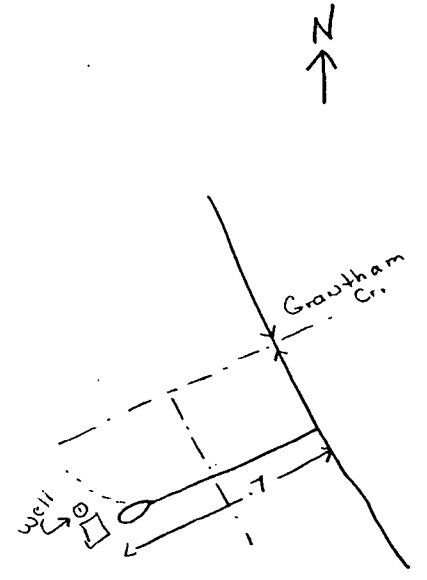

Well No. K13