

### WELL SCHEDULE

U. S. DEPT. OF THE INTERIOR

GEOLOGICAL SURVEY

WATER RESOURCES DIVISION

#### MASTER CARD

Record by PEG+RET Source of data Obs Date 4-30-63 Map \_\_\_\_\_

State 28 County (or town) 37

Latitude: 31° 06' 52" N Longitude: 089° 34' 35" W Sequential number: 7

Lat-long accuracy: 3 T. 2 S. R. 16 Sec 23 T. SW S. SE

Local well number: J201CD2302N16W Other number: J23-2

Local use: \_\_\_\_\_ Owner or name: \_\_\_\_\_

Owner or name: L O HOWARD Address: \_\_\_\_\_

Ownership: County, Fed Gov't, City, Corp or Co, Private, State Agency, Water Dist \_\_\_\_\_ P

Use of water: (A) Air cond, Bottling, Comm, Dewater, Power, Fire, Dom, Irr, Med, Ind, P S, Rec, (S) Stock, Instic, Unused, Repressure, Recharge, Desal-P S, Desal-other, Other \_\_\_\_\_ U

Use of well: (A) Anode, Drain, Seismic, Heat Res, Obs, Oil-gas, Recharge, Test, Unused, Withdraw, Waste, Destroyed \_\_\_\_\_ U

DATA AVAILABLE: Well data  Freq. W/L meas.: N Field aquifer char. \_\_\_\_\_

Hyd. lab. data: \_\_\_\_\_

Qual. water data; type: \_\_\_\_\_

Freq. sampling: \_\_\_\_\_ Pumpage inventory: N yes/no; period: \_\_\_\_\_

Aperture cards: \_\_\_\_\_

Log data: \_\_\_\_\_

#### WELL-DESCRIPTION CARD

SAME AS ON MASTER CARD Depth well: (?) ft Meas. rept accuracy \_\_\_\_\_

Depth cased: \_\_\_\_\_ ft Casing type: \_\_\_\_\_; Diam. \_\_\_\_\_ in

Finish: (C) porous concrete, (F) gravel w. (perf.), (G) gravel w. (screen), (H) horiz. gallery, (Ø) open end, (P) perf., (S) screen, (T) sd. pt., (W) shored, (X) open hole, (Z) other \_\_\_\_\_

Method Drilled: (A) air rot, (B) bored, (C) cable, (D) dug, (H) hyd rot., (J) jetted, (P) air percussion, (R) reverse, (T) rotary, (V) trenching, (W) driven, (Z) drive wash, other \_\_\_\_\_

Date Drilled: old Pump intake setting: \_\_\_\_\_ ft

Driller: \_\_\_\_\_ name \_\_\_\_\_ address \_\_\_\_\_

Lift (type): (A) air, (B) bucket, (C) cent, (J) jet, (L) multiple, (M) multiple, (N) none, (P) piston, (R) rot, (S) submerg, (T) turb, (Z) other \_\_\_\_\_ Deep \_\_\_\_\_ Shallow \_\_\_\_\_

Power (type): nat diesel, elec, gas, gasoline, hand, gas, wind; LP H.P. none Trans. or meter no. \_\_\_\_\_

Descrip. MP \_\_\_\_\_ ft above \_\_\_\_\_ below LSD, Alt. MP \_\_\_\_\_

Alt. LSD: \_\_\_\_\_ Accuracy: (source) \_\_\_\_\_

Water Level: \_\_\_\_\_ ft above \_\_\_\_\_ below MP; \_\_\_\_\_ ft above \_\_\_\_\_ below LSD Accuracy: \_\_\_\_\_

Date meas: \_\_\_\_\_ Yield: \_\_\_\_\_ gpm Method determined \_\_\_\_\_

Drawdown: \_\_\_\_\_ ft Accuracy: \_\_\_\_\_ Pumping period \_\_\_\_\_ hrs

QUALITY OF WATER DATA: Iron \_\_\_\_\_ ppm Sulfate \_\_\_\_\_ ppm Chloride \_\_\_\_\_ ppm Hard. \_\_\_\_\_ ppm

Sp. Conduct \_\_\_\_\_ K x 10<sup>6</sup> Temp. \_\_\_\_\_ °F Date sampled \_\_\_\_\_

Taste, color, etc. \_\_\_\_\_

PUNCHED and VERIFIED  
ROLLA COMPUTATION BRANCH

Well No. 1

J201

Well No. J201

Latitude-longitude  
N  
S  
d m s d m s

COPY OF FORM... ATTACHED TO APPLICATION

**HYDROGEOLOGIC CARD**

1  19 **Physiographic Province:** 03 20 21 **Section:** \_\_\_\_\_

22  **Drainage Basin:** 131V 23 25 **Subbasin:**  26

**Topo of well site:** (D) depression, (C) stream channel, (E) dunes, (F) flat, (H) hilltop, (K) sink, (L) swamp, (P) offshore, (S) pediment, (T) hillside, (U) terrace, (V) undulating, (W) valley flat 27

**MAJOR AQUIFER:** \_\_\_\_\_ 28 29 \_\_\_\_\_ 30 31 \_\_\_\_\_

**Lithology:** \_\_\_\_\_ 32 33 **Origin:** \_\_\_\_\_ 34 **Aquifer Thickness:** \_\_\_\_\_ ft

**Length of well open to:** \_\_\_\_\_ ft 35 37 **Depth to top of:** \_\_\_\_\_ ft 38 40 **Depth to top of:** \_\_\_\_\_ ft 41 43

**MINOR AQUIFER:** \_\_\_\_\_ 44 45 \_\_\_\_\_ 46 47 \_\_\_\_\_

**Lithology:** \_\_\_\_\_ 48 49 **Origin:** \_\_\_\_\_ 50 **Aquifer Thickness:** \_\_\_\_\_ ft

**Length of well open to:** \_\_\_\_\_ ft 51 53 **Depth to top of:** \_\_\_\_\_ ft 54 56 **Depth to top of:** \_\_\_\_\_ ft 57 59

**Intervals Screened:** \_\_\_\_\_

**Depth to consolidated rock:** \_\_\_\_\_ ft 60 63 **Source of data:** \_\_\_\_\_ 64

**Depth to basement:** \_\_\_\_\_ ft 65 68 **Source of data:** \_\_\_\_\_ 69

**Surficial material:** \_\_\_\_\_ 70 71 **Infiltration characteristics:** \_\_\_\_\_ 72

**Coefficient Trans:** \_\_\_\_\_ gpd/ft 73 75 **Coefficient Storage:** \_\_\_\_\_ 76 78

**Coefficient Perm:** \_\_\_\_\_ gpd/ft<sup>2</sup>; **Spec cap:** \_\_\_\_\_ gpm/ft; **Number of geologic cards:** \_\_\_\_\_ 79

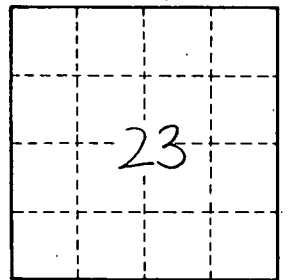
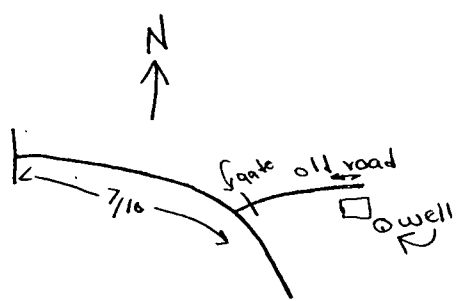

Well No. J201