

WRD Exp. (GW)  
April 1966

Well No. J197

### WELL SCHEDULE

U. S. DEPT. OF THE INTERIOR

GEOLOGICAL SURVEY

WATER RESOURCES DIVISION

#### MASTER CARD

Record by PEG+RET Source of data owner Date 5-2-63 Map \_\_\_\_\_

State 28 County (or town) 37

Latitude: 31° 07' 22" N Longitude: 089° 36' 42" W Sequential number: 1

Lat-long accuracy: 3 T. 20 S. R. 16 E. Sec 21, SW NE

Local well number: J197CA2102N16W Other number: J21-12 B & H

Local use: 126 Owner or name: T. G. HOWELL Address: \_\_\_\_\_

Ownership: County, Fed Gov't, City, Corp or Co, Private, State Agency, Water Dist P

Use of water: (A) (E) (C) (D) (E) (F) (H) (I) (M) (N) (P) (R) A

Use of well: (S) (T) (U) (V) (W) (X) (Y) (Z) W

DATA AVAILABLE: Well data  Freq. W/L meas.:  Field aquifer char.

Hyd. lab. data: \_\_\_\_\_

Qual. water data; type: \_\_\_\_\_

Freq. sampling: N Pumpage inventory: no, period: \_\_\_\_\_

Aperture cards: \_\_\_\_\_

Log data: \_\_\_\_\_

#### WELL-DESCRIPTION CARD

SAME AS ON MASTER CARD Depth well: 120 ft Meas. rept accuracy 6

Depth cased: \_\_\_\_\_ ft Casing type: galv. Diam. in 2

Finish: (C) porous concrete, (F) gravel w. (per.), (G) gravel w. (screen), (H) horiz. gallery, end, (I) open end, (J) other, (K) other

Method Drilled: (A) air rot., (B) bored, (C) cable, (D) dug, (E) hyd. rot., (F) jetted, (G) air perc., (H) reverse, (I) rotary, (J) trenching, (K) driven, (L) wash, (M) other

Date Drilled: 9-5-2 Pump intake setting: \_\_\_\_\_ ft

Driller: T.C. Calvanese

Lift (type): (A) air, (B) bucket, (C) cent., (D) jet, (E) multiple, (F) multiple, (G) none, (H) piston, (I) rot., (J) submerg., (K) turb., (L) other

Power (type): (A) diesel, (B) elec., (C) gas, (D) gasoline, (E) hand, (F) gas, (G) wind, (H) H.P.

Descrip. MP \_\_\_\_\_ ft above \_\_\_\_\_ ft below LSD, Alt. MP \_\_\_\_\_

Alt. LSD: \_\_\_\_\_ Accuracy: (source) \_\_\_\_\_

Water Level: \_\_\_\_\_ ft above \_\_\_\_\_ ft below MP; \_\_\_\_\_ ft below LSD Accuracy: \_\_\_\_\_

Date meas.: 5-2 Yield: \_\_\_\_\_ gpm Method determined \_\_\_\_\_

Drawdown: \_\_\_\_\_ ft Accuracy: \_\_\_\_\_ Pumping period \_\_\_\_\_ hrs

QUALITY OF WATER DATA: Iron \_\_\_\_\_ ppm Sulfate \_\_\_\_\_ ppm Chloride \_\_\_\_\_ ppm Hard. \_\_\_\_\_ ppm

Sp. Conduct \_\_\_\_\_ K x 10<sup>6</sup> Temp. \_\_\_\_\_ °F Date sampled \_\_\_\_\_

Taste, color, etc. Clear

PUNCHED and VERIFIED  
ROLLA COMPUTATION BRANCH

Well No. J197

Well No. J197

Latitude-longitude N  
S  
d m s d m s

WATER RESOURCES DIVISION  
BUREAU OF APPLIED

**HYDROGEOLOGIC CARD**

**SAME AS ON MASTER CARD** Physiographic Province: 03 Section: \_\_\_\_\_

Drainage Basin: D 13V Subbasin: \_\_\_\_\_

Topo of well site: (D) depression, stream channel, dunes, flat, hilltop, sink, swamp, (E) (F) (H) (K) (L) (P) (S) (T) (U) (V) offshore, pediment, hillside, terrace, undulating, valley flat \_\_\_\_\_

MAJOR AQUIFER: \_\_\_\_\_ system \_\_\_\_\_ series TP \_\_\_\_\_ aquifer, formation, group CI

Lithology: \_\_\_\_\_ Origin: 2 \_\_\_\_\_ ft  
Length of well open to: \_\_\_\_\_ ft Depth to top of: \_\_\_\_\_ ft

MINOR AQUIFER: \_\_\_\_\_ system \_\_\_\_\_ series \_\_\_\_\_ aquifer, formation, group \_\_\_\_\_

Lithology: \_\_\_\_\_ Origin: \_\_\_\_\_ ft  
Length of well open to: \_\_\_\_\_ ft Depth to top of: \_\_\_\_\_ ft

Intervals Screened: \_\_\_\_\_

Depth to consolidated rock: \_\_\_\_\_ ft Source of data: \_\_\_\_\_

Depth to basement: \_\_\_\_\_ ft Source of data: \_\_\_\_\_

Surficial material: \_\_\_\_\_ Infiltration characteristics: \_\_\_\_\_

Coefficient Trans: \_\_\_\_\_ gpd/ft Coefficient Storage: \_\_\_\_\_

Coefficient Perm: \_\_\_\_\_ gpd/ft<sup>2</sup>; Spec cap: \_\_\_\_\_ gpm/ft; Number of geologic cards: \_\_\_\_\_

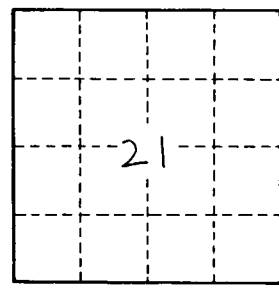
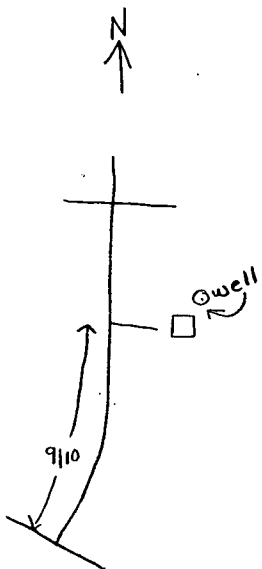

Well No. J197