

WRD Exp. (GW)  
April 1966

Well No. J182

### WELL SCHEDULE

U. S. DEPT. OF THE INTERIOR

GEOLOGICAL SURVEY

WATER RESOURCES DIVISION

#### MASTER CARD

Record by PEGRET Source of data Owner Date 4-23-63 Map \_\_\_\_\_

State 28 County (or town) 37

Latitude: 310829<sup>N</sup> Longitude: 0893902<sup>W</sup> Sequential number: 1

Lat-long accuracy: 3<sup>deg</sup> 2<sup>min</sup> 16<sup>sec</sup> T. 2 S. R. 16 E. Sec 18, NW NW

Local well number: J182B802N16W Other number: 118-1 B & M

Local use: 038 Owner or name: \_\_\_\_\_

Owner or name: WILLIE MAY Address: \_\_\_\_\_

Ownership: County, Fed Gov't, City, Corp or Co, Private, State Agency, Water Dist P

Use of water: (A) Air cond, (B) Bottling, (C) Comm, (D) Dewater, (E) Power, (F) Fire, (G) Dom, (H) Irr, (I) Med, (J) P S, (K) Rec, (L) Stock, (M) Instit, (N) Unused, (O) Repressure, (P) Recharge, (Q) Desal-P S, (R) Desal-other H

Use of well: (A) Anode, (B) Drain, (C) Seismic, (D) Heat Res, (E) Obs, (F) Oil-gas, (G) Recharge, (H) Test, (I) Unused, (J) Withdraw, (K) Waste, (L) Destroyed W

DATA AVAILABLE: Well data  Freq. W/L meas.:  Field aquifer char.

Hyd. lab. data:

Qual. water data; type:

Freq. sampling:  Pumpage inventory: yes  no, period:

Aperture cards:  yes

Log data:

#### WELL-DESCRIPTION CARD

SAME AS ON MASTER CARD Depth well: 318 Meas. rept 6

Depth cased: (first perf.) \_\_\_\_\_ ft Casing type: galv. Diam. 1/4 in

Finish: (C) porous concrete, (F) gravel w. (perf.), (G) gravel w. (screen), (H) horiz. gallery, (I) open end, (J) open perf., (K) screen, (L) sd. pt., (M) shored, (N) open hole, (O) other H

Method: (A) air rot, (B) bored, (C) cable, (D) dug, (E) hyd jetted, (F) air rot., (G) percussion, (H) rotary, (I) reverse, (J) trenching, (K) driven, (L) drive wash, (M) other H

Date Drilled: 960 Pump intake setting: \_\_\_\_\_ ft

Driller: Dean Shiner, Columbia

Lift (type): (A) air, (B) bucket, (C) cent, (D) jet, (E) multiple, (F) multiple, (G) none, (H) piston, (I) rot, (J) submerg, (K) turb, (L) other J Deep  Shallow

Power (type): (A) diesel, (B) elec, (C) gas, (D) gasoline, (E) hand, (F) gas, (G) wind, (H) H.P., (I) LP, (J) other 5 Trans. or meter no. 1/2

Descrip. MP \_\_\_\_\_ ft above LSD, Alt. MP \_\_\_\_\_

Alt. LSD: \_\_\_\_\_ Accuracy: (source) \_\_\_\_\_

Water Level: \_\_\_\_\_ ft above MP; \_\_\_\_\_ ft below LSD Accuracy: \_\_\_\_\_

Date meas: \_\_\_\_\_ Yield: \_\_\_\_\_ gpm Method determined \_\_\_\_\_

Drawdown: \_\_\_\_\_ ft Accuracy: \_\_\_\_\_ Pumping period \_\_\_\_\_ hrs

QUALITY OF WATER DATA: Iron \_\_\_\_\_ ppm Sulfate \_\_\_\_\_ ppm Chloride \_\_\_\_\_ ppm Hard. \_\_\_\_\_ ppm

Sp. Conduct \_\_\_\_\_ K x 10<sup>6</sup> Temp. \_\_\_\_\_ °F Date sampled \_\_\_\_\_

Taste, color, etc. Clear - some rust on pipes

PUNCHED and VERIFIED  
ROLLA COMPUTATION BRANCH

Well No. J182

J182

Well No. J182

Latitude-longitude N  
S  
d m s d m s

HYDROGEOLOGIC CARD

1 SAME AS ON MASTER CARD 19 Physiographic Province: 03 20 21 Section: \_\_\_\_\_

22 D Drainage Basin: 13V 23 25 Subbasin: \_\_\_\_\_ 26

Topo of well site: (D) depression, stream channel, dunes, flat, hilltop, sink, swamp, (C) (E) (F) (H) (K) (L) (P) (S) (T) (U) (V) offshore, pediment, hillside, terrace, undulating, valley flat \_\_\_\_\_ 27 F

MAJOR AQUIFER: \_\_\_\_\_ system \_\_\_\_\_ series TP 28 29 aquifer, formation, group CI 30 31

Lithology: \_\_\_\_\_ 32 33 Origin: 2 34 Aquifer Thickness: \_\_\_\_\_ ft

Length of well open to: \_\_\_\_\_ ft 35 37 38 40 Depth to top of: \_\_\_\_\_ ft 41 43

MINOR AQUIFER: \_\_\_\_\_ system \_\_\_\_\_ series \_\_\_\_\_ 44 45 aquifer, formation, group \_\_\_\_\_ 46 47

Lithology: \_\_\_\_\_ 48 49 Origin: \_\_\_\_\_ 50 Aquifer Thickness: \_\_\_\_\_ ft

Length of well open to: \_\_\_\_\_ ft 51 53 54 56 Depth to top of: \_\_\_\_\_ ft 57 59

Intervals Screened:

Depth to consolidated rock: \_\_\_\_\_ ft 60 61 63 Source of data: \_\_\_\_\_ 64

Depth to basement: \_\_\_\_\_ ft 65 66 68 Source of data: \_\_\_\_\_ 69

Surficial material: \_\_\_\_\_ 70 71 Infiltration characteristics: \_\_\_\_\_ 72

Coefficient Trans: \_\_\_\_\_ gpd/ft 73 75 Coefficient Storage: \_\_\_\_\_ 76 78

Coefficient Perm: \_\_\_\_\_ gpd/ft<sup>2</sup>; Spec cap: \_\_\_\_\_ gpm/ft; Number of geologic cards: \_\_\_\_\_ 79

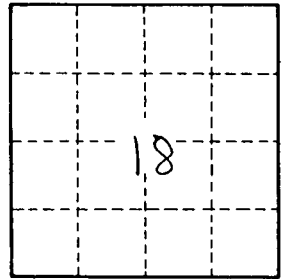
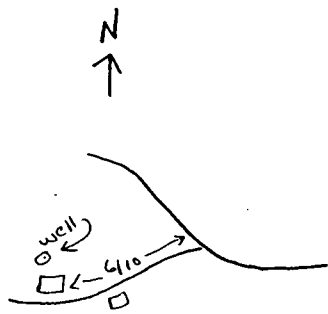

Well No. J182