

WELL SCHEDULE

U. S. DEPT. OF THE INTERIOR

GEOLOGICAL SURVEY

WATER RESOURCES DIVISION

MASTER CARD

Record by PEG+RET Source of data Owner Date 5-2-63 Map _____

State 28 County (or town) 37

Latitude: 31° 08' 10" N Longitude: 089° 37' 17" W Sequential number: 1

Lat-long accuracy: 3 T. 2 S. R. 16 Sec 17, SE & NE

Local well number: J181 DA170 2N 16W Other number: J17-2 B & M

Local use: _____ Owner or name: _____

Owner or name: FLOYD SMITH Address: _____

Ownership: County, Fed Gov't, City, Corp or Co, Private, State Agency, Water Dist P

Use of water: (A) Air cond, (B) Bottling, (C) Comm, (D) Dewater, (E) Power, (F) Fire, (H) Dom, (I) Irr, (M) Ind, (P) S, (R) Rec, (S) Stock, (T) Instit, (U) Unused, (V) Repressure, (W) Recharge, (X) Desal-P S, (Y) Desal-other, (Z) Other H

Use of well: (A) Anode, (D) Drain, (G) Seismic, (H) Heat Res, (Φ) Obs, (P) Oil-gas, (R) Recharge, (T) Test, (U) Unused, (W) Withdraw, (X) Waste, (Z) Destroyed W

DATA AVAILABLE: Well data Freq. W/L meas.: Field aquifer char.

Hyd. lab. data: _____

Qual. water data; type: _____

Freq. sampling: _____ Pumpage inventory: N yes/no, period: _____

Aperture cards: _____ yes

Log data: _____

WELL-DESCRIPTION CARD

SAME AS ON MASTER CARD Depth well: _____ ft 65 Meas. rept accuracy 6

Depth cased: _____ ft Casing type: _____; Diam. _____ in 2

Finish: (C) porous concrete, (F) gravel w. (perf.), (G) gravel w. (screen), (H) horiz. gallery, (Φ) open end, (P) perf., (S) screen, (T) sd. pt., (W) shored, (X) open hole, (Z) other B

Method Drilled: (A) air rot, (B) bored, (C) cable, (D) dug, (H) hyd rot., (J) jetted, (P) air percussion, (R) reverse, (T) trenching, (V) driven, (W) drive wash, (Z) other B

Date Drilled: 3/20 Pump intake setting: _____ ft _____

Driller: (?) name _____ address _____

Lift (type): (A) air, (B) bucket, (C) cent. jet, (J) multiple (cent.), (L) multiple (turb.), (M) none, (N) piston, (P) rot, (R) submerg, (S) turb, (T) other P Deep Shallow

Power (type): diesel, elec, nat gas, LP, gasoline, hand, gas, wind, H.P. 3/4 Trans. or meter no. 5

Descrip. MP _____ ft above _____ ft below LSD, Alt. MP _____

Alt. LSD: _____ Accuracy: (source) _____

Water Level _____ ft above _____ ft below MP; Ft below LSD _____ Accuracy: _____

Date meas: _____ Yield: _____ gpm _____ Method determined _____

Drawdown: _____ ft _____ Accuracy: _____ Pumping period _____ hrs _____

QUALITY OF WATER DATA: Iron _____ ppm Sulfate _____ ppm Chloride _____ ppm Hard. _____ ppm

Sp. Conduct _____ K x 10⁶ Temp. _____ °F Date sampled _____

Taste, color, etc. Clear

PUNCHED and VERIFIED
ROLLA COMPUTATION BRANCH

WELL NO. J181

Well No. J181

Latitude-longitude N
S
d m s d m s

HYDROGEOLOGIC CARD

SAME AS ON MASTER CARD Physiographic Province: 03 Section: _____

D Drainage Basin: 13V Subbasin: _____

Topo of well site: (D) depression, stream channel, dunes, flat, hilltop, sink, swamp, (P) offshore, pediment, hillside, terrace, undulating, valley flat _____

MAJOR AQUIFER: TP system _____ series _____ aquifer, formation, group CI

Lithology: S Origin: 2 Thickness: _____ ft

Length of well open to: _____ ft Depth to top of: _____ ft

MINOR AQUIFER: _____ system _____ series _____ aquifer, formation, group _____

Lithology: _____ Origin: _____ Thickness: _____ ft

Length of well open to: _____ ft Depth to top of: _____ ft

Intervals Screened: _____

Depth to consolidated rock: _____ ft Source of data: _____

Depth to basement: _____ ft Source of data: _____

Surficial material: _____ Infiltration characteristics: _____

Coefficient Trans: _____ gpd/ft² Coefficient Storage: _____

Coefficient Perm: _____ gpd/ft²; Spec cap: _____ gpm/ft; Number of geologic cards: _____

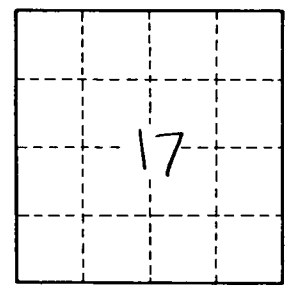
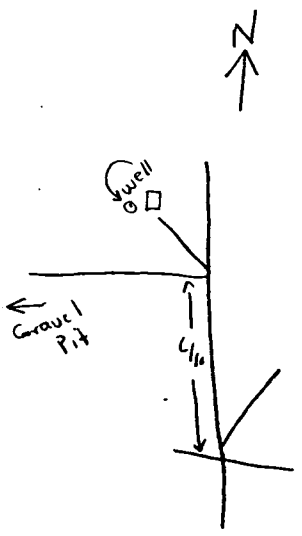

Well No. _____

J181