

WRD Exp. (GW)
April 1966

Well No. J177

WELL SCHEDULE

U. S. DEPT. OF THE INTERIOR

GEOLOGICAL SURVEY

WATER RESOURCES DIVISION

MASTER CARD

Record by PEG+RET Source of data owner Date 5-2-63 Map _____

State 28 County (or town) 37

Latitude: 31° 07' 41" N Longitude: 089° 37' 12" W Sequential number: 1

Lat-long accuracy: 3 T. 20 S. R. 16 E. Sec. 16 S.W. 1 S.W. 1

Local well number: J177C1602N16W Other number: J16-17

Local use: 038 Owner or name: _____

Owner or name: S. FAIRCHILD Address: _____

Ownership: County, Fed Gov't, City, Corp or Co, Private, State Agency, Water Dist P

Use of water: (A) Air cond, (B) Bottling, (C) Comm, (D) Dewater, (E) Power, (F) Fire, (G) Dom, (H) Irr, (I) Med, (J) Ind, (K) P S, (L) Rec, (M) Stock, (N) Instit, (O) Unused, (P) Repressure, (Q) Recharge, (R) Desal-P S, (S) Desal-other, (T) Other N

Use of well: (A) Anode, (B) Drain, (C) Seismic, (D) Heat Res, (E) Obs, (F) Oil-gas, (G) Recharge, (H) Test, (I) Unused, (J) Withdraw, (K) Waste, (L) Destroyed W

DATA AVAILABLE: Well data 0 Freq. W/L meas.: N Field aquifer char. 0

Hyd. lab. data: _____

Qual. water data; type: _____

Freq. sampling: _____ Pumpage inventory: N yes/no; period: _____

Aperture cards: _____ yes/no

Log data: _____

WELL-DESCRIPTION CARD

SAME AS ON MASTER CARD Depth well: 45 ft Meas. 6

Depth cased: (first perf.) 39 ft Casing type: galv.; Diam. 2 in

Finish: (C) concrete, (F) gravel w. (G) gravel w. (H) horiz. (I) open (J) screen, (K) gallery, (L) end, (M) perf., (N) screen, (O) sd. pt., (P) shored, (Q) open hole, (R) other S

Method Drilled: (A) air rot, (B) bored, (C) cable, (D) dug, (E) hyd jetted, (F) air rot., (G) percussion, (H) rotary, (I) reverse, (J) trenching, (K) driven, (L) drive wash, (M) other H

Date Drilled: 60 Pump intake setting: _____ ft

Driller: Dean Shiner Columbia

Lift (type): (A) air, (B) bucket, (C) cent., (D) jet., (E) multiple, (F) multiple, (G) none, (H) piston, (I) rot., (J) submerg, (K) turb., (L) other J Deep 0 Shallow 40

Power (type): (A) diesel, (B) elec, (C) gas, (D) gasoline, (E) hand, (F) gas, (G) wind, (H) H.P. 1/3 S Trans. or meter no. 41

Descrip. MP _____ ft above below LSD, Alt. MP _____

Alt. LSD: _____ Accuracy: (source) _____

Water Level _____ ft above below MP; _____ ft above below LSD Accuracy: _____

Date meas: _____ Yield: _____ gpm Method determined _____

Drawdown: _____ ft Accuracy: _____ Pumping period _____ hrs

QUALITY OF WATER DATA: Iron _____ ppm Sulfate _____ ppm Chloride _____ ppm Hard. _____ ppm

Sp. Conduct _____ K x 10⁶ Temp. _____ °F Date sampled _____

Taste, color, etc. Clear

PUNCHED and VERIFIED
ROLLA COMPUTATION BRANCH

Well No. J177

Well No. J177

Latitude-longitude N
S
d m s d m s

HYDROGEOLOGIC CARD

SAME AS ON MASTER CARD Physiographic Province: _____ Section: _____
19 20 21

D Drainage Basin: 15V Subbasin: _____
22 23 25 26

(D) depression, stream channel, dunes, flat, hilltop, sink, swamp,
Topo of well site: (O) (P) (S) (T) (U) (V) _____
offshore, pediment, hillside, terrace, undulating, valley flat 27

MAJOR AQUIFER: _____ system, _____ series TIP aquifer, formation, group CI
28 29 30 31

Lithology: _____ Origin: 2 Aquifer Thickness: _____ ft
3 Length of well open to: _____ ft 6 Depth to top of: _____ ft
32 33 34 35 37 38 41 43

MINOR AQUIFER: _____ system, _____ series _____ aquifer, formation, group _____
44 45 46 47

Lithology: _____ Origin: _____ Aquifer Thickness: _____ ft
_____ Length of well open to: _____ ft _____ Depth to top of: _____ ft
48 49 50 51 53 54 56 57 59

Intervals Screened: 39' 45'

Depth to consolidated rock: _____ ft _____ Source of data: _____
60 63 64

Depth to basement: _____ ft _____ Source of data: _____
65 68 69

Surficial material: _____ Infiltration characteristics: _____
70 71 72

Coefficient Trans: _____ gpd/ft _____ Coefficient Storage: _____
73 75 76 78

Coefficient Perm: _____ gpd/ft²; Spec cap: _____ gpm/ft; Number of geologic cards: _____
77 79

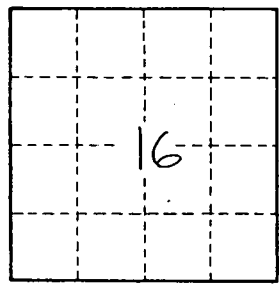
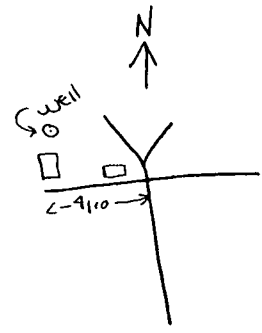

Well No. J177