

WRD Exp. (GW)
April 1966

Well No. J157

WELL SCHEDULE

U. S. DEPT. OF THE INTERIOR

GEOLOGICAL SURVEY

WATER RESOURCES DIVISION

PUNCHED and VERIFIED
ROLLA COMPUTATION BRANCH

MASTER CARD

Record by PEG Source of data tenant Date 9-17-64 Map _____

State 28 County (or town) 37

Latitude: 310955 N Longitude: 0893810 Sequential number: 1

Lat-long accuracy: 30 T. 20 S. R. 16 E. Sec 5, SW & NW

Local well number: J157CB0502N16W Other number: 159 B & M

Local use: _____ Owner or name: LUTNER SAUCIER Address: _____

Ownership: County, Fed Gov't, City, Corp or Co, Private, State Agency, Water Dist P

Use of water: (A) Air cond, Bottling, Comm, Dewater, Power, Fire, Dom, Irr, Med, Ind, P S, Rec, (S) Stock, Insitit, Unused, Repressure, Recharge, Desal-P S, Desal-other, Other H

Use of well: (A) Anode, Drain, Seismic, Heat Res, Obs, Oil-gas, Recharge, Test, Unused, Withdraw, Waste, Destroyed W

DATA AVAILABLE: Well data Freq. W/L meas.: Field aquifer char.

Hyd. lab. data:

Qual. water data; type:

Freq. sampling: _____ Pumpage inventory: yes, no, period: _____

Aperture cards: _____ yes

Log data: _____

WELL-DESCRIPTION CARD

SAME AS ON MASTER CARD Depth well: _____ ft Meas. accuracy _____

Depth cased: _____ ft Casing type: galv.; Diam. _____ in

Finish: (C) porous concrete, (F) gravel w. (perf.), (G) gravel w. (screen), (H) horiz. gallery, (Ø) open end, (P) open perf., (S) screen, (T) sd. pt., (W) shored, (X) open hole, (Z) other _____

Method Drilled: (A) air bored, (B) cable, (C) dug, (D) hyd rot., (H) jetted, (J) air rot., (P) percussion, (R) reverse, (T) rotary, (V) driven, (W) wash, (Z) other _____

Date Drilled: _____ Pump intake setting: _____ ft

Driller: _____ name _____ address _____

Lift (type): (A) air, (B) bucket, (C) cent., (J) jet, (L) multiple (cent.), (M) multiple (turb.), (N) none, (P) piston, (R) rot., (S) submerg, (T) turb, other _____ Deep Shallow

Power (type): (nat) diesel, (elec) gas, gasoline, hand, gas, wind; (LP) H.P. Trans. or meter no. _____

Descrip. MP _____ ft above _____ below LSD, Alt. MP _____

Alt. LSD: _____ Accuracy: (source) _____

Water Level: _____ ft above _____ below MP; _____ ft above _____ below LSD Accuracy: _____

Date meas: _____ Yield: _____ gpm Method determined _____

Drawdown: _____ ft Accuracy: _____ Pumping period _____ hrs

QUALITY OF WATER DATA: Iron _____ ppm Sulfate _____ ppm Chloride _____ ppm Hard. _____ ppm

Sp. Conduct _____ K x 10 _____ Temp. _____ °F Date sampled _____

Taste, color, etc. _____

Well No. J157

Well No. J157

Latitude-longitude _____
N
S
d m s d m s

HYDROGEOLOGIC CARD

SAME AS ON MASTER CARD Physiographic Province: 03 Section: _____

D Drainage Basin: 15V Subbasin: _____

Topo of well site: (D) depression, (C) stream channel, (E) dunes, (F) flat, (H) hilltop, (K) sink, (L) swamp, (Ø) offshore, (P) pediment, (S) hillside, (T) terrace, (U) undulating, (V) valley flat _____

MAJOR AQUIFER: _____ system _____ series _____ aquifer, formation, group _____

Lithology: _____ Origin: _____ Aquifer Thickness: _____ ft

Length of well open to: _____ ft Depth to top of: _____ ft

MINOR AQUIFER: _____ system _____ series _____ aquifer, formation, group _____

Lithology: _____ Origin: _____ Aquifer Thickness: _____ ft

Length of well open to: _____ ft Depth to top of: _____ ft

Intervals Screened: _____

Depth to consolidated rock: _____ ft Source of data: _____

Depth to basement: _____ ft Source of data: _____

Surficial material: _____ Infiltration characteristics: _____

Coefficient Trans: _____ gpd/ft Coefficient Storage: _____

Coefficient Perm: _____ gpd/ft²; Spec cap: _____ gpm/ft; Number of geologic cards: _____

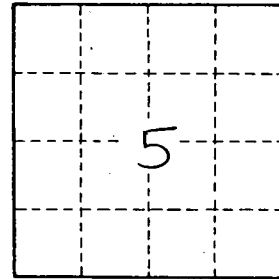
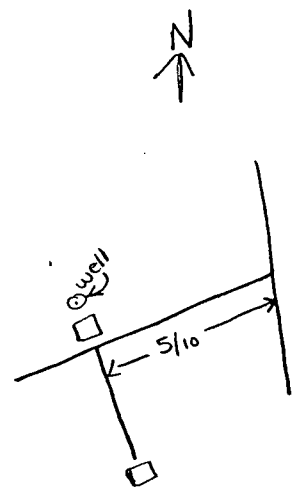

Well No. J157