

WELL SCHEDULE

U. S. DEPT. OF THE INTERIOR

GEOLOGICAL SURVEY

WATER RESOURCES DIVISION

MASTER CARD

Record by TNS+CA Source of data Tenant Mrs. JR CATT Date 1-30-61 Map

State 28 County (or town) 37

Latitude: 310954N Longitude: 0893348 Sequential number: 1

Lat-long accuracy: 3 T. 2 S. R 16 Sec 1 NE t. CT t.

Local well number: J140 Other number: J12

Local use: _____ Owner or name: JR CATT Tenant

Owner or name: EDITH HICKMAN Address: Gulfport, Miss

Ownership: (C) County, Fed Gov't, City, Corp or Co, Private, State Agency, Water Dist P

Use of water: (A) Air cond, Bottling, Comm, Dewater, Power, Fire, Dom, Irr, Med, Ind, P S, Rec, (S) Stock, Instit, Unused, Repressure, Recharge, Desal-P S, Desal-other, Other H

Use of well: (A) Anode, Drain, Seismic, Heat Res, Obs, Oil-gas, Recharge, Test, Unused, Withdraw, Waste, Destroyed W

DATA AVAILABLE: Well data N Freq. W/L meas.: _____ Field aquifer char. _____

Hyd. lab. data: _____

Qual. water data; type: _____

Freq. sampling: _____ Pumpage inventory: _____

Aperture cards: _____

Log data: _____

WELL-DESCRIPTION CARD

SAME AS ON MASTER CARD Depth well: 50 Meas. rept accuracy _____

Depth cased: _____ Casing type: _____ Diam. _____

Finish: (C) porous concrete, (F) gravel w. (perfor.), (G) gravel w. (screen), (H) horiz. gallery, (P) open perf., (S) screen, (T) sd. pt., (W) shored, (X) open hole, (Z) other _____

Method Drilled: (A) air rot, (B) bored, (C) cable, (D) dug, (H) hyd rot., (J) jetted, (P) air percussion, (R) reverse, (T) trenching, (V) driven, (W) drive wash, (Z) other H

Date Drilled: _____ Pump intake setting: _____

Driller: _____

Lift (type): (A) air, (B) bucket, (C) cent, (J) multiple, (L) multiple, (M) multiple, (N) none, (P) piston, (R) rot, (S) submerg, (T) turb, other J Deep _____ Shallow _____

Power (type): diesel elec gas, gasoline, hand, gas, wind; H.P. 1/2 Trans. or meter no. 5

Descrip. MP _____ above ft below LSD. Alt. MP _____

Alt. LSD: _____ Accuracy: (source) _____

Water Level _____ above ft below MP; _____ above ft below LSD Accuracy: _____

Date meas: _____ Yield: _____ gpm _____ Method determined _____

Drawdown: _____ ft _____ Accuracy: _____ Pumping period _____ hrs _____

QUALITY OF WATER DATA: Iron _____ ppm Sulfate _____ ppm Chloride _____ ppm Hard. _____ ppm

Sp. Conduct _____ K x 10⁶ Temp. _____ °F Date sampled _____

Taste, color, etc. Red color

PUNCHED and VERIFIED
ROLLA COMPUTATION BRANCH

Well No.

J140

Latitude-longitude N
S
d m s d m s

HYDROGEOLOGIC CARD

SAME AS ON MASTER CARD Physiographic Province: 03 Section: _____

D Drainage Basin: 13V Subbasin: _____

Topo of well site: (D) depression, stream channel, dunes, flat, hilltop, sink, swamp, (Ø) offshore, pediment, hillside, terrace, undulating, valley flat

MAJOR AQUIFER: TP aquifer, formation, group CI

Lithology: S Origin: 2 Aquifer Thickness: _____ ft

Length of well open to: _____ ft **Depth to top of:** _____ ft

MINOR AQUIFER: _____ aquifer, formation, group _____

Lithology: _____ Origin: _____ Aquifer Thickness: _____ ft

Length of well open to: _____ ft **Depth to top of:** _____ ft

Intervals Screened:

Depth to consolidated rock: _____ ft Source of data: _____

Depth to basement: _____ ft Source of data: _____

Surficial material: _____ Infiltration characteristics: _____

Coefficient Trans: _____ gpd/ft **Coefficient Storage:** _____

Coefficient Perm: _____ gpd/ft²; Spec cap: _____ gpm/ft; Number of geologic cards: _____

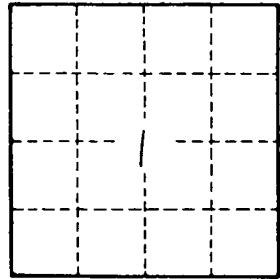
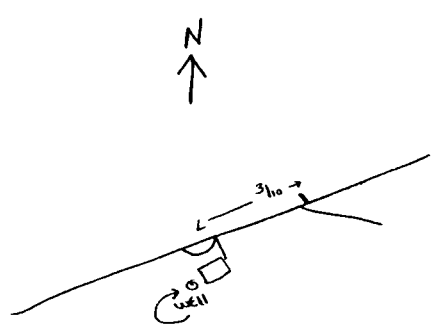

Well No. J140