

WELL SCHEDULE

U. S. DEPT. OF THE INTERIOR

GEOLOGICAL SURVEY

WATER RESOURCES DIVISION

MASTER CARD

Record by TNS Source of data OWNER Date 7-18-61 Map _____

State 28 County (or town) 37

Latitude: 310946 N Longitude: 0893803 Sequential number: 7

Lat-long accuracy: 30 T. 2 S. R. 16 Sec 5, NW 1/4, SW 1/4

Local well number: J0668C0502N16W Other B & M number: AEC#J5-3

Local use: XIII Owner or name: _____

Owner or name: RUFUS SAUCIER Address: R#4, Lumberton

Ownership: County, Fed Gov't, City, Corp or Co, Private, State Agency, Water Dist P

Use of water: (A) Air cond, (B) Bottling, (C) Comm, (D) Dewater, (E) Power, (F) Fire, (G) Dom, (H) Irr, (I) Med, (M) Ind, (P) S, (R) Rec, (S) Stock, (T) Instit, (U) Unused, (V) Recharge, (W) Desal-P S, (X) Desal-other, (Y) Other H

Use of well: (A) Anode, (D) Drain, (G) Seismic, (H) Heat Res, (φ) Obs, (P) Oil-gas, (R) Recharge, (T) Test, (U) Unused, (W) Withdraw, (X) Waste, (Z) Destroyed W

DATA AVAILABLE: Well data Freq. W/L meas.: Field aquifer char.

Hyd. lab. data: _____

Qual. water data; type: USGS Complete

Freq. sampling: Pumpage inventory: no, period: _____

Aperture cards: _____

Log data: _____

PUNCHED and VERIFIED
ROLLA COMPUTATION BRANCH

WELL-DESCRIPTION CARD

SAME AS ON MASTER CARD Depth well: _____ ft 225 Meas. rept accuracy 6

Depth cased: (first perf.) _____ ft 221 Casing type: galv.; Diam. _____ in 2

Finish: (C) porous concrete, (F) gravel w. (perf.), (G) gravel w. (screen), (H) horiz. gallery, (φ) open end, (P) perf., (S) screen, (T) sd. pt., (W) shored, (X) open hole, (Z) other P

Method: (A) air bored, (B) cable, (C) dug, (D) hyd rot., (H) jetted, (J) air percussion, (P) reverse, (R) trenching, (T) driven, (V) drive wash, (W) other H

Date Drilled: 960 Pump intake setting: _____ ft _____

Driller: Columbia Plumbing, Columbia

Lift (type): (A) air, (B) bucket, (C) cent, (J) jet, (L) multiple, (M) multiple, (N) none, (P) piston, (R) rot, (S) submerg, (T) turb, (Z) other J Deep Shallow

Power (type): (nat) diesel, elec, gas, gasoline, hand, gas, wind; (LP) H.P. 3/4 Trans. or meter no. 5

Descrip. MP _____ ft above LSD, Alt. MP _____

Alt. LSD: _____ Accuracy: (source) _____

Water Level: _____ ft above MP; RE below LSD 65 Accuracy: _____

Date meas: 761 Yield: _____ gpm _____ Method determined _____

Drawdown: _____ ft _____ Accuracy: _____ Pumping period _____ hrs _____

QUALITY OF WATER DATA: Iron _____ ppm Sulfate _____ ppm Chloride _____ Hard. _____

Sp. Conduct _____ K x 10⁶ Temp. _____ °F _____ Date sampled _____

Taste, color, etc. _____

Well No. J66

Well No. J66

Latitude-longitude _____
N
S
d m s d m s

HYDROGEOLOGIC CARD

SAME AS ON MASTER CARD 03 Section: _____
19 20 21

D Drainage Basin: 13Y Subbasin: _____
22 23 25 26

Topo of well site: (D) depression, (C) stream channel, (E) dunes, (F) flat, (H) hilltop, (K) sink, (L) swamp, (Ø) offshore, (P) pediment, (S) hillside, (T) terrace, (U) undulating, (V) valley flat
S

MAJOR AQUIFER: _____ system _____ series TM _____ aquifer, formation, group MZ
28 29 30 31

Lithology: _____ Origin: 3 Aquifer Thickness: _____ ft
32 33 34

Length of well open to: _____ ft 4 Depth to top of: _____ ft
35 37 38 40 41 43

MINOR AQUIFER: _____ system _____ series _____ aquifer, formation, group _____
44 45 46 47

Lithology: _____ Origin: _____ Aquifer Thickness: _____ ft
48 49 50

Length of well open to: _____ ft _____ Depth to top of: _____ ft
51 53 54 56 57 59

Intervals Screened: 221' - 225'

Depth to consolidated rock: _____ ft _____ Source of data: _____
60 63 64

Depth to basement: _____ ft _____ Source of data: _____
65 68 69

Surficial material: _____ Infiltration characteristics: _____
70 71 72

Coefficient Trans: _____ gpd/ft _____ Coefficient Storage: _____
73 75 76 78

Coefficient Perm: _____ gpd/ft²; Spec cap: _____ gpm/ft; Number of geologic cards: _____
79

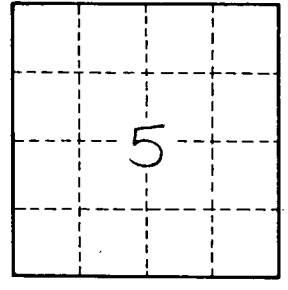
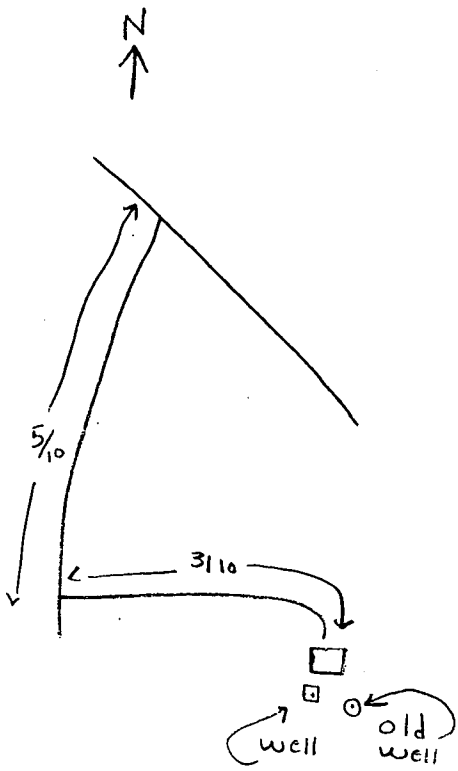

Well No.