

WELL SCHEDULE

U. S. DEPT. OF THE INTERIOR

GEOLOGICAL SURVEY

WATER RESOURCES DIVISION

MASTER CARD

Record by TNS Source of data OWNER Date 7-18-61 Map \_\_\_\_\_

State 28 County (or town) 37

Latitude: 31<sup>deg</sup> 09<sup>min</sup> 28<sup>sec</sup> N Longitude: 089<sup>degrees</sup> 37<sup>min</sup> 19<sup>sec</sup> Sequential number: 1

Lat-long accuracy: 2<sup>T.</sup> 2<sup>S.</sup> 16<sup>R</sup> 5<sup>Sec</sup> SE<sup>SE</sup> SE<sup>SE</sup>

Local well number: J065DD0502N16W Other number: AEC # J52

Local use: 000 Owner or name: PERRY LEE Address: Rt #4, Lumberton

Ownership: County, Fed Gov't, City, Corp or Co, Private, State Agency, Water Dist P

Use of water: (A) Air cond, (B) Bottling, (C) Comm, (D) Dewater, (E) Power, (F) Fire, (G) Dom, (H) Irr, (I) Med, (J) P S, (K) Rec, (L) Stock, (M) Instit, (N) Unused, (O) Repressure, (P) Recharge, (Q) Desal-P S, (R) Desal-other, (S) Other H

Use of well: (A) Anode, (B) Drain, (C) Seismic, (D) Heat Res, (E) Obs, (F) Oil-gas, (G) Recharge, (H) Test, (I) Unused, (J) Withdraw, (K) Waste, (L) Destroyed W

DATA AVAILABLE: Well data 0 Freq. W/L meas.: 0 Field aquifer char. 0

Hyd. lab. data: \_\_\_\_\_

Qual. water data; type: \_\_\_\_\_

Freq. sampling: N Pumpage inventory: yes \_\_\_\_\_ no: period: \_\_\_\_\_

Aperture cards: \_\_\_\_\_ yes \_\_\_\_\_

Log data: \_\_\_\_\_

WELL-DESCRIPTION CARD

SAME AS ON MASTER CARD Depth well: \_\_\_\_\_ ft 25 Meas. rept accuracy 6

Depth cased: (first perf.) \_\_\_\_\_ ft 21 Casing type: \_\_\_\_\_; Diam. \_\_\_\_\_ in 1

Finish: (C) porous concrete, (F) gravel w. (perf.), (G) gravel w. (screen), (H) horiz. gallery, (I) open end, (J) other P

Method: (A) air bored, (B) cable, (C) dug, (D) hyd rot., (E) air percussion, (F) air reverse, (G) air trenching, (H) driven, (I) wash, (J) other B

Date Drilled: 961 Pump intake setting: \_\_\_\_\_ ft \_\_\_\_\_

Driller: OWNER

Lift (type): (A) air, (B) bucket, (C) cent, (D) jet, (E) multiple, (F) multiple, (G) none, (H) piston, (I) rot, (J) submerg, (K) turb, (L) other J Deep 0 Shallow \_\_\_\_\_

Power (type): diesel, (elec) gas, gasoline, hand, gas, wind; H.P. 1/2 Trans. or meter no. 5

Descrip. MP \_\_\_\_\_ ft above below LSD, Alt. MP \_\_\_\_\_

Alt. LSD: \_\_\_\_\_ Accuracy: (source) \_\_\_\_\_

Water Level: \_\_\_\_\_ ft above below MP; Ft below LSD 19 Accuracy: \_\_\_\_\_

Date meas: 761 Yield: \_\_\_\_\_ gpm \_\_\_\_\_ Method determined \_\_\_\_\_

Drawdown: \_\_\_\_\_ ft \_\_\_\_\_ Accuracy: \_\_\_\_\_ Pumping period \_\_\_\_\_ hrs \_\_\_\_\_

QUALITY OF WATER DATA: Iron \_\_\_\_\_ ppm \_\_\_\_\_ Sulfate \_\_\_\_\_ ppm \_\_\_\_\_ Chloride \_\_\_\_\_ ppm \_\_\_\_\_ Hard. \_\_\_\_\_ ppm \_\_\_\_\_

Sp. Conduct \_\_\_\_\_ K x 10<sup>6</sup> \_\_\_\_\_ Temp. \_\_\_\_\_ °F 72 Date sampled \_\_\_\_\_

Taste, color, etc. \_\_\_\_\_

PUNCHED and VERIFIED  
ROLLA COMPUTATION BRANCH

Well No. J65

Well No. J65

Latitude-longitude N  
S  
d m s d m s

HYDROGEOLOGIC CARD

19 SAME AS ON MASTER CARD Physiographic Province: 03 Section: \_\_\_\_\_

22 D Drainage Basin: 13Y Subbasin: \_\_\_\_\_

27 H  
 (D) depression, (C) stream channel, (E) dunes, (F) flat, (H) hilltop, (K) sink, (L) swamp,  
 (Ø) offshore, (P) pediment, (S) hillside, (T) terrace, (U) undulating, (V) valley flat

MAJOR AQUIFER: system \_\_\_\_\_ series TP aquifer, formation, group CI

Lithology: \_\_\_\_\_ Origin: 2 Aquifer Thickness: \_\_\_\_\_ ft

35 \_\_\_\_\_ Length of well open to: \_\_\_\_\_ ft 38 4 Depth to top of: \_\_\_\_\_ ft 41 \_\_\_\_\_ 43

MINOR AQUIFER: system \_\_\_\_\_ series \_\_\_\_\_ aquifer, formation, group \_\_\_\_\_

Lithology: \_\_\_\_\_ Origin: \_\_\_\_\_ Aquifer Thickness: \_\_\_\_\_ ft

51 \_\_\_\_\_ Length of well open to: \_\_\_\_\_ ft 54 \_\_\_\_\_ Depth to top of: \_\_\_\_\_ ft 57 \_\_\_\_\_ 59

Intervals Screened: 21' - 25'

Depth to consolidated rock: \_\_\_\_\_ ft 60 \_\_\_\_\_ 63 Source of data: \_\_\_\_\_ 64

Depth to basement: \_\_\_\_\_ ft 65 \_\_\_\_\_ 68 Source of data: \_\_\_\_\_ 69

Surficial material: \_\_\_\_\_ 70-71 Infiltration characteristics: \_\_\_\_\_ 72

Coefficient Trans: \_\_\_\_\_ gpd/ft 73 \_\_\_\_\_ 75 Coefficient Storage: \_\_\_\_\_ 76 \_\_\_\_\_ 78

Coefficient Perm: \_\_\_\_\_ gpd/ft<sup>2</sup>; Spec cap: \_\_\_\_\_ gpm/ft; Number of geologic cards: \_\_\_\_\_ 79

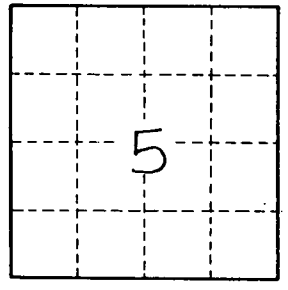
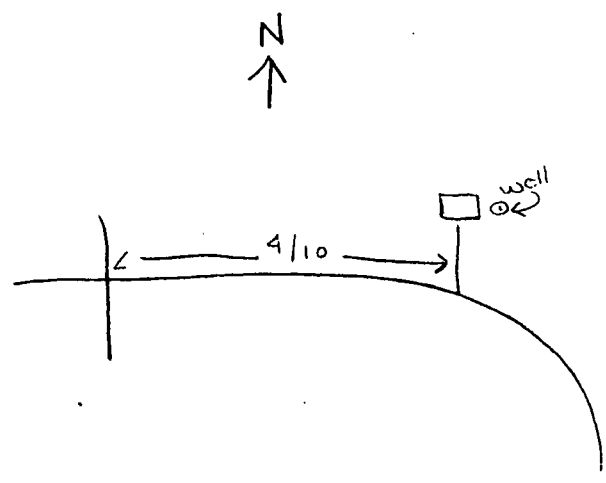

Well No. \_\_\_\_\_