

WELL SCHEDULE

U. S. DEPT. OF THE INTERIOR

GEOLOGICAL SURVEY

WATER RESOURCES DIVISION

PUNCHED and VERIFIED
ROLLA COMPUTATION BRANCH

MASTER CARD

Record by TNS Source of data Owner Date 2-14-61 Map _____

State 09 County 28 (or town) _____ Sequential number: 37

Latitude: 31 10 48 N Longitude: 08 9 36 32 Sequential number: 1

Lat-long accuracy: 3 T. 20 S, R 16 Sec 4, NW SE

Local well number: J0558D0402N16W Other number: AEC# J4-3

Local use: 038 Owner or name: HERMAN GIBSON Address: Rt#4, Lumberton

Ownership: County, Fed Gov't, City, Corp or Co, Private, State Agency, Water Dist P

Use of water: (A) Air cond, (B) Bottling, (C) Comm, (D) Dewater, (E) Power, (F) Fire, (H) Dom, (I) Irr, (M) Ind, (P) S, (R) Rec, (S) Stock, (T) Instit, (U) Unused, (V) Reppure, (W) Recharge, (X) Desal-P S, (Y) Desal-other, (Z) Other H

Use of well: (A) Anode, (D) Drain, (G) Seismic, (H) Heat Res, (P) Obs, (R) Oil-gas, (T) Recharge, (U) Test, (W) Unused, (X) Withdraw, (Y) Waste, (Z) Destroyed W

DATA AVAILABLE: Well data Freq. W/L meas.: Field aquifer char.

Hyd. lab. data: _____

Qual. water data; type: _____

Freq. sampling: N Pumpage inventory: yes no, period: _____

Aperture cards: _____ yes

Log data: _____

WELL-DESCRIPTION CARD

SAME AS ON MASTER CARD Depth well: _____ ft 1185 Meas. rept accuracy 6

Depth cased: (first perf.) _____ ft Casing type: galv. ; Diam. _____ in

Finish: (C) porous concrete, (F) gravel w. (perf.), (G) gravel w. (screen), (H) horiz. gallery, (P) open perf., (S) screen, (T) sd. pt., (W) shored, (X) open hole, (Z) other H

Method: (A) air rot, (B) bored, (C) cable, (D) dug, (H) hyd rot., (J) jetted, (P) air percussion, (R) reverse, (T) trenching, (U) driven, (V) wash, (W) drive wash, (Z) other H

Date Drilled: 956 Pump intake setting: _____ ft

Driller: Dean Shiner, Columbia

Lift (type): (A) air, (B) bucket, (C) cent, (J) jet, (L) multiple, (M) multiple, (N) none, (P) piston, (R) rot, (S) submerg, (T) turb, other J Deep Shallow

Power (type): (nat) diesel, elec, gas, gasoline, hand, gas, wind; (LP) H.P. 1/2 S Trans. or meter no. _____

Descrip. MP _____ ft above below LSD, Alt. MP _____

Alt. LSD: _____ Accuracy: (source) _____

Water Level: _____ ft above below MP; _____ ft above below LSD 40 Accuracy: _____

Date meas: 56 Yield: _____ gpm Method determined _____

Drawdown: _____ ft Accuracy: _____ Pumping period _____ hrs

QUALITY OF WATER DATA: Iron _____ ppm Sulfate _____ ppm Chloride _____ ppm Hard. _____ ppm

Sp. Conduct _____ K x 10⁶ Temp. _____ °F Date sampled _____

Taste, color, etc. _____

Well No. J55

Latitude-longitude N
S
d m s d m s

HYDROGEOLOGIC CARD

SAME AS ON MASTER CARD Physiographic Province: 03 Section: _____

D Drainage Basin: 13V Subbasin: _____

Topo of well site: (D) depression, stream channel, dunes, flat, hilltop, sink, swamp, (P) offshore, pediment, hillside, terrace, undulating, valley flat

MAJOR AQUIFER: T.M system, series _____ aquifer, formation, group MZ

Lithology: U.S Origin: 3 Aquifer Thickness: _____ ft
Length of well open to: _____ ft Depth to top of: _____ ft

MINOR AQUIFER: _____ system, series _____ aquifer, formation, group _____

Lithology: _____ Origin: _____ Aquifer Thickness: _____ ft
Length of well open to: _____ ft Depth to top of: _____ ft

Intervals Screened: _____

Depth to consolidated rock: _____ ft Source of data: _____

Depth to basement: _____ ft Source of data: _____

Surficial material: _____ Infiltration characteristics: _____

Coefficient Trans: _____ gpd/ft Coefficient Storage: _____

Coefficient Perm: _____ gpd/ft²; Spec cap: _____ gpm/ft; Number of geologic cards: _____

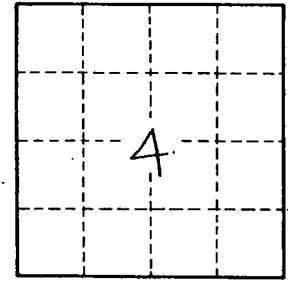
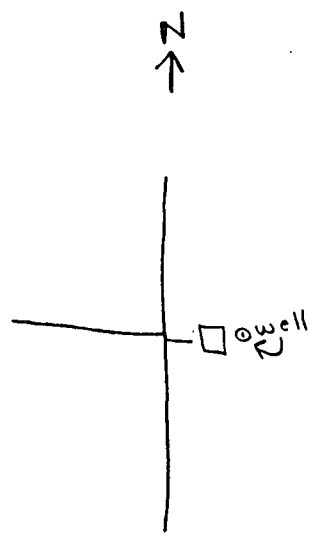

Well No. J55