

WELL SCHEDULE

U. S. DEPT. OF THE INTERIOR

GEOLOGICAL SURVEY

WATER RESOURCES DIVISION

PUNCHED and VERIFIED
ROLLA COMPUTATION BRANCH

MASTER CARD

Record by HBH+EJH Source of data 7. Madden Date 9-29-61 Map _____

State 28 County (or town) 37

Latitude: 311447 N Longitude: 0892946 Sequential number: 1

Lat-long accuracy: 3 T. 3 S. R. 15 E. Sec. 3, SE, SW

Local well number: G017DC0303N15W Other number: _____

Local use: UNK Owner or name: _____

Owner or name: REED BENNETT Address: Sumroll

Ownership: (C) County, (F) Fed Gov't, (M) City, (N) Corp or Co, (P) Private, (S) State Agency, (W) Water Dist P

Use of water: (A) Air cond, (B) Bottling, (C) Comm, (D) Dewater, (E) Power, (F) Fire, (H) Dam, (I) Irr, (M) Med, (N) Ind, (P) S, (R) Rec, (S) Stock, (T) Instit, (U) Unused, (V) Reppure, (W) Recharge, (X) Desal-P S, (Y) Desal-other, (Z) Other H

Use of well: (A) Anode, (D) Drain, (G) Seismic, (H) Heat Res, (I) Obs, (J) Oil-gas, (K) Recharge, (L) Test, (M) Unused, (N) Withdraw, (O) Waste, (P) Destroyed W

DATA AVAILABLE: Well data Freq. W/L meas.: Field aquifer char.

Hyd. lab. data: _____

Qual. water data; type: _____

Freq. sampling: N Pumpage inventory: no period: _____

Aperture cards: _____

Log data: _____

WELL-DESCRIPTION CARD

SAME AS ON MASTER CARD Depth well: 54 ft Meas. rept accuracy 6

Depth cased: (first perf.) 54 ft Casing type: Cement; Diam. 8 in

Finish: (C) porous concrete, (F) gravel w. (perf.), (G) gravel w. (screen), (H) horiz. gallery, (I) open end, (J) other, (K) perf., (L) screen, (M) sd. pt., (N) shored, (O) open hole, (P) other H

Method Drilled: (A) air bored, (B) cable, (C) dug, (D) hyd jetted, (E) air rot., (F) percussion, (G) rotary, (H) reverse, (I) trenching, (J) driven, (K) wash, (L) other H

Date Drilled: 952 Pump intake setting: _____ ft

Driller: Floyd Madden address Sumroll

Lift (type): (A) air, (B) bucket, (C) cent, (D) jet, (E) multiple, (F) multiple, (G) none, (H) piston, (I) rot, (J) submerg, (K) turb, (L) other B Deep 40 Shallow _____

Power (type): (A) diesel, (B) elec, (C) gas, (D) gasoline, (E) hand, (F) gas, (G) wind, (H) H.P. 41 Trans. or meter no. _____

Descrip. MP _____ ft above LSD. Alt. MP _____

Alt. LSD: _____ Accuracy: (source) _____

Water Level: _____ ft above MP; _____ ft below LSD Accuracy: _____

Date meas: 162 Yield: _____ gpm Method determined _____

Drawdown: _____ ft Accuracy: _____ Pumping period _____ hrs

QUALITY OF WATER DATA: Iron _____ ppm Sulfate _____ ppm Chloride _____ ppm Hard. _____ ppm

Sp. Conduct _____ K x 10⁶ Temp. _____ °F Date sampled _____

Taste, color, etc. _____

Well No. 617

Latitude-longitude N
S
d m s d m s

HYDROGEOLOGIC CARD

SAME AS ON MASTER CARD Physiographic Province: 03 Section: _____

D Drainage Basin: 11310 Subbasin: _____

(D) (C) (E) (F) (H) (K) (L)
 Topo of depression, stream channel, dunes, flat, hilltop, sink, swamp,
 well site: (Ø) (P) (S) (T) (U) (V) _____

offshore, pediment, hillside, terrace, undulating, valley flat _____

MAJOR AQUIFER: _____ **TIP** _____ **CI** _____

system _____ series _____ aquifer, formation, group _____

Lithology: _____ **US** **Origin:** _____ **3** **Aquifer Thickness:** _____ ft

Length of well open to: _____ ft **Depth to top of:** _____ ft

MINOR AQUIFER: _____ _____ _____

system _____ series _____ aquifer, formation, group _____

Lithology: _____ _____ **Origin:** _____ _____ **Aquifer Thickness:** _____ ft

Length of well open to: _____ ft **Depth to top of:** _____ ft

Intervals Screened:

Depth to consolidated rock: _____ ft _____ **Source of data:** _____

Depth to basement: _____ ft _____ **Source of data:** _____

Surficial material: _____ **Infiltration characteristics:** _____

Coefficient Trans: _____ gpd/ft _____ **Coefficient Storage:** _____

Perm: _____ gpd/ft²; Spec cap: _____ gpm/ft; **Number of geologic cards:** _____

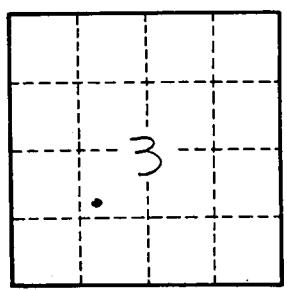
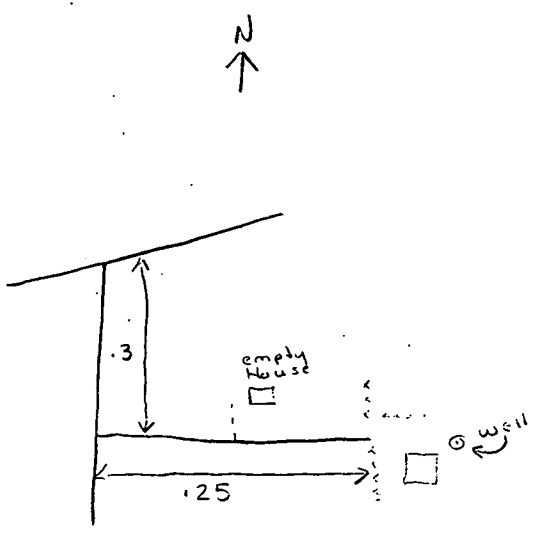

Well No.

C17