

WELL SCHEDULE

U. S. DEPT. OF THE INTERIOR

GEOLOGICAL SURVEY

WATER RESOURCES DIVISION

FUNCTIONED and VERIFIED  
ROLLA COMPUTATION BRANCH

MASTER CARD

Record by PEG+RET Source of data Obs+Tenent Date 5-3-63 Map

State Miss County Lamar (or town) 3:7

Latitude: 31 10 20 N Longitude: 08 9 36 32 Sequential number: 1

Lat-long accuracy: 3 T. 3 S. R. 16 Sec 33 SW SE

Local well number: F035CD3303N16W Other number: AEC F33-5

Local use: 126 Owner or name: T. B. Blankford

Owner or name: T B BLANKFORD Address:

Ownership: County, Fed Gov't, City, Corp or Co, Private, State Agency, Water Dist P

Use of Air cond, Bottling, Comm, Dewater, Power, Fire, Dom, Irr, Med, Ind, P S, Rec, water:

Stock, Instit, Unused, Repressure, Recharge, Desal-P S, Desal-other, Other H

Use of well: Anode, Drain, Seismic, Heat Res, Obs, Oil-gas, Recharge, Test, Unused, Withdraw, Waste, Destroyed W

DATA AVAILABLE: Well data  Freq. W/L meas.: N Field aquifer char.

Hyd. lab. data:

Qual. water data; type:

Freq. sampling: N Pumpage inventory: yes  no  period:

Aperture cards:

Log data:

WELL-DESCRIPTION CARD

SAME AS ON MASTER CARD Depth well: 380 ft 380 Meas. accuracy 6

Depth cased: (first perf.) ft  Casing Type:  Diam. 2 in 2

Finish: porous concrete, gravel w. (perf.), gravel w. (screen), horiz. gallery, open end, perf., screen, sd. pt., shored, open hole, other H

Method Drilled: air rot, bored, cable, dug, hyd. jetted, air percussion, rotary, reverse trenching, driven, drive wash, other H

Date Drilled: 1955 9:55 Pump intake setting: ft

Driller: Cobanessa Purvis name address

Lift (type): air, bucket, cent, jet, multiple (cent.), multiple (turb.), none, piston, rot, submerg, turb, other P Deep  Shallow

Power (type): diesel, nat, gas, gasoline, hand, gas, wind; H.P. 1/2 S Trans. or meter no.

Descrip. MP  ft above LSD. Alt. MP  ft below LSD. Alt. MP

Alt. LSD:  Accuracy: (source)

Water Level:  ft above MP;  ft below LSD Accuracy:  Method:

Date meas:  Yield:  gpm  Pumping period:  hrs

Drawdown:  ft Accuracy:  Pumping period:  hrs

QUALITY OF WATER DATA: Iron  ppm Sulfate  ppm Chloride  ppm Hard.

Sp. Conduct  K x 10  Temp.  Date sampled

Taste, color, etc.

Well No. F35

Latitude-longitude \_\_\_\_\_  
N  
S  
d m s d m s

HYDROGEOLOGIC CARD

1 SAME AS ON MASTER CARD 19 Physiographic Province: 0:3 20 21 Section: \_\_\_\_\_

22 Drainage Basin: D 23 Subbasin: 13 Y 24 \_\_\_\_\_

Topo of well site: (D) (C) (E) (F) (H) (K) (L) depression, stream channel, dunes, flat, hilltop, sink, swamp, (O) (P) (S) (T) (U) (V) offshore, pediment, hillside, terrace, undulating, valley flat 27 \_\_\_\_\_

MAJOR AQUIFER: \_\_\_\_\_ system \_\_\_\_\_ series TM 28 29 \_\_\_\_\_ aquifer, formation, group MZ 30 31

Lithology: \_\_\_\_\_ 32 Origin: S 33 Aquifer Thickness: 3 34 \_\_\_\_\_ ft

Length of well open to: \_\_\_\_\_ ft 35 37 Depth to top of: \_\_\_\_\_ ft 38 40 41 43

MINOR AQUIFER: \_\_\_\_\_ system \_\_\_\_\_ series \_\_\_\_\_ 44 45 \_\_\_\_\_ aquifer, formation, group \_\_\_\_\_ 46 47

Lithology: \_\_\_\_\_ 48 49 Origin: \_\_\_\_\_ 50 Aquifer Thickness: \_\_\_\_\_ ft

Length of well open to: \_\_\_\_\_ ft 51 53 Depth to top of: \_\_\_\_\_ ft 54 56 57 59

Intervals Screened: \_\_\_\_\_

Depth to consolidated rock: \_\_\_\_\_ ft 60 63 Source of data: \_\_\_\_\_ 64

Depth to basement: \_\_\_\_\_ ft 65 68 Source of data: \_\_\_\_\_ 69

Surficial material: \_\_\_\_\_ 70 71 Infiltration characteristics: \_\_\_\_\_ 72

Coefficient Trans: \_\_\_\_\_ gpd/ft 73 75 Coefficient Storage: \_\_\_\_\_ 76 78

Coefficient Perm: \_\_\_\_\_ gpd/ft<sup>2</sup>; Spec cap: \_\_\_\_\_ gpm/ft; Number of geologic cards: \_\_\_\_\_ 79

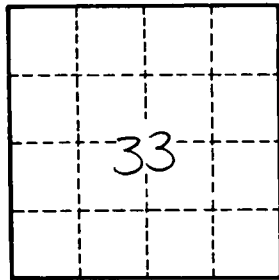
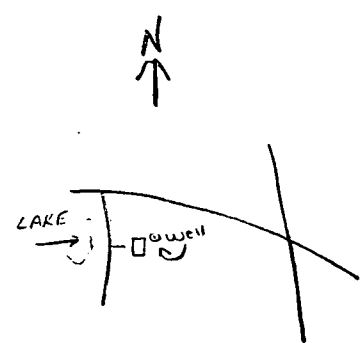

Well No. \_\_\_\_\_

F25