

WELL SCHEDULE

U. S. DEPT. OF THE INTERIOR

GEOLOGICAL SURVEY

WATER RESOURCES DIVISION

MASTER CARD

PUNCHED and VERIFIED  
ROLLA COMPUTATION BRANCH

Record by TNS Source of data Owner Date 8-21-61 Map \_\_\_\_\_

State Miss County 28 (or town) Lamar 37

Latitude: 31 11 0 2 N Longitude: 0 8 9 3 8 4 9 Sequential number: 1

Lat-long accuracy: 3 T. 3 S. R. 16 E. Sec 31 % NE % NW %

Local well number: F030AB3103N16W Other number: AEC F31-1

Local use: 038 Owner or name: L.R. Harvey

Owner or name: L R HARVEY Address: Lumberton

Ownership: County, Fed Gov't, City, Corp or Co, Private, State Agency, Water Dist \_\_\_\_\_ P

Use of water: (A) Air cond, Bottling, Power, Fire, Dom, Irr, Med, Ind, P S, Rec, (S) Stock, Instit, Unused, Repressure, Recharge, Desal-P S, Desal-other, Other \_\_\_\_\_ H

Use of well: (A) Anode, Drain, Seismic, Heat Res, Obs, Oil-gas, Recharge, Test, Unused, Withdraw, Waste, Destroyed \_\_\_\_\_ W

DATA AVAILABLE: Well data  Freq. W/L meas.:  Field aquifer char.

Hyd. lab. data: \_\_\_\_\_

Qual. water data; type: \_\_\_\_\_ P

Freq. sampling: \_\_\_\_\_ Pumpage inventory: no period: \_\_\_\_\_

Aperture cards: \_\_\_\_\_

Log data: \_\_\_\_\_

WELL-DESCRIPTION CARD

SAME AS ON MASTER CARD Depth well: 31 ft Meas. 31 rept accuracy \_\_\_\_\_

Depth cased: 26 ft Casing type: \_\_\_\_\_; Diam. 2 in

Finish: (C) porous concrete, (F) gravel w. concrete, (G) gravel w. (perf.), (H) horiz. gallery, (I) open end, (J) jetted, (K) air rot., (L) multiple, (M) multiple, (N) none, (O) piston, (P) rot., (R) submerg, (S) turb., (T) sd. pt., (U) shored, (V) open hole, (W) other \_\_\_\_\_ T

Method Drilled: (A) air, (B) bored, (C) cable, (D) dug, (E) hyd, (F) jetted, (G) air, (H) reverse, (I) percussive, (J) rotary, (K) other \_\_\_\_\_ H

Date Drilled: 1957 9:57 Pump intake setting: \_\_\_\_\_ ft

Driller: Dean Diner Columbia

Lift (type): (A) air, (B) bucket, (C) cent, (D) jet, (E) multiple, (F) multiple, (G) none, (H) piston, (I) rot, (J) submerg, (K) turb, (L) other \_\_\_\_\_ P Deep \_\_\_\_\_ Shallow \_\_\_\_\_

Power (type): (A) diesel, (B) elec, (C) gas, (D) gasoline, (E) hand, (F) gas, (G) wind, (H) H.P., (I) LP, (J) Trans. or meter no. \_\_\_\_\_ 5

Descrip. MP \_\_\_\_\_ ft above \_\_\_\_\_ ft below LSD. Alt. MP \_\_\_\_\_

Alt. LSD: \_\_\_\_\_ Accuracy: \_\_\_\_\_

Water Level: \_\_\_\_\_ ft above \_\_\_\_\_ ft below MP; \_\_\_\_\_ ft below LSD Accuracy: \_\_\_\_\_

Date meas: 5.7 Yield: \_\_\_\_\_ gpm Method: determined

Drawdown: \_\_\_\_\_ ft Accuracy: \_\_\_\_\_ Pumping period: \_\_\_\_\_ hrs

QUALITY OF WATER DATA: Iron \_\_\_\_\_ ppm Sulfate \_\_\_\_\_ ppm Chloride \_\_\_\_\_ ppm Hard. \_\_\_\_\_ ppm

Sp. Conduct \_\_\_\_\_ K x 10<sup>6</sup> Temp. \_\_\_\_\_ °F Date sampled \_\_\_\_\_

Taste, color, etc. \_\_\_\_\_

Well No. F30

Latitude-longitude \_\_\_\_\_  
N  
S  
d m s d m s

HYDROGEOLOGIC CARD

SAME AS ON MASTER CARD Physiographic Province: 03 Section: \_\_\_\_\_

Drainage Basin: D 131V Subbasin: \_\_\_\_\_

Topo of well site: (D) (C) (E) (P) (H) (K) (L) depression, stream channel, dunes, flat, hilltop, sink, swamp, (O) (P) (S) (T) (U) (V) offshore, pediment, hillside, terrace, undulating, valley flat 5

MAJOR AQUIFER: \_\_\_\_\_ system \_\_\_\_\_ series TP \_\_\_\_\_ aquifer, formation, group CI

Lithology: \_\_\_\_\_ 5 Origin: \_\_\_\_\_ 3 Aquifer Thickness: \_\_\_\_\_ ft

Length of well open to: \_\_\_\_\_ ft 5 Depth to top of: \_\_\_\_\_ ft

MINOR AQUIFER: \_\_\_\_\_ system \_\_\_\_\_ series \_\_\_\_\_ aquifer, formation, group \_\_\_\_\_

Lithology: \_\_\_\_\_ Origin: \_\_\_\_\_ Aquifer Thickness: \_\_\_\_\_ ft

Length of well open to: \_\_\_\_\_ ft \_\_\_\_\_ Depth to top of: \_\_\_\_\_ ft

Intervals Screened: 26' - 31'

Depth to consolidated rock: \_\_\_\_\_ ft \_\_\_\_\_ Source of data: \_\_\_\_\_

Depth to basement: \_\_\_\_\_ ft \_\_\_\_\_ Source of data: \_\_\_\_\_

Surficial material: \_\_\_\_\_ Infiltration characteristics: \_\_\_\_\_

Coefficient Trans: \_\_\_\_\_ gpd/ft \_\_\_\_\_ Coefficient Storage: \_\_\_\_\_

Coefficient Perm: \_\_\_\_\_ gpd/ft<sup>2</sup>; Spec cap: \_\_\_\_\_ gpm/ft; Number of geologic cards: \_\_\_\_\_

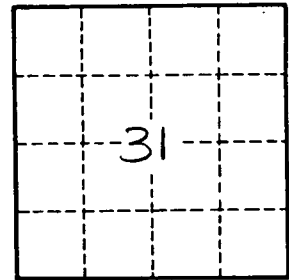
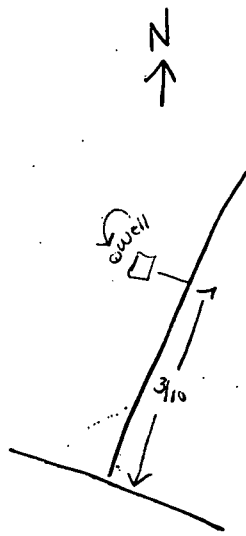

Well No. \_\_\_\_\_

F30