

WELL SCHEDULE

U. S. DEPT. OF THE INTERIOR

GEOLOGICAL SURVEY

WATER RESOURCES DIVISION
PUNCHED and VERIFIED
ROLLA COMPUTATION BRANCH

MASTER CARD

Record by HGH Source of data Mrs Kendrick's Date 10-5-61 Map _____

State 28 County (or town) 37

Latitude: 311536 N Longitude: 0092746 Sequential number: 1

Lat-long accuracy: 2 T. 4 S. R. 15 E. Sec 36, SW $\frac{1}{4}$, SE $\frac{1}{4}$, SW $\frac{1}{4}$

Local well number: D047DC3604N15W Other number: _____ B & M

Local use: UNK Owner or name: _____

Owner or name: L. WHITEHEAD Address: Hattiesburg

Ownership: County, Fed Gov't, City, Corp or Co, Private, State Agency, Water Dist _____ P

Use of water: (A) Air cond, Bottling, Comm, Dewater, Power, Fire, Dom, Irr, Med, Ind, P S, Rec, (S) Stock, Instit, Unused, Repressure, Recharge, Desal-P S, Desal-other, Other _____ H

Use of well: (A) Anode, Drain, Seismic, Heat Res, Obs, Oil-gas, Recharge, Test, Unused, Withdraw, Waste, Destroyed _____ W

DATA AVAILABLE: Well data Freq. W/L meas.: 0 Field aquifer char. _____

Hyd. lab. data: _____

Qual. water data; type: _____

Freq. sampling: _____ N Pumpage inventory: yes _____ no _____ period: _____

Aperture cards: _____ yes _____

Log data: _____

WELL-DESCRIPTION CARD

SAME AS ON MASTER CARD Depth well: _____ ft 60 Meas. rept accuracy _____ 6

Depth cased; (first perf.) _____ ft _____ Casing type: galv.; Diam. _____ in _____ 2

Finish: (C) porous concrete, (F) gravel w. (perf.), (G) gravel w. (screen), (H) horiz. gallery, (P) open end, (S) perf., (T) screen, (W) sd. pt., (X) shored, (Z) open hole, other _____ H

Method Drilled: (A) air rot, (B) bored, (C) cable, (D) dug, (H) hyd rot., (J) jetted, (P) air percussion, (R) reverse, (T) rotary, (V) trenching, (W) driven, (Z) drive wash, other _____ H

Date Drilled: _____ Pump intake setting: _____ ft _____

Driller: _____

Lift (type): (A) air, (B) bucket, (C) cent, (J) jet, (L) multiple, (M) multiple, (N) none, (P) piston, (R) rot, (S) submerg, (T) turb, (Z) other _____ P Deep _____ Shallow _____

Power (type): diesel, elec nat gas, gasoline, hand, gas, wind; H.P. 1/2 Trans. or meter no. 5

Descrip. MP _____ ft above _____ below LSD. Alt. MP _____

Alt. LSD: _____ Accuracy: (source) _____

Water Level _____ ft above _____ below MP; _____ ft above _____ below LSD 60 Accuracy: _____ 6

Date meas: 10-5-61 061 Yield: _____ gpm _____ Method determined _____

Drawdown: _____ ft _____ Accuracy: _____ Pumping period _____ hrs _____

QUALITY OF WATER DATA: Iron _____ ppm _____ Sulfate _____ ppm _____ Chloride _____ ppm _____ Hard. _____ ppm _____

Sp. Conduct _____ K x 10 6 Temp. _____ °F _____ Date sampled _____

Taste, color, etc. _____

Well No. D47

Well No. D47

CG 1987 Rev 08/1989
HYDROGEOLOGIC CARD

Latitude-Longitude N S
d m s d m s

SAME AS ON MASTER CARD Physiographic Province: 03 Section: _____

d Drainage Basin: 139 Subbasin: _____

(D) (C) (E) (F) (H) (K) (L)
Topo of depression, stream channel, dunes, flat, hilltop, sink, swamp,
well site: (Ø) (P) (S) (T) (U) (V)
offshore, pediment, hillside, terrace, undulating, valley flat _____ H

MAJOR AQUIFER: _____ system _____ series T P _____ aquifer, formation, group C I

Lithology: _____ U S Origin: _____ 3 Aquifer Thickness: _____ ft
Length of well open to: _____ ft _____ Depth to top of: _____ ft _____

MINOR AQUIFER: _____ system _____ series _____ aquifer, formation, group _____

Lithology: _____ _____ Origin: _____ _____ Aquifer Thickness: _____ ft
Length of well open to: _____ ft _____ Depth to top of: _____ ft _____

Intervals Screened: _____

Depth to consolidated rock: _____ ft _____ Source of data: _____

Depth to basement: _____ ft _____ Source of data: _____

Surficial material: _____ Infiltration characteristics: _____

Coefficient Trans: _____ gpd/ft _____ Coefficient Storage: _____

Coefficient Perm: _____ gpd/ft²; Spec cap: _____ gpm/ft; Number of geologic cards: _____

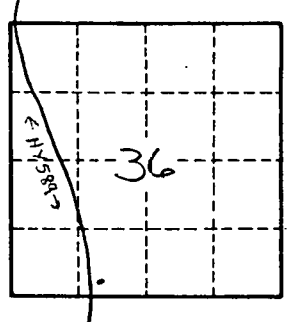

Well No. D47