

WELL SCHEDULE

Log 4
WATER RESOURCES DIVISION

U. S. DEPT. OF THE INTERIOR

GEOLOGICAL SURVEY

MASTER CARD

Record by PEG Source of data driller Obs Date 6/16/58 Map _____

State 28 County (or town) LAFAYETTE 36

Latitude: 34¹¹ 16⁴ 6⁶ N Longitude: 08⁹ 2⁹ 11¹ Sequential number: 7

Lat-long Accuracy: 2⁰ 9⁰ 3⁰ Sec 23, NW, SE, SW

Local well number: K001DC2309S03W Other number: _____ B & M

Local use: 079004 Owner or name: DON BLACK Address: _____

Ownership: County, Fed Gov't. City, Corp or Co, Private, State Agency, Water Dist _____ P

Use of Air cond, Bottling, Comm, Dewater, Power, Fire, Dom, Irr, Med, Ind, P S, Rec, _____

water: (S) (T) (U) (V) (W) (X) (Y) (Z) also chickens H

Use of (A) (D) (G) (H) (I) (J) (K) (L) (M) (N) (O) (P) (Q) (R) (S) (T) (U) (V) (W) (X) (Y) (Z)

well: Anode, Drain, Seismic, Heat Res, Obs, Oil-gas, Recharge, Test, Unused, Withdraw, Waste, Destroyed. W

DATA AVAILABLE: Well data Freq. W/L meas.: Field aquifer char.

Hyd. lab. data: _____

Qual. water data; type: USGS (1958)

Freq. sampling: Pumpage inventory: yes _____ no, period: _____

Aperture cards: _____ yes _____

Log data: to 500 ft _____

WELL-DESCRIPTION CARD

SAME AS ON MASTER CARD Depth well: ? ft 1600 Meas. rept accuracy 4

Depth cased: _____ ft _____ Casing type: _____; Diam. in _____

Finish: (C) porous concrete, (F) gravel w. (perf.), (G) gravel w. (screen), (H) horiz. gallery, (I) open end, (J) air bored, (K) cable, (L) lug, (M) hyd jetted, (N) air reverse, (O) percussion, (P) rotary, (Q) screen, (R) sd. pt., (S) shored, (T) open hole, (U) other _____

Method (A) (B) (C) (D) (E) (F) (G) (H) (I) (J) (K) (L) (M) (N) (O) (P) (Q) (R) (S) (T) (U) (V) (W) (X) (Y) (Z) H

Drilled: air bored, cable, lug, hyd jetted, air reverse, percussion, rotary, screen, sd. pt., shored, open hole, other _____

Date Drilled: 958 Pump intake setting: _____ ft _____

Driller: Red Hill and Ray Leeper

Lift (type): (A) air, (B) bucket, (C) cent, (D) jet, (E) multiple, (F) multiple, (G) none, (H) piston, (I) rot, (J) submerg, (K) turb, (L) other _____ Deep _____

Power (type): diesel, elec, gas, gasoline, hand, gas, wind; H.P. _____ Trans. or meter no. _____

Descrip. MP _____ ft above _____ below LSD, Alt. MP _____

Alt. LSD: 343 Accuracy: (source) _____

Water Level _____ ft above _____ below MP; _____ ft above _____ below LSD Accuracy: _____

Date meas: _____ Yield: _____ gpm _____ Method determined _____

Drawdown: _____ ft _____ Accuracy: _____ Pumping period _____ hrs _____

QUALITY OF WATER DATA: Iron _____ ppm Sulfate _____ ppm Chloride _____ ppm Hard. _____ ppm

Sp. Conduct _____ K x 10⁶ _____ Temp. _____ °F _____ Date sampled _____

Taste, color, etc. _____

PUNCHED and VERIFIED
ROLLA COMPUTATION BRANCH

Well No.

HYDROGEOLOGIC CARD

SAME AS ON MASTER CARD

Physiographic Province: _____

03 Section: _____

75F Subbasin: _____

D Drainage Basin: _____

Topo of well site: (D) depression, stream channel, dunes, flat, hilltop, sink, swamp, (E) (F) (H) (K) (L) (S) (T) (U) (V) offshore, pediment, hillside, terrace, undulating, valley flat

MAJOR AQUIFER: _____

system _____

series _____

K3

Origin: _____

aquifer, formation, group

3

Aquifer Thickness: _____

ft _____

Lithology: _____

Length of well open to: _____

S

ft _____

Depth to top of: _____

ft _____

MINOR AQUIFER: _____

system _____

series _____

ft _____

Origin: _____

aquifer, formation, group

ft _____

Aquifer Thickness: _____

ft _____

Lithology: _____

Length of well open to: _____

ft _____

Depth to top of: _____

ft _____

Intervals Screened: _____

ft _____

Source of data: _____

Depth to consolidated rock: _____

ft _____

Source of data: _____

Depth to basement: _____

ft _____

Infiltration characteristics: _____

Surficial material: _____

gpd/ft _____

Coefficient Storage: _____

Coefficient Trans: _____

gpd/ft²; Spec cap: _____

gpm/ft; Number of geologic cards: _____

Drilled to 1600 ft but blocked at 532.
PEG says 100± of part csg above 1600:

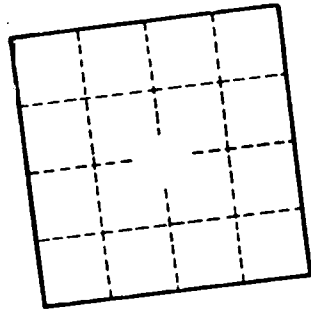
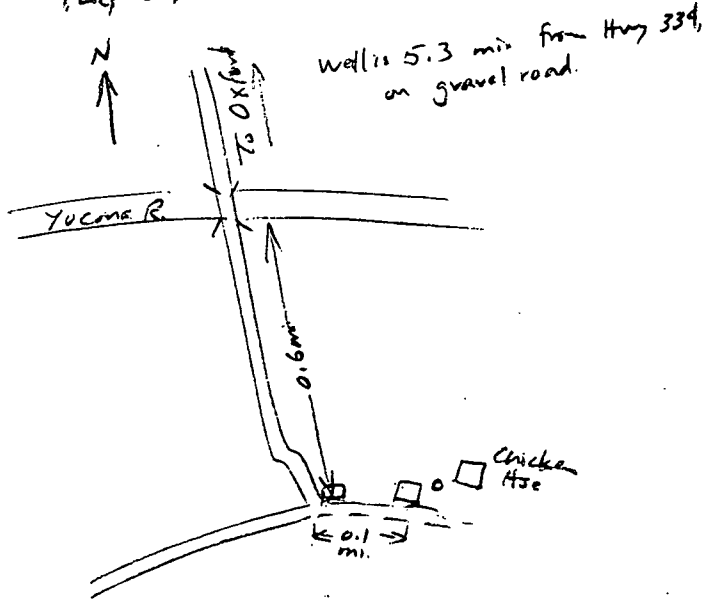

Well No. _____