

OMIT

WRD Exp. (GW)
April 1966

Well No. PA

Location

PA

omit plugged

WELL SCHEDULE

Log #19

U. S. DEPT. OF THE INTERIOR

GEOLOGICAL SURVEY

WATER RESOURCES DIVISION

Porterville 216-A

MASTER CARD

Record by P.E. Grantham Source of data Driv. E Log Date 5-9-68 Map

State Mississippi 501 28 County (or town) Kemper 04 35

Latitude: 32 4 5 3 N Longitude: 088 28 7 4 Sequential number: 1

Lat-long accuracy: 2 T. 10 S, R 18 W, Sec 5 SE 1, NE 1, NE 1

Local well number: P004A A0510 N18E Other number: Rest Area #75

Local use: 056019 Owner or name: Mississippi State Hwy Dept.

Owner or name: MIS S HWY DEPT Address: Electric Mills Miss

Ownership: (C) County, (F) Fed Gov't, (M) City, Corp or Co, (N) Private, (P) State Agency, (S) Water Dist S

Use of water: (A) Air cond, (B) Bottling, (C) Comm, (D) Dewater, (E) Power, (F) Fire, (G) Dom, (H) Irr, (I) Med, (J) Ind, (K) P S, (L) Rec, (M) Stock, (N) Instit, (O) Unused, (P) Repressure, (Q) Recharge, (R) Desal-P S, (S) Desal-other, (T) Other Roadside Park H

Use of well: (A) Anode, (B) Drain, (C) Seismic, (D) Heat Res, (E) Obs, (F) Oil-gas, (G) Recharge, (H) Test, (I) Unused, (J) Withdraw, (K) Waste, (L) Destroyed W

DATA AVAILABLE: Well data N Freq. W/L meas.: N Field aquifer char. N

Hyd. lab. data: N

Qual. water data; type: MSBOW PARTIAL USGS 2/69

Freq. sampling: N Pumpage inventory: N period: N

Aperture cards: N

Log data: E Log 316-1515' D E

WELL-DESCRIPTION CARD

SAME AS ON MASTER CARD Depth well: 1515 ft Meas. rept accuracy 3

Depth cased; (first perf.) 1485 ft Casing type: Steel; Diam. 4 X 2 in 4

Finish: (C) porous concrete, (F) gravel w. (perf.), (G) gravel w. (screen), (H) horiz. gallery, (I) open end, (J) perf., (K) screen, (L) sd. pt., (M) shored, (N) open hole, (O) other S

Method Drilled: (A) air rot, (B) bored, (C) cable, (D) dug, (E) hyd jetted, (F) air rot., (G) percussion, (H) rotary, (I) reverse, (J) trenching, (K) driven, (L) drive wash, (M) other H

Date Drilled: 6-2-68 969 Pump intake setting: 30 ft 38

Driller: Terry Drlg. Co. Meridian, Miss

Lift (type): (A) air, (B) bucket, (C) cent., (D) jet, (E) multiple, (F) multiple, (G) none, (H) piston, (I) rot., (J) submerg, (K) turb, (L) other S Deep D

Power (type): (A) diesel, (B) elec, (C) gas, (D) gasoline, (E) hand, (F) gas, (G) wind, (H) H.P. 1 1/2 T Trans. or meter no. 41

Descrip. MP 215 5/92 above ft below LSD, Alt. MP 47

Alt. LSD: 223 Bar 223 Accuracy: (source) 4

Water Level: 223 ft above MP; 223 ft below LSD Accuracy: 52

Date meas: 20 Yield: 200 gpm Method determined 1

Drawdown: 20 ft Accuracy: 60 Pumping period hrs 66 68

QUALITY OF WATER DATA: Iron 0.14 ppm Sulfate 6 ppm Chloride 510 ppm Hard. 72 Sp. Conduct 2090 K x 10⁶ 6 Temp. 74 76 Date sampled 269 77 79

Taste, color, etc. 2

DS = 1120

Well No.

PA

Well No. P4

Latitude-longitude _____
d m s N S d m s

HYDROGEOLOGIC CARD

SAME AS ON MASTER CARD 19 **Physiographic Province:** 0.3 20 21 **Section:** _____

D 22 **Drainage Basin:** 13.9 23 25 **Subbasin:** _____ 26

Topo of well site: (D) depression, stream channel, dunes, flat, hilltop, sink, swamp, (E) (F) (H) (K) (L) (P) (S) (T) (U) (V) offshore, pediment, hillside, terrace, undulating, valley flat _____ 27

MAJOR AQUIFER: _____ system _____ series K.3 28 29 _____ aquifer, formation, group G.0 30 31

Lithology: _____ U.S 32 33 **Origin:** _____ 2 34 **Aquifer Thickness:** _____ ft

Length of well open to: _____ ft 30 38 40 **Depth to top of:** 1448 ft A.4.5 41 43

MINOR AQUIFER: _____ system _____ series _____ 44 45 _____ aquifer, formation, group _____ 46 47

Lithology: _____ U.S 48 49 **Origin:** _____ _____ 50 **Aquifer Thickness:** _____ ft

Length of well open to: _____ ft _____ 54 56 **Depth to top of:** _____ ft _____ 57 59

Intervals Screened: 1460-1490

Depth to consolidated rock: _____ ft _____ 60 63 **Source of data:** _____ 64

Depth to basement: _____ ft _____ 65 68 **Source of data:** _____ 69

Surficial material: _____ 70-71 70 71 **Infiltration characteristics:** _____ 72

Coefficient Trans: _____ gpd/ft _____ 73 75 **Coefficient Storage:** _____ 76 78

Coefficient Perm: _____ gpd/ft²; Spec cap: _____ gpm/ft; Number of geologic cards: _____ 79

*Entraw type water
not Gardo on
P. logs*

Project N^o LSF-002-3(3)
Leighton Johnson Res. Eng.
Philadelphia P.O. Box 85

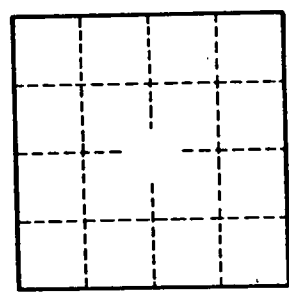
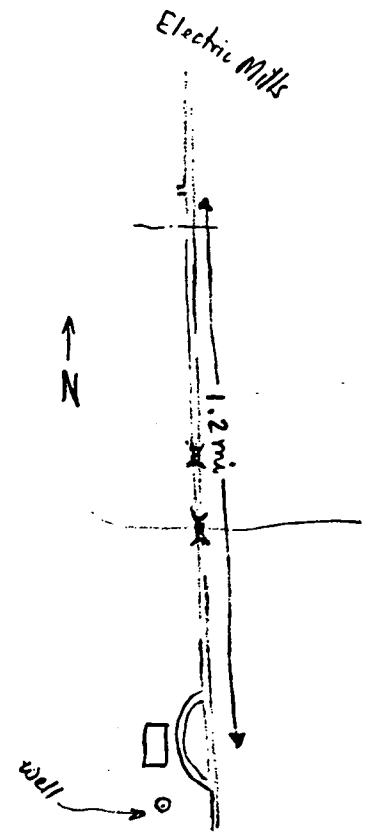

Well No.

P4