

SEE WRD Exp. (GW) April 1966

BILLY RILEY

Well No.

K27a

WELL SCHEDULE

Elog # 21

U. S. DEPT. OF THE INTERIOR

GEOLOGICAL SURVEY

WATER RESOURCES DIVISION

PUNCHED and VERIFIED

ROLLA COMPUTATION BRANCH

MASTER CARD

Record by P.E. Grantham Source of data Drl. Log Elog Date 10-24-68 Map

State Mississippi 28 County Kemper 35

Latitude: 32 46 35 N Longitude: 088 27 55 Sequential number: 1

Lat-long accuracy: 30 T. 11 S. R. 18 W. Sec 28 NW t. NW t. B & M

Local well number: K02768281 N18E Other number:

Local use: 053021 171 29 Owner or name: Kemper Co. Test Well Proj

Owner or name: PORTERVILLE WIA Address: Electric Mills, Miss

Ownership: County, Fed Gov't, City, Corp or Co, Private, State Agency, Water Dist N

Use of Air cond, Bottling, Comm, Dewater, Power, Fire, Dom, Irr, Med, Ind, P S, Rec,

water: (S) (T) (U) (V) (W) (X) (Y) (Z) P

Use of well: (A) (D) (G) (H) (I) (J) (K) (L) (M) (N) (O) (P) (R) (T) (U) (W) (X) (Z) W

DATA AVAILABLE: Well data 70 Freq. W/L meas.: 71 Field aquifer char. 72

Hyd. lab. data: 73

Qual. water data; type: MSBOH 11/68 / USGS 1/71 74

Freq. sampling: 75 Pumpage inventory: yes no period: 76

Aperture cards: 77

Log data: E-LOG Schl. 82-2370 D:E 78 79

WELL-DESCRIPTION CARD Drilled to 2535'

SAME AS ON MASTER CARD Depth well: 2369 ft Meas. 24 3

Depth cased: Split screen ft 2259 Casing type: IRON; Diam. 8 X 6 in 29 30

Finish: (C) porous concrete, (F) gravel w. (perf.), (G) gravel w. (screen), (H) horiz. gallery, (I) open end, (J) open hole, (K) other S

Method: (A) air rot, (B) bored, (C) cable, (D) dug, (E) hyd jetted, (F) air rot., (G) reverse percussion, (H) reverse rotary, (I) driven, (J) drive wash, (K) other H

Date Drilled: 10-68 968 Pump intake setting: 70' ft 36 45

Driller: T.M. Parks Drlg. Co. Houka, Miss name address

Lift (type): (A) air, (B) bucket, (C) cent, (D) jet, (E) multiple, (F) multiple, (G) none, (H) piston, (I) rot, (J) submerg, (K) turb, (L) other S

Power (type): (A) diesel, (B) elec, (C) gas, (D) gasoline, (E) hand, (F) gas, (G) wind; H.P. 10 U Trans. or meter no. 41

Descrip. MP 195 New 1978 ft above below LSD, Alt. MP 47 5

Alt. LSD: 215 Accuracy: (source) 47 5

Water Level: 4 ft above below MP; Ft below LSD +4 Accuracy: 52 A

Date meag: N 68 Yield: 287 gpm Method determined 4

Drawdown: 10 ft Accuracy: 1 Pumping period: 2 hrs 62 64 65 66 68

QUALITY OF WATER DATA: Iron Sulfate Chloride Hard. 69 70 71 72

Sp. Conduct 1075 K x 10 5 Temp. 35 F Date sampled N 68 73 74 75 76 77 79

Taste, color, etc. (too low)

MSBOH Fa = 1.0

pH = 7.5

Water Level Data 11/17/82 WL = 17.13

8/10/97 21.00 3.56 17.44 1.0 DMP 16.44

12-11-87

21.00 2.38 18.62 1.00 17.62

PUMP OFF 45 min

10/21/78 WL = 6.49

PUNCHED and VERIFIED ROLLA COMPUTATION BRANCH

Well No.

K27a

Latitude-longitude

N
S

HYDROGEOLOGIC CARD

1 SAME AS ON MASTER CARD 19 Physiographic Province: 20 21 **03** Section: _____

22 **D** Drainage Basin: 23 24 **136** Subbasin: _____ 26

(D) (C) (E) (F) (H) (K) (L)
 Topo of well site: depression, stream channel, dunes, flat, hilltop, sink, swamp,
 (O) (P) (S) (T) (U) (V)
 offshore, pediment, hillside, terrace, undulating, valley flat _____ 27

MAJOR AQUIFER: _____ system _____ series _____ 28 29 **K3** *Coker - massive sand* aquifer, formation, group _____ 30 31 **MM**

Lithology: _____ 32 33 **S** Origin: _____ 34 **2** Aquifer Thickness: _____ ft

320 Length of well open to: _____ ft _____ 35 36 **84** Depth to top of: **2030 ±** **303** ft _____ 37 38 39

MINOR AQUIFER: _____ system _____ series _____ 44 45 _____ 46 47

Lithology: _____ 48 49 _____ 50 _____ 51 52 _____ 53 54 _____ 55 56 _____ 57 58 59

Intervals Screened: _____

Depth to consolidated rock: _____ ft _____ 60 61 _____ 62 63 Source of data: _____ 64

Depth to basement: _____ ft _____ 65 66 _____ 67 68 Source of data: _____ 69

Surficial material: _____ 70 71 _____ 72 Infiltration characteristics: _____ 73

Coefficient Trans: **700,000** gpd/ft _____ 74 75 **70.4** Coefficient Storage: _____ 76 77 _____ 78

Coefficient Perm: **2,200** gpd/ft²; Spec cap: **29** gpm/ft; Number of geologic cards: _____ 79

Tops samples
 Eutaw 980'
 Tusc. 1385-1400
 Lwr. Crf. 2340

(Well flowing 20 gpm 1/71)

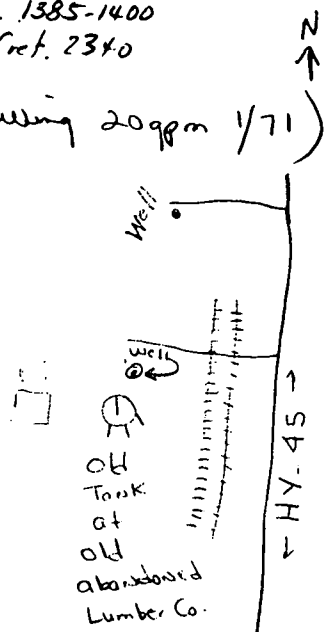

1929' of 8 1/2"
 330' of 6"
 42' 6" screen
 26' 6" blank
 42' 6" screen

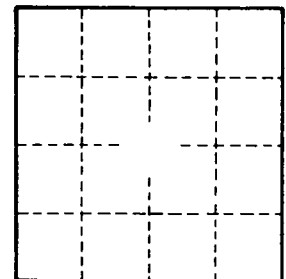

Electric Mills

Well flow at 10 gpm
 10 gpm resulting of
 pipe approx 20 feet
 above sand
 ...
 ...

Well reworked 1980
 216 gpm @ 60'
 WL = 13' 12' dd pump setting 70'

(See Topo Map for well #26 for well location)

ELOG # 21

Kemper
K27
11-21-68

MISSISSIPPI
BOARD OF WATER COMMISSIONERS
416 North State Street
Jackson, Mississippi 39201

WATER WELL DRILLER **CODED**

11-21 19 68 T.M. PARKS Kemper
date well completed firm name county well located

LANDOWNER: <u>Kemper Co. Test</u>	description of formations encountered	from	to
<u>Project - FHA</u>	<u>Electric Mills.</u>		
<u>Dekalb, Miss.</u> (mailing address)			
WELL LOCATION: sec. <u>28</u> T. <u>11</u> N R. <u>18</u> E S W			
<u>28</u> miles <u>N</u> of <u>Meridian</u> (distance) (direction) (nearest town)			
WELL PURPOSE: <u>TEST</u> (home, irrigation, municipal, industrial)			
WELL COMPLETION DATA:			
(1) diameter (inches) <u>7 5/8</u>			
(2) total depth (feet) <u>2535</u>			
(3) static water level (feet) <u>20</u> <u>below</u> <u>above</u> top of ground.			
(4) casing <u>Steel</u> , <u>2250</u> (material) (depth)			
<u>4</u> (size) if telescope see back.			
(5) screen <u>164</u> , <u>1650 to 1720</u> (length) (depth to top)			
<u>4"</u> , <u>Steel</u> (size) (material)			
(6) pump <u>TEST PUMP</u> <u>50</u> (HP) (yield gpm)			
(type power)			
(7) electric log <u>Yes</u> (yes or no)			
<u>Schlumberger</u> (organization running log)			
(8) how well bottom plugged <u>Lead shot</u> <u>cement</u>			
DRILLERS REMARKS: <u>Test</u> <u>Made</u>			

CODED

Lead
11/21/71

If well telescopes please sketch and show depths.

GROUND LEVEL

SECTION _____

Please indicate well location X.

ADDITIONAL INFORMATION

If more than one screen, show locations of each on sketch.

DEPARTMENT OF ENVIRONMENTAL QUALITY - OLWR
PUBLIC SUPPLY WELLS PROJECT

GPS LOG

USER NAME(S): Hornbeak DATE: 1/16/97

UNIT DEQ #: 82859 FILE #: B011700A

HEALTH DEPT. #: 350006-01 ELEV. 190 195

USGS #: K27 OLWR #: GW#12517

OWNER: Pottersville Water Assoc. QUAD: Scooba

LOCATION: SW-NW s 28 T 11N R 18E COUNTY: Kemper

LOCATION DESCRIPTION: At Elev. Tank on Gravel Rd. .15 mi. west of Hwy 45,
3.8 mi. South of Intersection with Hwy 16 at Scooba
(Elec. Mills)

CASING DIA: 10" PUMP TYPE & SIZE: 20 HP Elec.

GPS FIELD LOCATION: LAT. 32°46'23.0" LONG. 88°27'53.8"

GPS CORRECTED LOCATION: LAT. 32.77317058 LONG. 88.46542985

REMARKS: GPS at well.

