

HD # 350006-02

Call Floyd Jenkins  
Parterville W/A

6/78 WTD

Recorded by WTO  
Date 10/1/79

U.S. GEOLOGICAL SURVEY  
WATER RESOURCES DIVISION  
MISSISSIPPI DISTRICT  
WELL RECORD

TRANSMITTED FOR ADP  
*Booche*

Well No. K22  
E-Log No. 39  
County Kemper

GEN. SITE DATA

Site ID 33 06  
3.2.4.9.5.0.0.8.8.2.7.4.8.0.1 R=0\* T=A\* 2=W\* *Scuba Map 196-C*

Data reliab. 3-C Report. agency 4-USGS\* Dist. 6-28\* 7-28\* Co. 8-069\*

Lat. \_\_\_\_\_ Long. 9-3.2.4.9.33 10-0.8.8.2.7.4.8 Well No. 12-K.0.2.2.\*

NE Location 13-N.5.S.5.0.4 11.N.1.8.E.\* Alt. 16-2.0

Hyd. Unit (OWDC) 20- Date 21-0.8.1.2.3.1.1.9.7.9.\*

Well use 23-W\* Water Use 24-P\* Hole depth 27-2.2.7.3.\* Well depth 28-2.2.1.0.\*

WL 30-5.4.\* Date 31-0.3.1.3.0.1.1.9.8.0.\* Source 33-D.\*

Status 273- Project No. 5-

OWNER

R=158\* T=A\* Date 159# 0.3.1.3.0.1.1.9.8.0.\* Owner No. \_\_\_\_\_

Owner 161-P.0.R.T.E.R.V.I.L.L.E.

FIELD OW

R=192\* T=A\* Date 193# Temp. 196#00010\* 197- . . . \*

R=192\* T=A\* Date 193# Cond. 196#00095\* 197- . . . \*

R=192\* T=A\* Date 193# pH 196#00400\* 197- . . . \*

CONSTR.

R=58\* T=A\* 59# 1\* Date 60-0.3.1.3.0.1.1.9.8.0.\* Remarks \_\_\_\_\_

Drlg. 63-0.5.3.\* Name T.M. Parks Method 65-H\* Finish 66-S.\*

CASING

R=76\* T=A\* 59# 1\* 10" steel

Top csng. 77# 0.\* Bot. csng. 78-2.1.0.8.\* Diam. 79# 1.0.\*

R=76\* T=A\* 59# 1\*

Top csng 77# 2.1.0.8.\* Bot. csng. 78-2.1.5.0.\* Diam. 79# 1.6.\*

OPENINGS

R=82\* T=A\* 59# 1\* Top 83# 2.1.5.0.\* Bottom 84-2.2.1.0.\*

Type 85-S\* Diam. 87-1.6.\* Size 88- . . . \*

R=82\* T=A\* 59# 1\* Top 83# Bottom 84-

Type 85- Diam. 87- Size 88-

YIELD

R= 146\* T=A\* 147# 1\* Q 150-2.0.6.\* Q/S 272-

134 flows 146 pumped

LIFT

R=42\* T= A \* Lift type 43# T\* Intake 44# \* Power type 45# E\*

Date 38- 03/30/1980 H.P. 46- 20.0\*

LOGS

R=198\* T= A \* Log 199# D\* Top 200- 0.0\* Bot 201- 227.3\*

R=198\* T= A \* Log 199# E\* Top 200- 24.0\* Bot 201- 2272.0\*

R=189\* T= A \* E Log No. 190# 0.39\* 191- M I S S D I S T \*

ANAL.

R=114\* T= A \* Year 115# \* Type 120# \*

AQUIFERS

R=90\* T= A \* 256# 1\* Top 91- 2100.0\* Bot 92- 2245.0\*

Unit ID 93- 211MSSB\* Name of Unit MASSIVE  
Gordo

R=90\* T= A \* 256# 1\* Top 91- \* Bot 92- \*

Unit ID 93- \* Name of Unit

HYDRAULICS

R=98\* T= A \* 99# 1\* Unit tested 100- \* 103- \*

R=105\* T= A \* 99# 1\* Test No. 106# \*

107- \* Transmissivity (gal/d)/ft

108- \* Hydraul. cond. (gal/d)/ft<sup>2</sup>

110- \* Storage coeff. Boundaries

10/14/92

9 + 13 min - 37.00  
3.38  
33.67  
1.70  
31.97

R=121\* T= \* Yr Begin 122# \* Network 258- \*

Water Level Data Collection (1)

11-29-90  
MP = 1.7  
HOLD - 65  
CUT - 29.8'

35.2  
1.7  
33.5

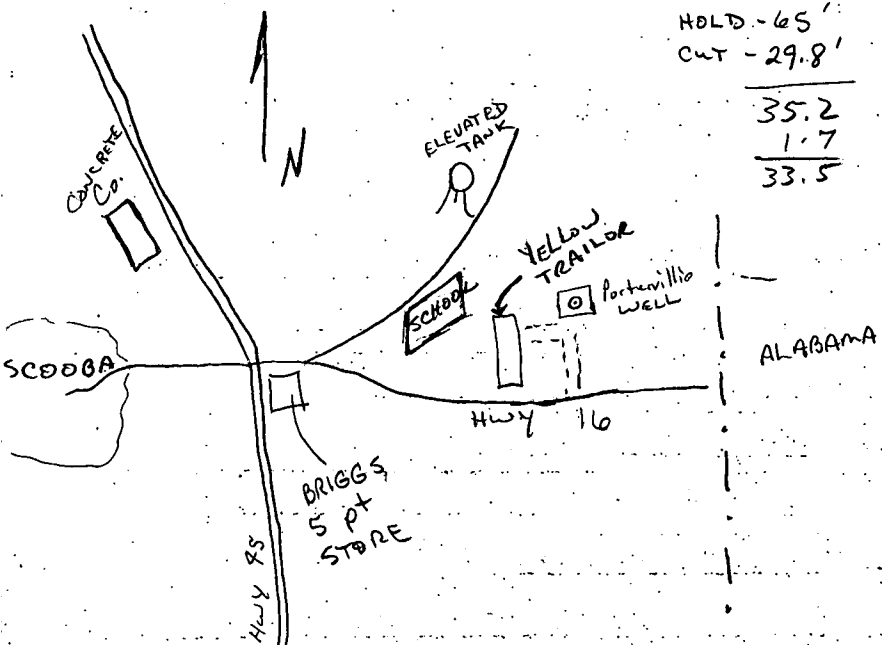

description of formations encountered	from	to
Top soil	1	4.1
firm clays + limestone	4.1	7.80
Sandy Clays	7.80	9.70
firm lime stone w/ clay	9.70	10.30
Sandy gray formation firm	10.30	12.35
suddy fine w/ gray	12.35	12.75
firm clays + limestone	12.75	13.45
soft sands w/ clay + shale	13.45	13.90
firm formation w/ shale	13.90	14.38
Sandy clay + limestone	14.38	15.60
Hard Gumbo w/ shale	15.60	16.38
Sandy clays w/ shale	16.38	17.58
Gumbo pink w/ shale	17.58	19.38
Firm sand w/ shale + pink	19.38	21.08
Sand w/ fine gravel	21.08	21.40
Good Gravel + coarse sand	21.40	22.73

KEMPER  
K 22  
Elev # 39  
03/30/80

MISSISSIPPI  
BOARD OF WATER COMMISSIONERS  
416 North State Street  
Jackson, Mississippi 39201

CODED  
4

WATER WELL DRILLERS LOG

date well completed 1980 March 30 firm name T.M. Parks Drilling Co. county well located Kemper

LANDOWNER:	description of formations encountered	from	to
Porterville	Top soil	0	90
Water Association	Firm clays + limestones	90	880
Kemper Co., Mo. (mailing address)	Sandy clays	880	970
WELL LOCATION:	Hem lime stone w/ clay	970	1030
sec. 4 T. 11 N. R. 18 E	Sandy gray formation firm	1030	1235
30 miles N of Meridian	sandy fine w/ gray	1235	1275
(distance) (direction) (nearest town)	Hem clays + limestones	1275	1345
WELL PURPOSE: Community	soft sands w/ clay + shale	1345	1390
(home, irrigation, municipal, industrial)	Hem formation w/ shale	1390	1438
WELL COMPLETION DATA:	Sandy clay + limestone	1438	1560
(1) diameter (inches) 10	Hard gumbo w/ shale	1560	1638
(2) total depth (feet) 2273	Sandy clays w/ shale	1638	1758
(3) static water level (feet) 24 below top of ground.	Gumbo, pink w/ shale	1758	1938
(4) casing Steel 2108 (material) (depth)	Firm sand w/ shale + pink	1938	2108
10" (size) If telescope see back.	Sand w/ fine gravel	2108	2140
(5) screen 60 2150 (length) (depth to top)	Good Gravel + coarse sand	2140	2273
6" stainless (size) (material)			
(6) pump 20 206 (HP) (yield gpm)			
3 phase (type power)			
(7) electric log Yes (yes or no)			
MGS (organization running log)			
(8) how well bottom plugged			
DRILLERS REMARKS:			

DEPT. OF NATURAL RESOURCES  
BUREAU OF LAND & WATER RESOURCES  
APR 30 1980  
RECEIVED

DEPARTMENT OF ENVIRONMENTAL QUALITY - OLWR  
PUBLIC SUPPLY WELLS PROJECT

GPS LOG

USER NAME(S): Hornbeak DATE: 1/16/97  
UNIT DEQ #: 82859 FILE #: B011623A  
HEALTH DEPT. #: 350006-02 ELEV. 210 201  
USGS #: K22 OLWR #: GW#12518  
OWNER: Pottersville Water Assoc. QUAD: Scooba  
LOCATION: SE-SE s 4 T 11N R 18E COUNTY: Kempet  
LOCATION DESCRIPTION: AT PLANT & TANK ON Gravel Drive .10 mi. North of  
Hwy 16 E .75 mi. SE of Intersection with Hwy 45  
CASING DIA: 10" PUMP TYPE & SIZE: 20 HP Elec. (Scooba)  
GPS FIELD LOCATION: LAT. 32° 49' 38.9" LONG. 88° 27' 01.1"  
GPS CORRECTED LOCATION: LAT. 32.82734647 LONG. 88.45029734  
REMARKS: GPS at Well.  
\_\_\_\_\_  
\_\_\_\_\_  
\_\_\_\_\_

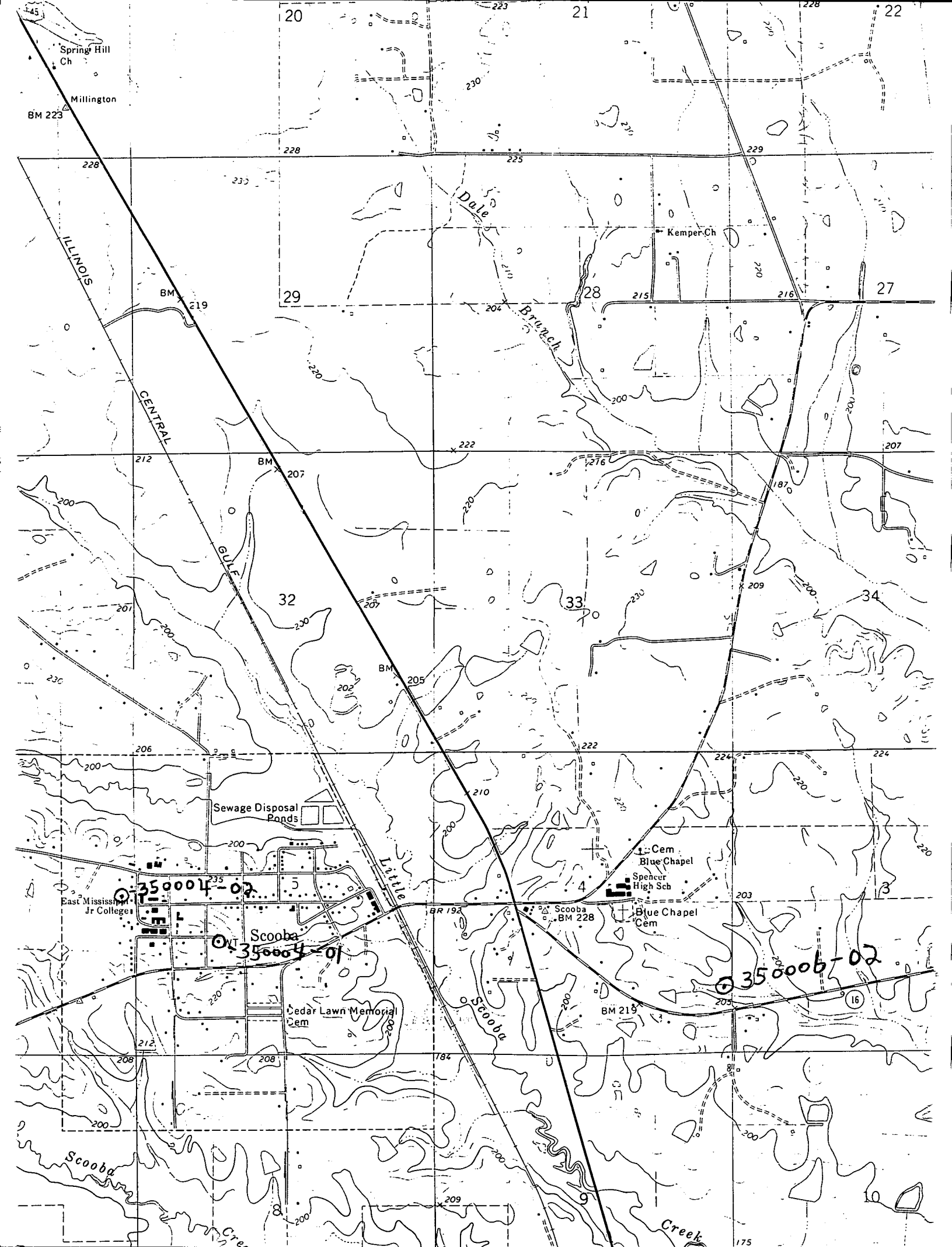

20

21

22

228

225

229

29

28

215

27

CENTRAL

BM 219

BM 207

207

32

33

34

GULF

BM 205

210

222

224

Sewage Disposal Ponds

Cem Blue Chapel

Spencer High Sch

Blue Chapel Cem

350004-02

East Mississippi Jr College

350004-01

Scooba

BR 192

Scooba BM 228

350006-02

BM 219

16

Cedar Lawn Memorial Cem

Scooba

209

Creek

175