

6/77 WTO

H.D.# 35004-01

Go to City Hall  
City Official has key  
John

Recorded by J.A.C

U.S. GEOLOGICAL SURVEY

Well No. K 21

Date 3/22/78

WATER RESOURCES DIVISION

E-Log No. # 24

MISSISSIPPI DISTRICT

WELL RECORD

TRANSMITTED FOR ADP  
8/78

County KEMPER

Site ID

3.249.4.6.0.8.8.2.8.4.8.0.1

R=0\*

T=A\*

2=W\*

Scuba  
196-C

Data reliab.

3=C\*

Report. agency

4=USGS\*

Dist.

6=28\*

7=28\*

Co.

8=0.6.9.\*

Lat.

Long./

9=3.249.4.6.\*

10=0.8.8.2.8.4.8.\*

Well No.

12=KOZ1.\*

Location

13=N.E.S.W.s.0.5.T.11.N.R.1.8.E.\*

Alt.

16=227.\*

Hyd. Unit (OWDC)

20=

Date

21=10.10.1.1.1970.\*

Well use

23=W.\*

Water Use

24=P.\*

Hole depth

27=2429.\*

Well depth

28=2313.\*

WL

30=25.\*

Date

31=12.10.1.1.1970.\*

Source

33=D.\*

Status

273 =

Project No.

5=

WL=35' 10/2/78

R=158\*

T=A\*

Date

159# 10.10.1.1.1970.\*

Owner No.

Owner

161=S.C.Φ.Φ.B.A.\*

R=192\*

T=A\*

Date

193# 1.2.10.1.1.1970.\*

Temp.

196#00010\*

197=36.\*

R=192\*

T=A\*

Date

193# 1.2.10.1.1.1970.\*

Cond.

196#00095\*

197=84.0.\*

R=192\*

T=A\*

Date

193# 1.1.1.\*

pH

196#00400\*

197=

R=58\*

T=A\*

59# 1\*

Date

60=10.10.1.1.1970.\*

Remarks

Drig.

63=00.2.\*

Name

Method

65=H.\*

Finish

66=S.\*

ROBERT RATLIFF

R=76\*

T=A\*

59# 1\*

Top csng.

77# 0.\*

Bot. csng.

78=227.3.\*

Diam.

79# 110.\*

R=76\*

T=A\*

59# 1\*

Top csng

77#

Bot. csng.

78=

Diam.

79#

R=82\*

T=A\*

59# 1\*

Top

83# 227.3.\*

Bottom

84=231.3.\*

Type

85=S.\*

Diam.

87=

Size

88=

R=82\*

T=A\*

59# 1\*

Top

83#

Bottom

84=

Type

85=

Diam.

87=

Size

88=

R=

146.\*

T=A\*

147# 1\*

Q

150=150.\*

Q/S

272=

134 flows 146 pumped

Handwritten note: 4-24-78

S

LIFT

R=42\* T= A \* Lift type 43# ~~43~~\* Intake 44= [ ] \* Power type 45= E\*  
 Date 38= 1.0.1.0.1.1.9.7.0.\* H.P. 46= 15.\*  
 1992

LOGS

R=198\* T= A \* Log 199# E\* Top 200= 3.03.\* Bot 201= 2.4.28.\*  
 R=198\* T= A \* Log 199# \* Top 200= [ ] \* Bot 201= [ ] \*  
 R=189\* T= A \* E Log No. 190# 0.24.\* 191= M I S S D I S T \*

ANAL.

R=114\* T= A \* Year 115# 1.9.7.0.\* Type 120= B\*

AQUIFERS

R=90\* T= A \* 256# 1 \* Top 91= 2.2.0.0.\* Bot 92= [ ] \*  
 Unit ID 93= 2.1.1.M.S.S.V.\* Name of Unit MASSIVE Sand OK ~~Good~~ OK  
 R=90\* T= A \* 256# 1 \* Top 91= [ ] \* Bot 92= [ ] \*  
 Unit ID 93= [ ] \* Name of Unit [ ]

HYDRAULICS

R=98\* T= A \* 99# 1 \* Unit tested 100= [ ] \* 103= [ ] \*  
 R=105\* T= A \* 99# 1 \* Test No. 106# [ ] \*  
 107= [ ] \* Transmissivity (gal/d)/ft [ ]  
 108= [ ] \* Hydraul. cond. (gal/d)/ft<sup>2</sup> [ ]  
 110= [ ] \* Storage coeff. Boundaries [ ]

R=121\* T= \* Yr Begin 122# [ ] \*

Water Level Data Collection (1)

Jr. College 11-29-90

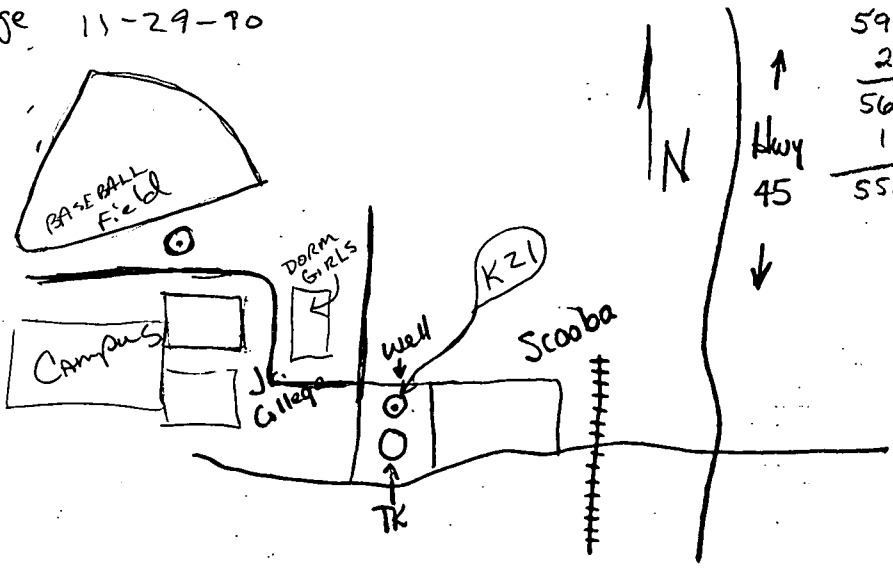

8/11/87  
 59.00  
 2.85  
 56.15  
 1.00  
 55.15

11-29-90  
 MP = .8'  
 70' Hold  
 12.32 cut  
 57.68  
 .8  
 56.88

10/14/92  
 62.00  
 5.42  
 56.58  
 .80  
 55.78

# CODED

# ELOG #24

Kemper  
K21  
10-27-70

MISSISSIPPI  
 BOARD OF WATER COMMISSIONERS  
 416 North State Street  
 Jackson, Mississippi 39201

FEB 25 1972

### WATER WELL DRILLERS LOG

April 29 1970 Robert E. Ratliff Co. Kemper  
 date well completed firm name county well located

LANDOWNER: <u>Town of Scooba</u>	description of formations encountered	from	to
<p><u>Scooba, Miss.</u> (mailing address)</p> <p>WELL LOCATION:  <u>5</u> sec. <u>11</u> T. <u>11</u> N. R. <u>18</u> E.  <u>0</u> miles of <u>Scooba</u>            (distance) (direction) (nearest town)</p> <p>WELL PURPOSE: <u>Municipal</u>            (home, irrigation, municipal, industrial)</p> <p>WELL COMPLETION DATA:            (1) diameter (inches) <u>10" x 7"</u>            (2) total depth (feet) <u>2428'</u>            (3) static water level (feet) <u>23'</u> below above top of ground.            (4) casing <u>KOPPER COATED 300'</u>                  (material) (depth)  <u>10" x 7"</u> if telescope see back.                  (size)            (5) screen <u>60'</u> <u>2250</u>                  (length) (depth to top)  <u>7"</u> <u>S.S.</u>                  (size) (material)            (6) pump <u>15</u> <u>150</u>                  (HP) (yield gpm)  <u>Electric</u>                  (type power)            (7) electric log <u>Yes</u>                  (yes or no)  <u>Miss. Geo. Survey</u>                  (organization running log)            (8) how well bottom plugged <u>B.P.V.</u></p>	<u>White Clay</u>	<u>0</u>	<u>950</u>
	<u>Sandy Shale</u>	<u>950</u>	<u>980</u>
	<u>Blue Clay</u>	<u>980</u>	<u>1250</u>
	<u>Sand</u>	<u>1250</u>	<u>1330</u>
	<u>Rock</u>	<u>1330</u>	<u>1380</u>
	<u>Sandy Shale</u>	<u>1380</u>	<u>1500</u>
	<u>Blue Clay</u>	<u>1500</u>	<u>1650</u>
	<u>Rock</u>	<u>1650</u>	<u>1680</u>
	<u>Clay</u>	<u>1680</u>	<u>1710</u>
	<u>Clay w/ sandy</u>	<u>1710</u>	<u>2150</u>
	<u>Rock</u>	<u>2150</u>	<u>2250</u>
	<u>Sand</u>	<u>2250</u>	<u>2310</u>
	<u>Clay</u>	<u>2310</u>	<u>2380</u>
<u>Clay</u>	<u>2380</u>	<u>2428</u>	
<h1>CODED</h1>			
<p>DRILLERS REMARKS: <u>Extremely Good Well</u></p>			



DEPARTMENT OF ENVIRONMENTAL QUALITY - OLWR  
PUBLIC SUPPLY WELLS PROJECT

GPS LOG

USER NAME(S): Hornback DATE: 1/16/97  
UNIT DEQ #: 82859 FILE #: B011622A  
HEALTH DEPT. #: 350004-01 ELEV. 225  
USGS #: K21 OLWR #: GW-00925  
OWNER: Town of Scooba QUAD: Scooba  
LOCATION: NE-SW s 5 T 11N R 18E COUNTY: Kemper  
LOCATION DESCRIPTION: In Block pumphouse at Elev. Tank at NE Corner  
of Intersection of Hwy 16 + 4th St. (Scooba)  
(East End of Everett St.)  
CASING DIA: 8" PUMP TYPE & SIZE: Submersible  
GPS FIELD LOCATION: LAT. 32° 49' 44.0" LONG. 88° 28' 47.9"  
GPS CORRECTED LOCATION: LAT. 32.82913638 LONG. 88.48003486  
REMARKS: GPS at well.

U.S. DEPT. OF INTERIOR  
 GEOLOGICAL SURVEY  
 WATER RESOURCES DIVISION  
 GROUND WATER SITE INVENTORY  
 WATER-LEVEL DATA

WL 260 = 192

WELL NO. K-21  
 MP HEIGHT 1.0  
 KEMPER CO  
 SCOOBA  
 211 MSSV

ELEV =

Site Ident. No. 327946088284801

R = 234 \*

T = A \*

DATE	WATER LEVEL (BELOW LSD)	STATUS	METHOD	HOLD	CUT	DEPTH BELOW MP	REMARKS	DATE PUNCHED	DATE ENTERED
235 # 10/02/1978*	237 = 35.00*	238 = *	239 = *	40.00	4.00	36.00	@1135 10 MIN AFTER PLU PUMPING		
235 # 08/10/1978*	237 = 55.15*	238 = *	239 = 5*						
235 # / / *	237 = . *	238 = *	239 = *						
235 # / / *	237 = . *	238 = *	239 = *						
235 # / / *	237 = . *	238 = *	239 = *						
235 # / / *	237 = . *	238 = *	239 = *						
235 # / / *	237 = . *	238 = *	239 = *						
235 # / / *	237 = . *	238 = *	239 = *						
235 # / / *	237 = . *	238 = *	239 = *						
235 # / / *	237 = . *	238 = *	239 = *						
235 # / / *	237 = . *	238 = *	239 = *						
235 # / / *	237 = . *	238 = *	239 = *						
235 # / / *	237 = . *	238 = *	239 = *						
235 # / / *	237 = . *	238 = *	239 = *						
235 # / / *	237 = . *	238 = *	239 = *						
235 # / / *	237 = . *	238 = *	239 = *						
235 # / / *	237 = . *	238 = *	239 = *						
235 # / / *	237 = . *	238 = *	239 = *						
235 # / / *	237 = . *	238 = *	239 = *						
235 # / / *	237 = . *	238 = *	239 = *						
235 # / / *	237 = . *	238 = *	239 = *						
235 # / / *	237 = . *	238 = *	239 = *						

Method of Measurement **239 =** A C E G H L M R S T Z  
 airline, calibrated, estimated, pressure, calibrated, geophysical, manometer, reported, steel, electric, other  
 airline gage pressure gage logs tape tape

Site Status **238 =** D G H Ø P R S T Z  
 dry, flowing, nearby, nearby, obstruction, pumping, recently, nearby, nearby, other  
 flowing, recently flowing pumped pumping recently

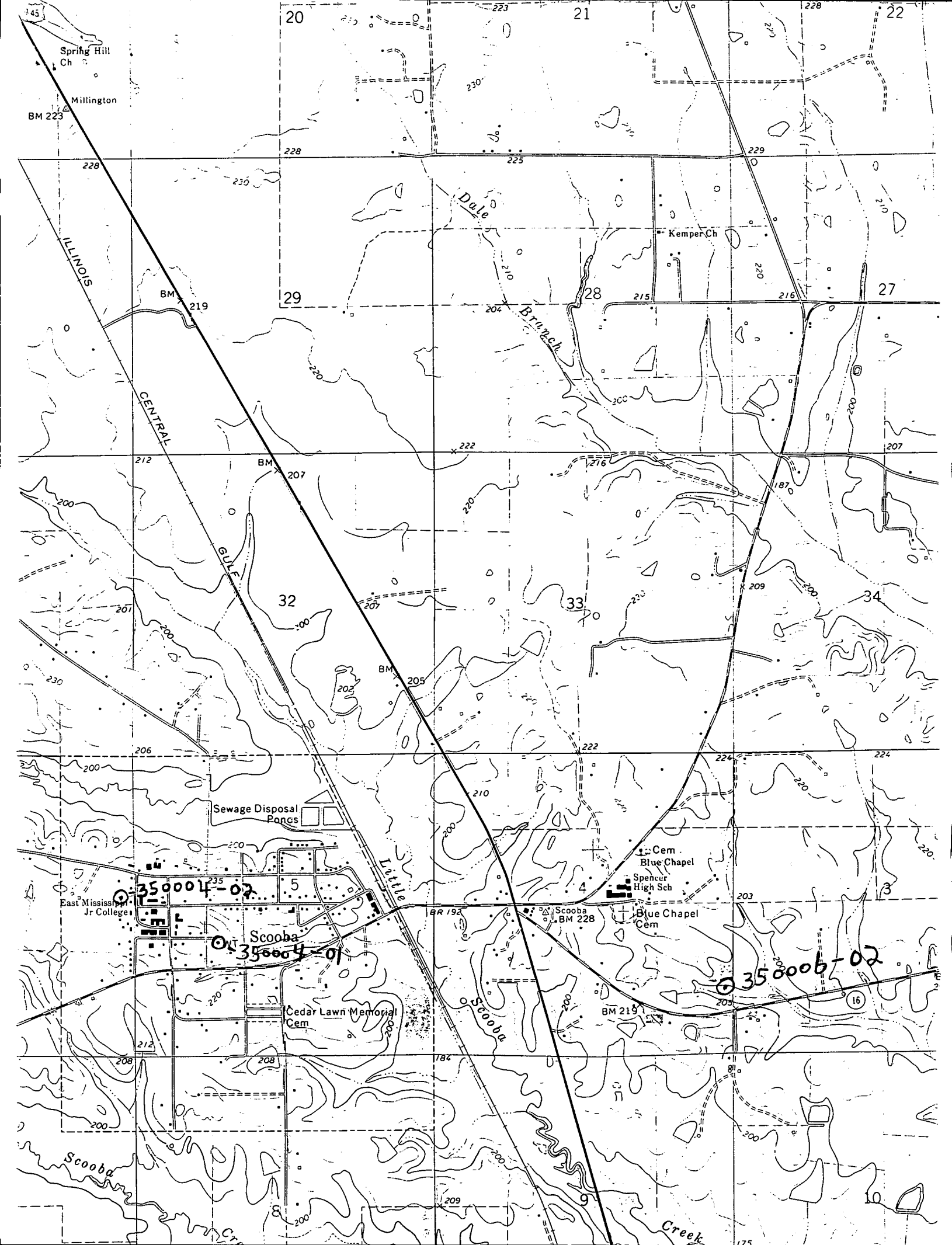

20

21

22

Spring Hill Ch

Millington

BM 223

228

225

229

228

230

230

Dale

Kemper Ch

29

28

27

BM 219

204

215

216

ILLINOIS

CENTRAL

GULF

32

33

34

212

BM 207

200

200

209

200

207

205

205

220

200

206

Sewage Disposal Ponds

210

222

224

224

East Mississippi Jr College

350004-02

Scooba

350004-01

Cedar Lawn Memorial Cem

Cem Blue Chapel

Spencer High Sch

Blue Chapel Cem

Scooba BM 228

BR 192

BM 219

350006-02

Scooba

Creek

175