

WELL SCHEDULE

PUNCHED and VERIFIED  
WATER RESOURCES DIVISION

U. S. DEPT. OF THE INTERIOR GEOLOGICAL SURVEY

MASTER CARD

Record by EHB Source of data Drivs. Records Date 10-22-56 Map \_\_\_\_\_

State Mississippi County 28 (or town) Kemper Sequential number: 35 1

Latitude: 32° 55' 04" N Longitude: 088° 31' 05" S  
 Lat-long accuracy: 3 T. 12 S. R. 17 W. Sec. 1 NW SW  
 Local well number: D009BCO112N17E Other number: B & H

Local use: 108 Owner or name: James Edwards

Owner or name: JAMES EDWARDS Address: \_\_\_\_\_

Ownership: County, Fed Gov't, City, Corp or Co, Private, State Agency, Water Dist P

Use of water: (A) Air cond, Bottling, Comm, Dewater, Power, Fire, Dom, Irr, Med, Ind, P S, Rec, (S) Stock, Instit, Unused, Repressure, Recharge, Desal-P S, Desal-other, Other H

Use of well: (A) Anode, Drain, Seismic, Heat Res, Obs, Oil-gas, Recharge, Test, Unused, Withdraw, Waste, Destroyed. W

DATA AVAILABLE: Well data  Freq. W/L meas.:  Field aquifer char.

Hyd. lab. data: \_\_\_\_\_

Qual. water data; type: \_\_\_\_\_

Freq. sampling:  Pumpage inventory:  yes no; period: \_\_\_\_\_

Aperture cards: \_\_\_\_\_ yes

Log data: \_\_\_\_\_

WELL-DESCRIPTION CARD

SAME AS ON MASTER CARD Depth well: 162 ft Meas. rept accuracy 3

Depth cased; (first perf.) \_\_\_\_\_ ft Casing type: \_\_\_\_\_; Diam. 4 X 2 in

Finish: porous concrete, gravel w. (perf.), gravel w. (screen), horz. gallery, open end, (P) perf., (S) screen, (T) sd. pt., (W) shored, (X) open hole, (Ø) other 31

Method Drilled: (A) air bored, (B) cable, (C) dug, (D) hyd jetted, (H) rot., (J) air rot., (P) percussion, (R) rotary, (T) reverse trenching, (V) driven, (W) drive wash, (Ø) other H

Date Drilled: 1945? 9 4 5 Pump intake setting: \_\_\_\_\_ ft

Driller: Norwood + Eaves Shuqualak

Lift (type): (A) air, (B) bucket, (C) cent, (J) jet, (L) multiple, (M) multiple, (N) none, (P) piston, (R) rot, (S) submerg, (T) turb, other P Deep D Shallow 40

Power (type): (nat) diesel, elec, gas, gasoline, hand, gas, wind; (LP) H.P. 5 Trans. or meter no. \_\_\_\_\_

Descrip. MP \_\_\_\_\_ ft above below LSD, Alt. MP \_\_\_\_\_

Alt. LSD: ± 230 Accuracy: (source) 4

Water Level \_\_\_\_\_ ft above below MP; LSD \_\_\_\_\_ Accuracy: \_\_\_\_\_

Date meas: \_\_\_\_\_ Yield: \_\_\_\_\_ gpm Method determined \_\_\_\_\_

Drawdown: \_\_\_\_\_ ft Accuracy: \_\_\_\_\_ Pumping period \_\_\_\_\_ hrs

QUALITY OF WATER DATA: Iron \_\_\_\_\_ ppm Sulfate \_\_\_\_\_ ppm Chloride \_\_\_\_\_ ppm Hard. \_\_\_\_\_ ppm

Sp. Conduct \_\_\_\_\_ K x 10<sup>6</sup> Temp. \_\_\_\_\_ °F Date sampled \_\_\_\_\_

Taste, color, etc. \_\_\_\_\_

Well No.

D9

Well No. \_\_\_\_\_

D9

Latitude-longitude \_\_\_\_\_  
N  
S  
d m s d m s

**HYDROGEOLOGIC CARD**

**SAME AS ON MASTER CARD** **Physiographic Province:** 03 **Section:** \_\_\_\_\_

**Drainage Basin:** D **Subbasin:** 13G

**Topo of well site:** (D) depression, (C) stream channel, (E) dunes, (F) flat, (H) hilltop, (K) sink, (L) swamp, (Ø) offshore, (P) pediment, (S) hillside, (T) terrace, (U) undulating, (V) valley flat

**MAJOR AQUIFER:** system \_\_\_\_\_ series K3 aquifer, formation, group V

**Lithology:** \_\_\_\_\_ **Origin:** \_\_\_\_\_ **Aquifer Thickness:** \_\_\_\_\_ ft

**Length of well open to:** \_\_\_\_\_ ft **Depth to top of:** \_\_\_\_\_ ft

**MINOR AQUIFER:** system \_\_\_\_\_ series \_\_\_\_\_ aquifer, formation, group \_\_\_\_\_

**Lithology:** \_\_\_\_\_ **Origin:** \_\_\_\_\_ **Aquifer Thickness:** \_\_\_\_\_ ft

**Length of well open to:** \_\_\_\_\_ ft **Depth to top of:** \_\_\_\_\_ ft

**Intervals Screened:** \_\_\_\_\_

**Depth to consolidated rock:** \_\_\_\_\_ ft **Source of data:** \_\_\_\_\_

**Depth to basement:** \_\_\_\_\_ ft **Source of data:** \_\_\_\_\_

**Surficial material:** \_\_\_\_\_ **Infiltration characteristics:** \_\_\_\_\_

**Coefficient Trans:** \_\_\_\_\_ gpd/ft **Coefficient Storage:** \_\_\_\_\_

**Coefficient Perm:** \_\_\_\_\_ gpd/ft<sup>2</sup>; **Spec cap:** \_\_\_\_\_ gpm/ft; **Number of geologic cards:** \_\_\_\_\_

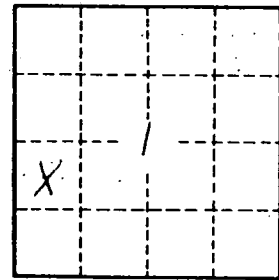
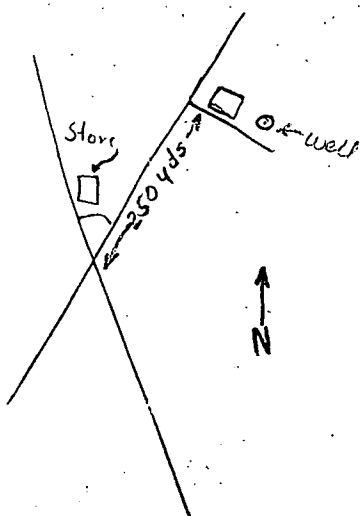

Well No. \_\_\_\_\_

D9