

omit
No Log
Draw

FORM 9-1642
(1-68)

Well No. _____

PLUGGED AND VERIFIED
ROLLA COMPUTATION BRANCH

WELL SCHEDULE

U. S. DEPT. OF THE INTERIOR

GEOLOGICAL SURVEY

WATER RESOURCES DIVISION

MASTER CARD

Record by EHB Source of data E.M. Cade Tenant Date 6-21-55 Map _____

State Mississippi County (or town) Kemper 28 Sequential number: 35

Latitude: 32^{deg} 54^{min} 9^{sec} N Longitude: 0^{12 degrees} 88^{13 min} 31^{18 sec} W Sequential number: 1

Lat-long accuracy: 3 T. 12 S. R. 17 W. Sec. 2 t. NE t. SE

Local well number: 0005AD0212N17E Other number: _____ B & H

Local use: X59 Owner or name: J.C. Thomas

Owner or name: J. C. THOMAS Address: _____

Ownership: County, Fed Gov't, City, Corp or Co, Private, State Agency, Water Dist P

Use of water: (A) Air cond, (B) Bottling, (C) Comm, (D) Dewater, (E) Power, (F) Fire, (G) Dom, (H) Irr, (I) Med, (J) P S, (K) Rec, (L) Stock, (M) Instit, (N) Unused, (O) Reppure, (P) Recharge, (Q) Desal-P S, (R) Desal-other, (S) Other Store & 2 houses H

Use of well: (A) Anode, (B) Drain, (C) Seismic, (D) Heat Res, (E) Obs, (F) Oil-gas, (G) Recharge, (H) Test, (I) Unused, (J) Withdraw, (K) Waste, (L) Destroyed. W

DATA AVAILABLE: Well data Freq. W/L meas.: Field aquifer char.

Hyd. lab. data: _____

Qual. water data: type: _____

Freq. sampling: _____ Pumpage inventory: yes no, period: _____

Aperture cards: _____

Log data: _____

WELL-DESCRIPTION CARD

SAME AS ON MASTER CARD Depth well: _____ ft 1265 Meas. accuracy 6

Depth cased; (first perf.) _____ ft _____ Casing type: steel; Diam. 2 in _____

Finish: porous concrete, gravel w. (perf.), (screen), gravel w. (screen), horiz. gallery, end, other _____

Method Drilled: (A) air rot, (B) bored, (C) cable, (D) dug, (E) hyd rot., (F) jetted, (G) air percuss, (H) rotary, (I) reverse rot., (J) trenching, (K) driven, (L) drive wash, (M) other _____ H

Date Drilled: 1947 947 Pump intake setting: _____ ft _____

Driller: Blount

Lift (type): (A) air, (B) bucket, (C) cent, (D) jet, (E) multiple (cent.), (F) multiple (turb.), (G) none, (H) piston, (I) rot, (J) submerg, (K) turb, (L) other _____ J Deep D Shallow _____

Power (type): diesel elec, gas, gasoline, hand, gas, wind; H.P. 1/2 _____ S Trans. or meter no. _____

Descrip. MP _____ ft above below LSD, Alt. MP _____

Alt. LSD: _____ Accuracy: (source) _____ 4

Water Level: -60 ft above below MP; Ft below LSD _____ Accuracy: _____ 9

Date meas: _____ Yield: _____ gpm _____ Method determined _____

Drawdown: _____ ft _____ Accuracy: _____ Pumping period _____ hrs _____

QUALITY OF WATER DATA: Iron _____ ppm _____ Sulfate _____ ppm _____ Chloride _____ ppm _____ Hard. _____ ppm _____

Sp. Conduct _____ K x 10⁶ _____ Temp. _____ °F _____ Date sampled _____

Taste, color, etc. _____

Well No.

D5

Well No. D5

Latitude-longitude _____
N
S

HYDROGEOLOGIC CARD

SAME AS ON MASTER CARD **Physiographic Province:** 03 **Section:** _____

Drainage Basin: D **Subbasin:** 139

Topo of well site: (D) (C) (E) (F) (R) (K) (L) depression, stream channel, dunes, flat, hilltop, sink, swamp, _____
(S) (P) (S) (T) (U) (V) offshore, pediment, hillside, terrace, undulating, valley flat _____

MAJOR AQUIFER: _____ **system** _____ **series** K3 **aquifer, formation, group** MS

Lithology: _____ **Origin:** _____ **Aquifer Thickness:** 6 ft

Length of well open to: _____ ft **Depth to top of:** _____ ft

MINOR AQUIFER: _____ **system** _____ **series** _____ **aquifer, formation, group** _____

Lithology: _____ **Origin:** _____ **Aquifer Thickness:** _____ ft

Length of well open to: _____ ft **Depth to top of:** _____ ft

Intervals Screened: _____

Depth to consolidated rock: _____ ft **Source of data:** _____

Depth to basement: _____ ft **Source of data:** _____

Surficial material: _____ **Infiltration characteristics:** _____

Coefficient Trans: _____ **gpd/ft** _____ **Coefficient Storage:** _____

Coefficient Perm: _____ **gpd/ft² ; Spec cap:** _____ **gpm/ft ; Number of geologic cards:** _____

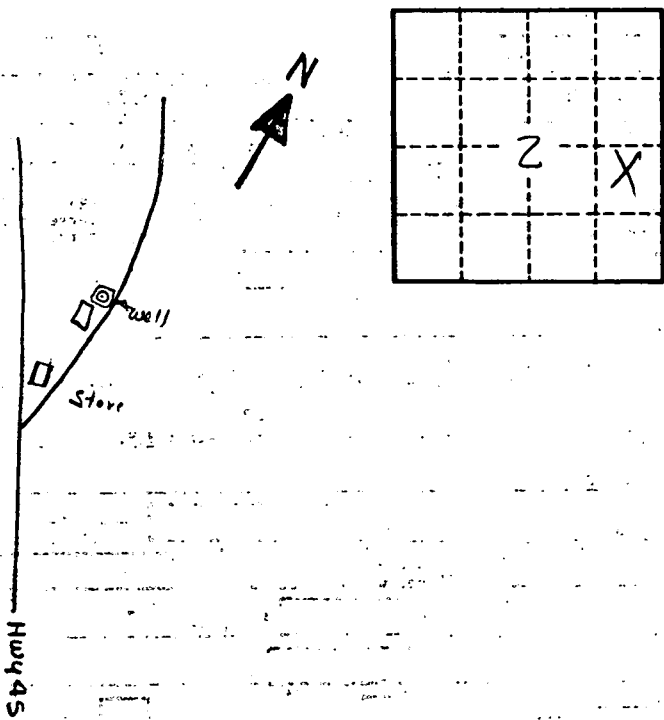

Well No. D5