

WELL SCHEDULE

U. S. DEPT. OF THE INTERIOR

GEOLOGICAL SURVEY

WATER RESOURCES DIVISION

MASTER CARD

Record by Hih Source of data owner Date 10-23-56 **PUNCHED and VERIFIED**
 State Mississippi 28 County (or town) Kemper 35
 Latitude: 32^{deg} 50^{min} 24^{sec} N Longitude: 088^{deg} 41^{min} 90^{sec} 3 Sequential number: 1
 Lat-long accuracy: 2⁰ T. 12^N S. R. 14^E W. Sec. 36 SW 1 SE 1
 Local well number: A003CD3612N14E Other number: B & H
 Local use: 055 Owner or name: R.S. Wilkins
 Owner or name: R S W I L K I N S Address: Preston

Ownership: County, Fed Gov't, City, Corp or Co, Private, State Agency, Water Dist P
 Use of Air cond, Bottling, Comm, Dewater, Power, Fire, Dom, Irr, Med, Ind, P S, Rec, water:
 well: (S) (T) (U) (V) (W) (X) (Y) (Z) H
 Stock, Instit, Unused, Repressure, Recharge, Desal-P S, Desal-other, Other
 Use of (A) (D) (G) (H) (I) (P) (R) (T) (U) (W) (X) (Z) W
 well: Anode, Drain, Seismic, Heat Res, Obs, Oil-gas, Recharge, Test, Unused, Withdraw, Waste, Destroyed.

DATA AVAILABLE: Well data Freq. W/L meas.: Field aquifer char.
 Hyd. lab. data:
 Qual. water data; type:
 Freq. sampling: Pumpage inventory: yes no period:
 Aperture cards: yes
 Log data:

WELL-DESCRIPTION CARD

SAME AS ON MASTER CARD Depth well: 200 ft Meas. rept 6
 Depth cased; (first perf.) 160 ft Casing type: Steel; Diam. 3X2 in 3
 Finish: (C) porous concrete, (F) gravel w. (G) gravel w. (H) horiz. open perf., (I) screen, (J) sd. pt., (K) shored, (L) other, (M) other, (N) other, (O) other, (P) other, (Q) other, (R) other, (S) other, (T) other, (U) other, (V) other, (W) other, (X) other, (Y) other, (Z) other S
 Method (A) air rot, (B) bored, (C) cable, (D) dug, (E) hyd jected, (F) air rot, (G) reverse percussion, (H) air reverse, (I) air reverse, (J) air reverse, (K) air reverse, (L) air reverse, (M) air reverse, (N) air reverse, (O) air reverse, (P) air reverse, (Q) air reverse, (R) air reverse, (S) air reverse, (T) air reverse, (U) air reverse, (V) air reverse, (W) air reverse, (X) air reverse, (Y) air reverse, (Z) air reverse H
 Date Drilled: 956 Pump intake setting: ft

Driller: Terry name Marion address
 Lift (type): (A) air, (B) bucket, (C) cent, (D) jet, (E) multiple, (F) multiple, (G) multiple, (H) multiple, (I) multiple, (J) multiple, (K) multiple, (L) multiple, (M) multiple, (N) multiple, (O) multiple, (P) multiple, (Q) multiple, (R) multiple, (S) multiple, (T) multiple, (U) multiple, (V) multiple, (W) multiple, (X) multiple, (Y) multiple, (Z) multiple J Deep D Shallow
 Power (type): (A) diesel, (B) elec, (C) gas, (D) gasoline, (E) hand, (F) gas, (G) wind, (H) H.P. 1/2 Trans. or meter no. S

Descrip. MP above ft below LSD, Alt. MP
 Alt. LSD: 515 Accuracy: (source) 5
 Water Level -40 ft above below MP; Ft below LSD 40 Accuracy:
 Date meas: 056 Yield: gpm Method determined
 Drawdown: ft Accuracy: Pumping period hrs
 QUALITY OF WATER DATA: Iron ppm Sulfate ppm Chloride ppm Hard. ppm
 Sp. Conduct K x 10 Temp. °F Date sampled
 Taste, color, etc.

Well No.

A3

Well No. 43

Latitude-longitude _____
N
S
d m a s d m s

HYDROGEOLOGIC CARD

SAME AS ON MASTER CARD **Physiographic Province:** 03 **Section:** _____

Drainage Basin: D **Subbasin:** 13T

Topo of well site: (D) depression, (C) stream channel, (E) dunes, (F) flat, (R) hilltop, (K) sink, (L) swamp, (Ø) offshore, (P) pediment, (S) hillside, (T) terrace, (U) undulating, (V) valley flat

MAJOR AQUIFER: system _____ series TE aquifer, formation, group LW

Lithology: _____ **Origin:** S **Aquifer Thickness:** 2 ft

Length of well open to: _____ ft **Depth to top of:** _____ ft

MINOR AQUIFER: system _____ series _____ aquifer, formation, group _____

Lithology: _____ **Origin:** _____ **Aquifer Thickness:** _____ ft

Length of well open to: _____ ft **Depth to top of:** _____ ft

Intervals Screened: _____

Depth to consolidated rock: _____ ft **Source of data:** _____

Depth to basement: _____ ft **Source of data:** _____

Surficial material: _____ **Infiltration characteristics:** _____

Coefficient Trans: _____ gpd/ft **Coefficient Storage:** _____

Coefficient Perm: _____ gpd/ft²; **Spec cap:** _____ gpm/ft; **Number of geologic cards:** _____

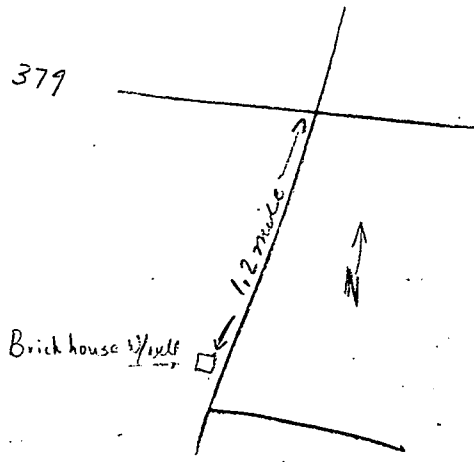
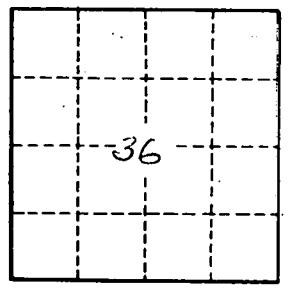

Well No.

43